

**FP1** FASTENING PATTERN 1 SIDE JOINT FASTENING  
REQUIRES TWO SELF-DRILLING OR SELF TAPPING SCREWS

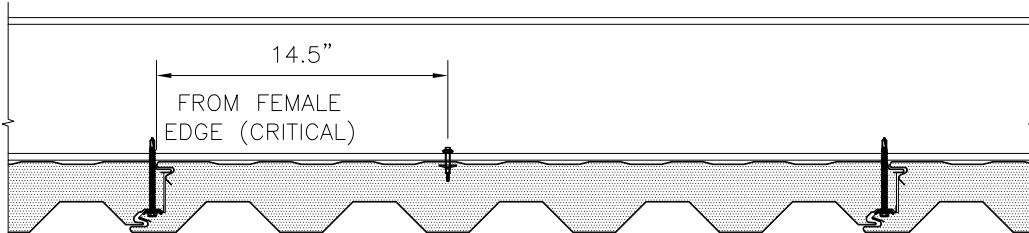

**FP2 (7.2)** FASTENING PATTERN - FP3 (7.2) SIDE JOINT FASTENING  
REQUIRES TWO SELF-DRILLING OR SELF TAPPING SCREWS PLUS ONE BLIND RIVET

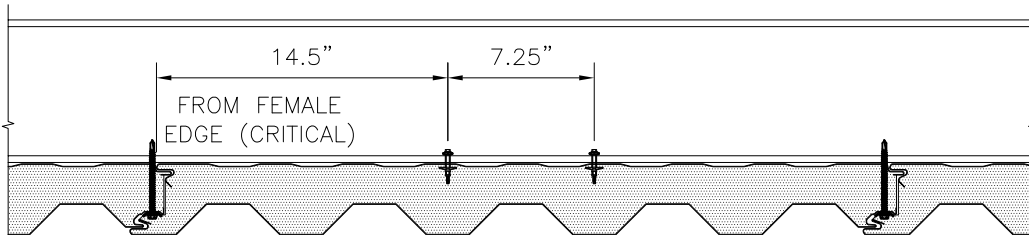

**FP3 (7.2)** FASTENING PATTERN - FP3 (7.2) SIDE JOINT FASTENING  
REQUIRES TWO SELF-DRILLING OR SELF TAPPING SCREWS PLUS TWO BLIND RIVETS

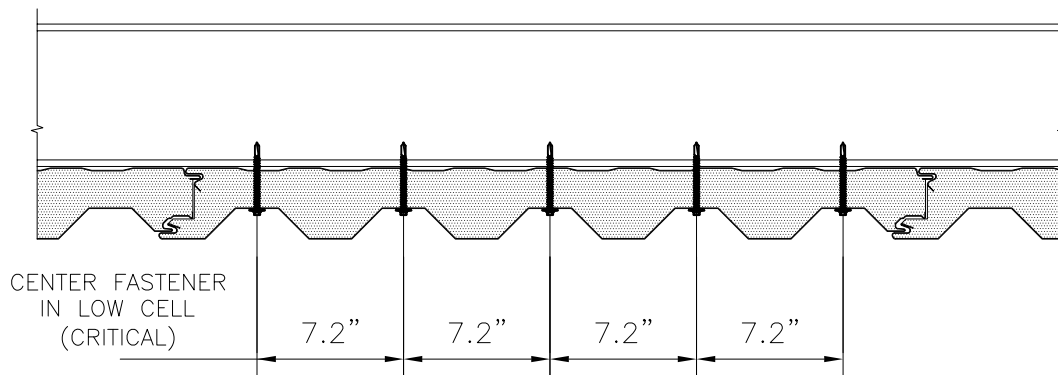

**FP11** FASTENING PATTERN 11 WITH FIVE SELF TAPPING SCREWS CENTER IN LOW CELLS WITH MIN. 20 GA. NEOPRENE BONDED WASHER

(CONSULT METL-SPAN FOR FASTENER REQUIREMENTS NEEDED TO MEET SPECIFIC LOAD REQUIREMENTS)

7.2 INSUL-RIB <sup>TM</sup>  
FASTENING PATTERNS

APPLICATION:  
FASTENING

**FP 1, 2, 3 & 11**

DATE: MAY 15, 2015