

Building Insulations - Walls and Ceilings (FM Approval Class Numbers 4411, 4651, 4880, 4881, 4882)

Insulating materials may occur in building construction to reduce heat or sound transmission through a wall, roof or floor-ceiling assembly. See Roofing Products and Assemblies Category for roof insulations.

The insulation listed below may be a surface treatment exposed to the building occupancy or as core material faced with metal, gypsum wallboard, concrete or masonry.

The listed assemblies are not intended as long-term fire walls or barriers since fire endurance was not evaluated. See SPECIFICATION TESTED PRODUCTS, ASTM E119 Standard, for hourly rated systems.

Exterior Wall Constructions (Class Number 4881)

FM Approved exterior wall systems are Class 1 fire rated in accordance with Approval Standard 4880. Class 1 exterior wall systems may be rated for use to unlimited height, a maximum height of 50 ft (15.2 m) or a maximum height of 30 ft (9.1 m).

FM Approved Class 1 exterior wall assemblies have a wind load rating expressed as a pair of inward and outward acting pressures (Pinward and Poutward or +P/-P) determined using a combination of static and cyclic pressure tests. The rating is the lowest pair of pressures (inward and outward) attained in the static pressure test or the cyclic pressure test. The ratings are in increments of 5 psf (0.24 kPa) based on the inward (positive) pressure. The minimum rating for Approval is 30 psf (1.44 kPa) for the inward (positive) pressure. The magnitude of the pressure on the leeward side of a building is equal or higher than the pressure on the windward side so the outward pressure is based on pressure coefficients of either (-1.4P) or (-2.0P) based on an applied pressure (+P) on the windward side. FM Global Property Loss Prevention Data Sheet 1-28 is used to determine the minimum wind load rating(s) required based on the building's geometry and geographic location.

FM Global recognizes three (3) different wind zones referred to as Zone HM, Zone H and Zone NH. The FM Global Property Loss Prevention Data Sheets are used to determine which zone applies for a particular location. Zone HM is used to denote those exterior wall assemblies that have been qualified for locations that are subject to both hurricane force winds and missile impact from windborne debris. Assemblies may meet the requirements of either the large missile (-LM) or the small missile (-SM) impact test. Assemblies meeting the missile requirements of the Florida Building Code are further designated as (FL) after the -LM or -SM designation. Zone H is used to denote those exterior wall assemblies that have been qualified for locations that are subject to hurricane force winds but not subject to missile impacts from windborne debris. Zone NH is used to denote those exterior wall assemblies in non-hurricane zones that are not subjected to either hurricane force winds or missile impacts from windborne debris.

FM Approved Class 1 exterior wall assemblies have a Hail Resistance Rating determined using tests that simulate the expected impact of hail. The ratings available are Severe and Moderate. The ratings are consistent with corresponding ratings and impact energies used in Approval Standard 4470, Class 1 Roof Covers. FM Global Loss Prevention Data Sheet 1-29 is used to determine the impact (hail) rating needed for a particular geographic location.

The entries in the table should be interpreted as follows:

Thickness indicates the minimum Approved panel thickness (usually wind test related) and the maximum Approved panel thickness (usually fire test related).

Width indicates the minimum Approved panel coverage width (usually fire test related) and the maximum Approved panel width (usually wind test related).

Maximum Height indicates the maximum continuous height of panels that may be installed (fire test related).

Hail Resistance Ratings, Wind Load Ratings and Zones are described above.

Maximum Support Steel Spacing is the maximum spacing between steel supports, Minimum Support Steel Thickness is the minimum steel support thickness and Minimum Support Steel Yield Stress is the minimum steel support strength required to achieve the indicated Wind Load Ratings.

See the listings in the FM Approvals Standard 4880 (2005) Wall-Ceiling/Roof Constructions section earlier in the Exterior Wall Construction Category for a description of each panel listed below.

Products identified with the **GREEN** symbol have attributes that are considered to be "sustainable" by certain outside organizations. FM Approvals verifies the presence of these attributes. Specific attributes for specific products are listed in the individual listings. To facilitate a search for these products in the Approval Guide, first search by the product type you desire and then refine your search to products with the **GREEN** symbol.

CF-Mesa, CF-Light Mesa, CF-Flute, CF-Metl-Plank, CF-Striated, CF-Santa Fe, CF-Architectural Flat, CF ...

Wall Panel	Thickness/ Securement	Width	Max Height	Hail Resistance Rating	Wind Load Rating & Zone	Max Support Steel Spacing	Min Support Steel Thickness	Min Support Steel Yield Stress
CF-Mesa, CF-Light Mesa, CF-Striated, CF-Architectural Flat	4-6 in. (50-150mm)/FP1	24 in. (610 mm)	No Limit	Class S (severe)	Class +105/-147 Zone H	4 ft 0 in. (1220 mm)	14 ga. [0.0710 in. (1.80 mm)]	50 ksi (315 MPa)
CF-Mesa, CF-Light Mesa, CF-Striated, CF-Architectural Flat	2-6 in. (50-150 mm)/FP1	24 in. (610 mm)	No Limit	Class S (severe)	Class +80/-112 Zone H	4 ft 0 in. (1220 mm)	14 ga. [0.0710 in.(1.80 mm)]	50 ksi (315 MPa)

CF-Mesa, CF-Light Mesa, CF-Metl-Plank, CF-Flute, CF-Striated, CF-Santa Fe, CF-Architectural Flat, CF-V-Rib, CF-Tuff-Cast, CF-Tuff-Wall, CF-7.2 Insul-Rib	4-6 in. (100-150 mm)/ FP1	24-42 in. (610-1065 mm)	No Limit	Class S (severe)	Class + 30/-42 Zone H	8 ft 0 in. (2440 mm)	14 ga. [0.0710 in. (1.80 mm)]	50 ksi (315 MPa)
CF-Mesa, CF-Light Mesa, CF-Metl-Plank, CF-Flute, CF-Striated, CF-Santa Fe, CF-Architectural Flat, CF-V-Rib, CF-Tuff-Cast, CF-Tuff-Wall, CF-7.2 Insul-Rib	4-6 in. (100-150 mm)/ FP1	24-42 in. (610-1065 mm)	No Limit	Class S (severe)	Class + 40/-56 Zone H	6 ft 0 in. (1830 mm)	14 ga. [0.0710 in. (1.80 mm)]	50 ksi (315 MPa)
CF-Mesa, CF-Light Mesa, CF-Metl-Plank, CF-Flute, CF-Striated, CF-Santa Fe, CF-Architectural Flat, CF-V-Rib, CF-Tuff-Cast, CF-Tuff-Wall, CF-7.2 Insul-Rib	4-6 in. (100-150 mm)/ FP1	24-42 in. (610-1065 mm)	No Limit	Class S (severe)	Class + 45/-63 Zone H	5 ft 0 in. (1525 mm)	14 ga. [0.0710 in. (1.80 mm)]	50 ksi (315 MPa)
CF-Mesa, CF-Light Mesa, CF-Metl-Plank, CF-Flute, CF-Striated, CF-Santa Fe, CF-Architectural Flat, CF-V-Rib, CF-Tuff-Cast, CF-Tuff-Wall, CF-7.2 Insul-Rib	4-6 in. (100-150 mm)/ FP1	24-42 in. (610-1065 mm)	No Limit	Class S (severe)	Class +60/-84 Zone H	4 ft 0 in. (1220 mm)	14 ga. [0.0710 in. (1.80 mm)]	50 ksi (315 MPa)
CF-Mesa, CF-Light Mesa, CF-Metl-Plank, CF-Flute, CF-Striated, CF-Santa Fe, CF-Architectural Flat, CF-V-Rib, CF-Tuff-Cast, CF-Tuff-Wall, CF-7.2 Insul-Rib	3-6 in. (75-150 mm)/ FP1	24-42 in. (610-1065 mm)	No Limit	Class S (severe)	Class + 35/-49 Zone H	6 ft 0 in. (1830 mm)	14 ga. [0.0710 in. (1.80 mm)]	50 ksi (315 MPa)
CF-Mesa, CF-Light Mesa, CF-Metl-Plank, CF-Flute, CF-Striated, CF-Santa Fe, CF-Architectural Flat, CF-V-Rib, CF-Tuff-Cast, CF-Tuff-Wall, CF-7.2 Insul-Rib	3-6 in. (75-150 mm)/ FP1	24-42 in. (610-1065 mm)	No Limit	Class S (severe)	Class + 40/-56 Zone H	5 ft 0 in. (1525 mm)	14 ga. [0.0710 in. (1.80 mm)]	50 ksi (315 MPa)
CF-Mesa, CF-Light Mesa, CF-Metl-Plank, CF-Flute, CF-Striated, CF-Santa Fe, CF-Architectural Flat, CF-V-Rib, CF-Tuff-Cast, CF-Tuff-Wall, CF-7.2 Insul-Rib	3-6 in. (75-150 mm)/ FP1	24-42 in. (610-1065 mm)	No Limit	Class S (severe)	Class + 50/-70 Zone H	4 ft 0 in. (1220 mm)	14 ga. [0.0710 in. (1.80 mm)]	50 ksi (315 MPa)
CF-Mesa, CF-Light Mesa, CF-Metl-Plank, CF-Flute, CF-Striated, CF-Santa Fe, CF-Architectural Flat, CF-V-Rib, CF-Tuff-Cast, CF-Tuff-Wall, CF-7.2 Insul-Rib	2.5-6 in. (65-150 mm)/ FP1	24-42 in. (610-1065 mm)	No Limit	Class S (severe)	Class + 30/-42 Zone H	6 ft 0 in. (1830 mm)	14 ga. [0.0710 in. (1.80 mm)]	50 ksi (315 MPa)
CF-Mesa, CF-Light Mesa, CF-Metl-Plank, CF-Flute, CF-Striated, CF-Santa Fe, CF-Architectural Flat, CF-V-Rib, CF-Tuff-Cast, CF-Tuff-Wall, CF-7.2 Insul-Rib	2.5-6 in. (65-150 mm)/ FP1	24-42 in. (610-1065 mm)	No Limit	Class S (severe)	Class + 35/-49 Zone H	5 ft 0 in. (1525 mm)	14 ga. [0.0710 in. (1.80 mm)]	50 ksi (315 MPa)

CF-Mesa, CF-Light Mesa, CF-Metl-Plank, CF-Flute, CF-Striated, CF-Santa Fe, CF-Architectural Flat, CF-V-Rib, CF-Tuff-Cast, CF-Tuff-Wall, CF-7.2 Insul-Rib	2.5-6 in. (65-150 mm)/ FP1	24-42 in. (610-1065 mm)	No Limit	Class S (severe)	Class + 45/-63 Zone H	4 ft 0 in. (1220 mm)	14 ga. [0.0710 in. (1.80 mm)]	50 ksi (315 MPa)
CF-Mesa, CF-Light Mesa, CF-Metl-Plank, CF-Flute, CF-Striated, CF-Santa Fe, CF-Architectural Flat, CF-V-Rib, CF-Tuff-Cast, CF-Tuff-Wall	2-6 in. (50-150 mm)/ FP1	24-42 in. (610-1065 mm)	No Limit	Class S (severe)	Class + 30/-42 Zone H	6 ft 0 in. (1830 mm)	14 ga. [0.0710 in. (1.80 mm)]	50 ksi (315 MPa)
CF-Mesa, CF-Light Mesa, CF-Metl-Plank, CF-Flute, CF-Striated, CF-Santa Fe, CF-Architectural Flat, CF-V-Rib, CF-Tuff-Cast, CF-Tuff-Wall	2-6 in. (50-150 mm)/ FP1	24-42 in. (610-1065 mm)	No Limit	Class S (severe)	Class + 35/-49 Zone H	5 ft 0 in. (1525 mm)	14 ga. [0.0710 in. (1.80 mm)]	50 ksi (315 MPa)
CF-Mesa, CF-Light Mesa, CF-Metl-Plank, CF-Flute, CF-Striated, CF-Santa Fe, CF-Architectural Flat, CF-V-Rib, CF-Tuff-Cast, CF-Tuff-Wall	2-6 in. (50-150 mm)/ FP1	24-42 in. (610-1065 mm)	No Limit	Class S (severe)	Class + 45/-63 Zone H	4 ft 0 in. (1220 mm)	14 ga. [0.0710 in. (1.80 mm)]	50 ksi (315 MPa)
CF-Mesa, CF-Light Mesa, CF-Metl-Plank, CF-Flute, CF-Striated, CF-Santa Fe, CF-Architectural Flat, CF-V-Rib, CF-Tuff-Cast, CF-Tuff-Wall	4-6 in. (100-150 mm)/ FP2	24-42 in. (610-1065 mm)	No Limit	Class S (severe)	Class + 30/-42 Zone H	10 ft 8 in. (3250 mm)	14 ga. [0.0710 in. (1.80 mm)]	50 ksi (315 MPa)
CF-Mesa, CF-Light Mesa, CF-Metl-Plank, CF-Flute, CF-Striated, CF-Santa Fe, CF-Architectural Flat, CF-V-Rib, CF-Tuff-Cast, CF-Tuff-Wall	4-6 in. (100-150 mm)/ FP2	24-42 in. (610-1065 mm)	No Limit	Class S (severe)	Class + 35/-49 Zone H	9 ft 0 in. (2745 mm)	14 ga. [0.0710 in. (1.80 mm)]	50 ksi (315 MPa)
CF-Mesa, CF-Light Mesa, CF-Metl-Plank, CF-Flute, CF-Striated, CF-Santa Fe, CF-Architectural Flat, CF-V-Rib, CF-Tuff-Cast, CF-Tuff-Wall	4-6 in. (100-150 mm)/ FP2	24-42 in. (610-1065 mm)	No Limit	Class S (severe)	Class + 40/-56 Zone H	8 ft 0 in. (2440 mm)	14 ga. [0.0710 in. (1.80 mm)]	50 ksi (315 MPa)
CF-Mesa, CF-Light Mesa, CF-Metl-Plank, CF-Flute, CF-Striated, CF-Santa Fe, CF-Architectural Flat, CF-V-Rib, CF-Tuff-Cast, CF-Tuff-Wall	4-6 in. (100-150 mm)/ FP2	24-42 in. (610-1065 mm)	No Limit	Class S (severe)	Class + 45/-63 Zone H	7 ft 0 in. (2135 mm)	14 ga. [0.0710 in. (1.80 mm)]	50 ksi (315 MPa)
CF-Mesa, CF-Light Mesa, CF-Metl-Plank, CF-Flute, CF-Striated, CF-Santa Fe, CF-Architectural Flat, CF-V-Rib, CF-Tuff-Cast, CF-Tuff-Wall	4-6 in. (100-150 mm)/ FP2	24-42 in. (610-1065 mm)	No Limit	Class S (severe)	Class + 50/-70 Zone H	6 ft 0 in. (1830 mm)	14 ga. [0.0710 in. (1.80 mm)]	50 ksi (315 MPa)
CF-Mesa, CF-Light Mesa, CF-Metl-Plank, CF-Flute, CF-Striated, CF-Santa Fe, CF-Architectural Flat, CF-V-Rib, CF-Tuff-Cast, CF-Tuff-Wall	4-6 in. (100-150 mm)/ FP2	24-42 in. (610-1065 mm)	No Limit	Class S (severe)	Class + 60/-84 Zone H	5 ft 0 in. (1525 mm)	14 ga. [0.0710 in. (1.80 mm)]	50 ksi (315 MPa)

CF-Mesa, CF-Light Mesa, CF-Metl-Plank, CF-Flute, CF-Striated, CF-Santa Fe, CF-Architectural Flat, CF-V-Rib, CF-Tuff-Cast, CF-Tuff-Wall	4-6 in. (100-150 mm)/ FP2	24-42 in. (610-1065 mm)	No Limit	Class S (severe)	Class +80/-112 Zone H	4 ft 0 in. (1220 mm)	14 ga. [0.0710 in. (1.80 mm)]	50 ksi (315 MPa)
CF-Mesa, CF-Light Mesa, CF-Metl-Plank, CF-Flute, CF-Striated, CF-Santa Fe, CF-Architectural Flat, CF-V-Rib, CF-Tuff-Cast, CF-Tuff-Wall	3-6 in. (75-150 mm)/ FP2	24-42 in. (610-1065 mm)	No Limit	Class S (severe)	Class +30/-42 Zone H	9 ft 0 in. (2745 mm)	14 ga. [0.0710 in. (1.80 mm)]	50 ksi (315 MPa)
CF-Mesa, CF-Light Mesa, CF-Metl-Plank, CF-Flute, CF-Striated, CF-Santa Fe, CF-Architectural Flat, CF-V-Rib, CF-Tuff-Cast, CF-Tuff-Wall	3-6 in. (75-150 mm)/ FP2	24-42 in. (610-1065 mm)	No Limit	Class S (severe)	Class +35/-49 Zone H	8 ft 0 in. (2440 mm)	14 ga. [0.0710 in. (1.80 mm)]	50 ksi (315 MPa)
CF-Mesa, CF-Light Mesa, CF-Metl-Plank, CF-Flute, CF-Striated, CF-Santa Fe, CF-Architectural Flat, CF-V-Rib, CF-Tuff-Cast, CF-Tuff-Wall	3-6 in. (75-150 mm)/ FP2	24-42 in. (610-1065 mm)	No Limit	Class S (severe)	Class +40/-56 Zone H	7 ft 0 in. (2135 mm)	14 ga. [0.0710 in. (1.80 mm)]	50 ksi (315 MPa)
CF-Mesa, CF-Light Mesa, CF-Metl-Plank, CF-Flute, CF-Striated, CF-Santa Fe, CF-Architectural Flat, CF-V-Rib, CF-Tuff-Cast, CF-Tuff-Wall	3-6 in. (75-150 mm)/ FP2	24-42 in. (610-1065 mm)	No Limit	Class S (severe)	Class +45/-63 Zone H	6 ft 0 in. (1830 mm)	14 ga. [0.0710 in. (1.80 mm)]	50 ksi (315 MPa)
CF-Mesa, CF-Light Mesa, CF-Metl-Plank, CF-Flute, CF-Striated, CF-Santa Fe, CF-Architectural Flat, CF-V-Rib, CF-Tuff-Cast, CF-Tuff-Wall	3-6 in. (75-150 mm)/ FP2	24-42 in. (610-1065 mm)	No Limit	Class S (severe)	Class +50/-70 Zone H	5 ft 0 in. (1525 mm)	14 ga. [0.0710 in. (1.80 mm)]	50 ksi (315 MPa)
CF-Mesa, CF-Light Mesa, CF-Metl-Plank, CF-Flute, CF-Striated, CF-Santa Fe, CF-Architectural Flat, CF-V-Rib, CF-Tuff-Cast, CF-Tuff-Wall	3-6 in. (75-150 mm)/ FP2	24-42 in. (610-1065 mm)	No Limit	Class S (severe)	Class +75/-105 Zone H	4 ft 0 in. (1220 mm)	14 ga. [0.0710 in. (1.80 mm)]	50 ksi (315 MPa)
CF-Mesa, CF-Light Mesa, CF-Metl-Plank, CF-Flute, CF-Striated, CF-Santa Fe, CF-Architectural Flat, CF-V-Rib, CF-Tuff-Cast, CF-Tuff-Wall	2.5-6 in. (65-150 mm)/ FP2	24-42 in. (610-1065 mm)	No Limit	Class S (severe)	Class +30/-42 Zone H	9 ft 0 in. (2745 mm)	14 ga. [0.0710 in. (1.80 mm)]	50 ksi (315 MPa)
CF-Mesa, CF-Light Mesa, CF-Metl-Plank, CF-Flute, CF-Striated, CF-Santa Fe, CF-Architectural Flat, CF-V-Rib, CF-Tuff-Cast, CF-Tuff-Wall	2.5-6 in. (65-150 mm)/ FP2	24-42 in. (610-1065 mm)	No Limit	Class S (severe)	Class +35/-49 Zone H	7 ft 0 in. (2135 mm)	14 ga. [0.0710 in. (1.80 mm)]	50 ksi (315 MPa)
CF-Mesa, CF-Light Mesa, CF-Metl-Plank, CF-Flute, CF-Striated, CF-Santa Fe, CF-Architectural Flat, CF-V-Rib, CF-Tuff-Cast, CF-Tuff-Wall	2.5-6 in. (65-150 mm)/ FP2	24-42 in. (610-1065 mm)	No Limit	Class S (severe)	Class +45/-63 Zone H	6 ft 0 in. (1830 mm)	14 ga. [0.0710 in. (1.80 mm)]	50 ksi (315 MPa)

CF-Mesa, CF-Light Mesa, CF-Metl-Plank, CF-Flute, CF-Striated, CF-Santa Fe, CF-Architectural Flat, CF-V-Rib, CF-Tuff-Cast, CF-Tuff-Wall	2.5-6 in. (65-150 mm)/ FP2	24-42 in. (610-1065 mm)	No Limit	Class S (severe)	Class +55/-77 Zone H	5 ft 0 in. (1525 mm)	14 ga. [0.0710 in. (1.80 mm)]	50 ksi (315 MPa)
CF-Mesa, CF-Light Mesa, CF-Metl-Plank, CF-Flute, CF-Striated, CF-Santa Fe, CF-Architectural Flat, CF-V-Rib, CF-Tuff-Cast, CF-Tuff-Wall	2.5-6 in. (65-150 mm)/ FP2	24-42 in. (610-1065 mm)	No Limit	Class S (severe)	Class +70/-98 Zone H	4 ft 0 in. (1220 mm)	14 ga. [0.0710 in. (1.80 mm)]	50 ksi (315 MPa)
CF-Mesa, CF-Light Mesa, CF-Metl-Plank, CF-Flute, CF-Striated, CF-Santa Fe, CF-Architectural Flat, CF-V-Rib, CF-Tuff-Cast, CF-Tuff-Wall	2-6 in. (50-150 mm)/ FP2	24-42 in. (610-1065 mm)	No Limit	Class S (severe)	Class + 30/-42 Zone H	9 ft 3 in. (1220 mm)	14 ga. [0.0710 in. (1.80 mm)]	50 ksi (315 MPa)
CF-Mesa, CF-Light Mesa, CF-Metl-Plank, CF-Flute, CF-Striated, CF-Santa Fe, CF-Architectural Flat, CF-V-Rib, CF-Tuff-Cast, CF-Tuff-Wall	2-6 in. (50-150 mm)/ FP2	24-42 in. (610-1065 mm)	No Limit	Class S (severe)	Class + 35/-49 Zone H	7 ft 0 in. (2135 mm)	14 ga. [0.0710 in. (1.80 mm)]	50 ksi (315 MPa)
CF-Mesa, CF-Light Mesa, CF-Metl-Plank, CF-Flute, CF-Striated, CF-Santa Fe, CF-Architectural Flat, CF-V-Rib, CF-Tuff-Cast, CF-Tuff-Wall	2-6 in. (50-150 mm)/ FP2	24-42 in. (610-1065 mm)	No Limit	Class S (severe)	Class + 45/-63 Zone H	6 ft 0 in. (1830 mm)	14 ga. [0.0710 in. (1.80 mm)]	50 ksi (315 MPa)
CF-Mesa, CF-Light Mesa, CF-Metl-Plank, CF-Flute, CF-Striated, CF-Santa Fe, CF-Architectural Flat, CF-V-Rib, CF-Tuff-Cast, CF-Tuff-Wall	2-6 in. (50-150 mm)/ FP2	24-42 in. (610-1065 mm)	No Limit	Class S (severe)	Class + 55/-77 Zone H	5 ft 0 in. (1525 mm)	14 ga. [0.0710 in. (1.80 mm)]	50 ksi (315 MPa)
CF-Mesa, CF-Light Mesa, CF-Metl-Plank, CF-Flute, CF-Striated, CF-Santa Fe, CF-Architectural Flat, CF-V-Rib, CF-Tuff-Cast, CF-Tuff-Wall	2-6 in. (50-150 mm)/ FP2	24-42 in. (610-1065 mm)	No Limit	Class S (severe)	Class + 70/-98 Zone H	4 ft 0 in. (1220 mm)	14 ga. [0.0710 in. (1.80 mm)]	50 ksi (315 MPa)
CF-Mesa, CF-Light Mesa, CF-Metl-Plank, CF-Flute, CF-Striated, CF-Santa Fe, CF-Architectural Flat, CF-V-Rib, CF-Tuff-Cast, CF-Tuff-Wall	4-6 in. (100-150 mm)/ FP4	24-42 in. (610-1065 mm)	No Limit	Class S (severe)	Class + 30/-42 Zone HM-LM (FL)	14 ft 6 in. (4420 mm)	14 ga. [0.0710 in. (1.80 mm)]	50 ksi (315 MPa)
CF-Mesa, CF-Light Mesa, CF-Metl-Plank, CF-Flute, CF-Striated, CF-Santa Fe, CF-Architectural Flat, CF-V-Rib, CF-Tuff-Cast, CF-Tuff-Wall	4-6 in. (100-150 mm)/ FP4	24-42 in. (610-1065 mm)	No Limit	Class S (severe)	Class + 35/-49 Zone H	12 ft 0 in. (3660 mm)	14 ga. [0.0710 in. (1.80 mm)]	50 ksi (315 MPa)
CF-Mesa, CF-Light Mesa, CF-Metl-Plank, CF-Flute, CF-Striated, CF-Santa Fe, CF-Architectural Flat, CF-V-Rib, CF-Tuff-Cast, CF-Tuff-Wall	4-6 in. (100-150 mm)/ FP4	24-42 in. (610-1065 mm)	No Limit	Class S (severe)	Class + 40/-56 Zone H	10 ft 0 in. (3050 mm)	14 ga. [0.0710 in. (1.80 mm)]	50 ksi (315 MPa)

CF-Mesa, CF-Light Mesa, CF-Metl-Plank, CF-Flute, CF-Striated, CF-Santa Fe, CF-Architectural Flat, CF-V-Rib, CF-Tuff-Cast, CF-Tuff-Wall	4-6 in. (100-150 mm)/ FP4	24-42 in. (610-1065 mm)	No Limit	Class S (severe)	Class + 45/-63 Zone H	9 ft 0 in. (2745 mm)	14 ga. [0.0710 in. (1.80 mm)]	50 ksi (315 MPa)
CF-Mesa, CF-Light Mesa, CF-Metl-Plank, CF-Flute, CF-Striated, CF-Santa Fe, CF-Architectural Flat, CF-V-Rib, CF-Tuff-Cast, CF-Tuff-Wall	4-6 in. (100-150 mm)/ FP4	24-42 in. (610-1065 mm)	No Limit	Class S (severe)	Class + 55/-77 Zone H	8 ft 0 in. (2440 mm)	14 ga. [0.0710 in. (1.80 mm)]	50 ksi (315 MPa)
CF-Mesa, CF-Light Mesa, CF-Metl-Plank, CF-Flute, CF-Striated, CF-Santa Fe, CF-Architectural Flat, CF-V-Rib, CF-Tuff-Cast, CF-Tuff-Wall	4-6 in. (100-150 mm)/ FP4	24-42 in. (610-1065 mm)	No Limit	Class S (severe)	Class + 60/-84 Zone H	7 ft 0 in. (2135 mm)	14 ga. [0.0710 in. (1.80 mm)]	50 ksi (315 MPa)
CF-Mesa, CF-Light Mesa, CF-Metl-Plank, CF-Flute, CF-Striated, CF-Santa Fe, CF-Architectural Flat, CF-V-Rib, CF-Tuff-Cast, CF-Tuff-Wall	4-6 in. (100-150 mm)/ FP4	24-42 in. (610-1065 mm)	No Limit	Class S (severe)	Class + 75/-105 Zone H	6 ft 0 in. (1830 mm)	14 ga. [0.0710 in. (1.80 mm)]	50 ksi (315 MPa)
CF-Mesa, CF-Light Mesa, CF-Metl-Plank, CF-Flute, CF-Striated, CF-Santa Fe, CF-Architectural Flat, CF-V-Rib, CF-Tuff-Cast, CF-Tuff-Wall	4-6 in. (100-150 mm)/ FP4	24-42 in. (610-1065 mm)	No Limit	Class S (severe)	Class + 80/-112 Zone H	5 ft 0 in. (1525 mm)	14 ga. [0.0710 in. (1.80 mm)]	50 ksi (315 MPa)
CF-Mesa, CF-Light Mesa, CF-Metl-Plank, CF-Flute, CF-Striated, CF-Santa Fe, CF-Architectural Flat, CF-V-Rib, CF-Tuff-Cast, CF-Tuff-Wall	4-6 in. (100-150 mm)/ FP4	24-42 in. (610-1065 mm)	No Limit	Class S (severe)	Class + 105/-147 Zone H	4 ft 0 in. (1220 mm)	14 ga. [0.0710 in. (1.80 mm)]	50 ksi (315 MPa)
CF-Mesa, CF-Light Mesa, CF-Metl-Plank, CF-Flute, CF-Striated, CF-Santa Fe, CF-Architectural Flat, CF-V-Rib, CF-Tuff-Cast, CF-Tuff-Wall	4-6 in. (100-150 mm)/ FP4	24-42 in. (610-1065 mm)	No Limit	Class S (severe)	Class +130/-182 Zone H	3 ft 0 in. (915 mm)	14 ga. [0.0710 in. (1.80 mm)]	50 ksi (315 MPa)
CF-Mesa, CF-Light Mesa, CF-Metl-Plank, CF-Flute, CF-Striated, CF-Santa Fe, CF-Architectural Flat, CF-V-Rib, CF-Tuff-Cast, CF-Tuff-Wall	4-6 in. (100-150 mm)/ FP4	24-42 in. (610-1065 mm)	No Limit	Class S (severe)	Class +125/-175 Zone HM-LM(FL)	3 ft 0 in. (915 mm)	14 ga. [0.0710 in. (1.80 mm)]	50 ksi (315 MPa)
CF-Mesa, CF-Light Mesa, CF-Metl-Plank, CF-Flute, CF-Striated, CF-Santa Fe, CF-Architectural Flat, CF-V-Rib, CF-Tuff-Cast, CF-Tuff-Wall	3-6 in. (750-150 mm)/ FP4	24-42 in. (610-1065 mm)	No Limit	Class S (severe)	Class +30/-42 Zone H	12 ft 0 in. (3660 mm)	14 ga. [0.0710 in. (1.80 mm)]	50 ksi (315 MPa)
CF-Mesa, CF-Light Mesa, CF-Metl-Plank, CF-Flute, CF-Striated, CF-Santa Fe, CF-Architectural Flat, CF-V-Rib, CF-Tuff-Cast, CF-Tuff-Wall	3-6 in. (750-150 mm)/ FP4	24-42 in. (610-1065 mm)	No Limit	Class S (severe)	Class +35/-49 Zone H	10 ft 0 in. (3050 mm)	14 ga. [0.0710 in. (1.80 mm)]	50 ksi (315 MPa)

CF-Mesa, CF-Light Mesa, CF-Metl-Plank, CF-Flute, CF-Striated, CF-Santa Fe, CF-Architectural Flat, CF-V-Rib, CF-Tuff-Cast, CF-Tuff-Wall	3-6 in. (750-150 mm)/ FP4	24-42 in. (610-1065 mm)	No Limit	Class S (severe)	Class +40/-56 Zone H	9 ft 0 in. (2745 mm)	14 ga. [0.0710 in.(1.80 mm)]	50 ksi (315 MPa)
CF-Mesa, CF-Light Mesa, CF-Metl-Plank, CF-Flute, CF-Striated, CF-Santa Fe, CF-Architectural Flat, CF-V-Rib, CF-Tuff-Cast, CF-Tuff-Wall	3-6 in. (750-150 mm)/ FP4	24-42 in. (610-1065 mm)	No Limit	Class S (severe)	Class +50/-70 Zone H	8 ft 0 in. (2440 mm)	14 ga. [0.0710 in.(1.80 mm)]	50 ksi (315 MPa)
CF-Mesa, CF-Light Mesa, CF-Metl-Plank, CF-Flute, CF-Striated, CF-Santa Fe, CF-Architectural Flat, CF-V-Rib, CF-Tuff-Cast, CF-Tuff-Wall	3-6 in. (750-150 mm)/ FP4	24-42 in. (610-1065 mm)	No Limit	Class S (severe)	Class +55/-77 Zone H	7 ft 0 in. (2135 mm)	14 ga. [0.0710 in.(1.80 mm)]	50 ksi (315 MPa)
CF-Mesa, CF-Light Mesa, CF-Metl-Plank, CF-Flute, CF-Striated, CF-Santa Fe, CF-Architectural Flat, CF-V-Rib, CF-Tuff-Cast, CF-Tuff-Wall	3-6 in. (750-150 mm)/ FP4	24-42 in. (610-1065 mm)	No Limit	Class S (severe)	Class +65/-91 Zone H	6 ft 0 in. (1830 mm)	14 ga. [0.0710 in.(1.80 mm)]	50 ksi (315 MPa)
CF-Mesa, CF-Light Mesa, CF-Metl-Plank, CF-Flute, CF-Striated, CF-Santa Fe, CF-Architectural Flat, CF-V-Rib, CF-Tuff-Cast, CF-Tuff-Wall	3-6 in. (750-150 mm)/ FP4	24-42 in. (610-1065 mm)	No Limit	Class S (severe)	Class +75/-105 Zone H	5 ft 0 in. (1525 mm)	14 ga. [0.0710 in.(1.80 mm)]	50 ksi (315 MPa)
CF-Mesa, CF-Light Mesa, CF-Metl-Plank, CF-Flute, CF-Striated, CF-Santa Fe, CF-Architectural Flat, CF-V-Rib, CF-Tuff-Cast, CF-Tuff-Wall	3-6 in. (750-150 mm)/ FP4	24-42 in. (610-1065 mm)	No Limit	Class S (severe)	Class +95/-133 Zone H	4 ft 0 in. (1220 mm)	14 ga. [0.0710 in.(1.80 mm)]	50 ksi (315 MPa)
CF-Mesa, CF-Light Mesa, CF-Metl-Plank, CF-Flute, CF-Striated, CF-Santa Fe, CF-Architectural Flat, CF-V-Rib, CF-Tuff-Cast, CF-Tuff-Wall	3-6 in. (750-150 mm)/ FP4	24-42 in. (610-1065 mm)	No Limit	Class S (severe)	Class +120/-168 Zone H	3 ft 0 in. (915 mm)	14 ga. [0.0710 in.(1.80 mm)]	50 ksi (315 MPa)
CF-Mesa, CF-Light Mesa, CF-Metl-Plank, CF-Flute, CF-Striated, CF-Santa Fe, CF-Architectural Flat, CF-V-Rib, CF-Tuff-Cast, CF-Tuff-Wall	2.5-6 in. (65-150 mm)/ FP4	24-42 in. (610-1065 mm)	No Limit	Class S (severe)	Class +30/-42 Zone H	12 ft 0 in. (3660 mm)	14 ga. [0.0710 in.(1.80 mm)]	50 ksi (315 MPa)
CF-Mesa, CF-Light Mesa, CF-Metl-Plank, CF-Flute, CF-Striated, CF-Santa Fe, CF-Architectural Flat, CF-V-Rib, CF-Tuff-Cast, CF-Tuff-Wall	2.5-6 in. (65-150 mm)/ FP4	24-42 in. (610-1065 mm)	No Limit	Class S (severe)	Class +35/-49 Zone H	10 ft 0 in. (3050 mm)	14 ga. [0.0710 in.(1.80 mm)]	50 ksi (315 MPa)
CF-Mesa, CF-Light Mesa, CF-Metl-Plank, CF-Flute, CF-Striated, CF-Santa Fe, CF-Architectural Flat, CF-V-Rib, CF-Tuff-Cast, CF-Tuff-Wall	2.5-6 in. (65-150 mm)/ FP4	24-42 in. (610-1065 mm)	No Limit	Class S (severe)	Class +40/-56 Zone H	9 ft 0 in. (2745 mm)	14 ga. [0.0710 in.(1.80 mm)]	50 ksi (315 MPa)

CF-Mesa, CF-Light Mesa, CF-Metl-Plank, CF-Flute, CF-Striated, CF-Santa Fe, CF-Architectural Flat, CF-V-Rib, CF-Tuff-Cast, CF-Tuff-Wall	2.5-6 in. (65-150 mm)/ FP4	24-42 in. (610-1065 mm)	No Limit	Class S (severe)	Class +45/-63 Zone H	8 ft 0 in. (2440 mm)	14 ga. [0.0710 in.(1.80 mm)]	50 ksi (315 MPa)
CF-Mesa, CF-Light Mesa, CF-Metl-Plank, CF-Flute, CF-Striated, CF-Santa Fe, CF-Architectural Flat, CF-V-Rib, CF-Tuff-Cast, CF-Tuff-Wall	2.5-6 in. (65-150 mm)/ FP4	24-42 in. (610-1065 mm)	No Limit	Class S (severe)	Class +50/-70 Zone H	7 ft 0 in. (2135 mm)	14 ga. [0.0710 in.(1.80 mm)]	50 ksi (315 MPa)
CF-Mesa, CF-Light Mesa, CF-Metl-Plank, CF-Flute, CF-Striated, CF-Santa Fe, CF-Architectural Flat, CF-V-Rib, CF-Tuff-Cast, CF-Tuff-Wall	2.5-6 in. (65-150 mm)/ FP4	24-42 in. (610-1065 mm)	No Limit	Class S (severe)	Class +60/-84 Zone H	6 ft 0 in. (1830 mm)	14 ga. [0.0710 in.(1.80 mm)]	50 ksi (315 MPa)
CF-Mesa, CF-Light Mesa, CF-Metl-Plank, CF-Flute, CF-Striated, CF-Santa Fe, CF-Architectural Flat, CF-V-Rib, CF-Tuff-Cast, CF-Tuff-Wall	2.5-6 in. (65-150 mm)/ FP4	24-42 in. (610-1065 mm)	No Limit	Class S (severe)	Class +70/-98 Zone H	5 ft 0 in. (1525 mm)	14 ga. [0.0710 in.(1.80 mm)]	50 ksi (315 MPa)
CF-Mesa, CF-Light Mesa, CF-Metl-Plank, CF-Flute, CF-Striated, CF-Santa Fe, CF-Architectural Flat, CF-V-Rib, CF-Tuff-Cast, CF-Tuff-Wall	2.5-6 in. (65-150 mm)/ FP4	24-42 in. (610-1065 mm)	No Limit	Class S (severe)	Class +90/-126 Zone H	4 ft 0 in. (1220 mm)	14 ga. [0.0710 in.(1.80 mm)]	50 ksi (315 MPa)
CF-Mesa, CF-Light Mesa, CF-Metl-Plank, CF-Flute, CF-Striated, CF-Santa Fe, CF-Architectural Flat, CF-V-Rib, CF-Tuff-Cast, CF-Tuff-Wall	2.5-6 in. (65-150 mm)/ FP4	24-42 in. (610-1065 mm)	No Limit	Class S (severe)	Class +115/-161 Zone H	3 ft 0 in. (915 mm)	14 ga. [0.0710 in.(1.80 mm)]	50 ksi (315 MPa)
CF-Mesa, CF-Light Mesa, CF-Metl-Plank, CF-Flute, CF-Striated, CF-Santa Fe, CF-Architectural Flat, CF-V-Rib, CF-Tuff-Cast, CF-Tuff-Wall	2-6 in. (50-150 mm)/ FP4	24-42 in. (610-1065 mm)	No Limit	Class S (severe)	Class +30/-42 Zone HM-LM (FL)	12 ft 0 in. (3660 mm)	14 ga. [0.0710 in.(1.80 mm)]	50 ksi (315 MPa)
CF-Mesa, CF-Light Mesa, CF-Metl-Plank, CF-Flute, CF-Striated, CF-Santa Fe, CF-Architectural Flat, CF-V-Rib, CF-Tuff-Cast, CF-Tuff-Wall	2-6 in. (50-150 mm)/ FP4	24-42 in. (610-1065 mm)	No Limit	Class S (severe)	Class +35/-49 Zone H	10 ft 0 in. (3050 mm)	14 ga. [0.0710 in.(1.80 mm)]	50 ksi (315 MPa)
CF-Mesa, CF-Light Mesa, CF-Metl-Plank, CF-Flute, CF-Striated, CF-Santa Fe, CF-Architectural Flat, CF-V-Rib, CF-Tuff-Cast, CF-Tuff-Wall	2-6 in. (50-150 mm)/ FP4	24-42 in. (610-1065 mm)	No Limit	Class S (severe)	Class +40/-56 Zone H	9 ft 0 in. (2745 mm)	14 ga. [0.0710 in.(1.80 mm)]	50 ksi (315 MPa)
CF-Mesa, CF-Light Mesa, CF-Metl-Plank, CF-Flute, CF-Striated, CF-Santa Fe, CF-Architectural Flat, CF-V-Rib, CF-Tuff-Cast, CF-Tuff-Wall	2-6 in. (50-150 mm)/ FP4	24-42 in. (610-1065 mm)	No Limit	Class S (severe)	Class +45/-63 Zone H	8 ft 0 in. (2440 mm)	14 ga. [0.0710 in.(1.80 mm)]	50 ksi (315 MPa)

CF-Mesa, CF-Light Mesa, CF-Metl-Plank, CF-Flute, CF-Striated, CF-Santa Fe, CF-Architectural Flat, CF-V-Rib, CF-Tuff-Cast, CF-Tuff-Wall	2-6 in. (50-150 mm)/ FP4	24-42 in. (610-1065 mm)	No Limit	Class S (severe)	Class + 50/-70 Zone H	7 ft 0 in. (2135 mm)	14 ga. [0.0710 in. (1.80 mm)]	50 ksi (315 MPa)
CF-Mesa, CF-Light Mesa, CF-Metl-Plank, CF-Flute, CF-Striated, CF-Santa Fe, CF-Architectural Flat, CF-V-Rib, CF-Tuff-Cast, CF-Tuff-Wall	2-6 in. (50-150 mm)/ FP4	24-42 in. (610-1065 mm)	No Limit	Class S (severe)	Class + 60/-84 Zone H	6 ft 0 in. (1830 mm)	14 ga. [0.0710 in. (1.80 mm)]	50 ksi (315 MPa)
CF-Mesa, CF-Light Mesa, CF-Metl-Plank, CF-Flute, CF-Striated, CF-Santa Fe, CF-Architectural Flat, CF-V-Rib, CF-Tuff-Cast, CF-Tuff-Wall	2-6 in. (50-150 mm)/ FP4	24-42 in. (610-1065 mm)	No Limit	Class S (severe)	Class + 70/-98 Zone H	5 ft 0 in. (1525 mm)	14 ga. [0.0710 in. (1.80 mm)]	50 ksi (315 MPa)
CF-Mesa, CF-Light Mesa, CF-Metl-Plank, CF-Flute, CF-Striated, CF-Santa Fe, CF-Architectural Flat, CF-V-Rib, CF-Tuff-Cast, CF-Tuff-Wall	2-6 in. (50-150 mm)/ FP4	24-42 in. (610-1065 mm)	No Limit	Class S (severe)	Class + 90/-126 Zone H	4 ft 0 in. (1220 mm)	14 ga. [0.0710 in. (1.80 mm)]	50 ksi (315 MPa)
CF-Mesa, CF-Light Mesa, CF-Metl-Plank, CF-Flute, CF-Striated, CF-Santa Fe, CF-Architectural Flat, CF-V-Rib, CF-Tuff-Cast, CF-Tuff-Wall	2-6 in. (50-150 mm)/ FP4	24-42 in. (610-1065 mm)	No Limit	Class S (severe)	Class +85/-119 Zone HM-LM(FL)	4 ft 0 in. (1220 mm)	14 ga. [0.0710 in. (1.80 mm)]	50 ksi (315 MPa)
CF-Mesa, CF-Light Mesa, CF-Metl-Plank, CF-Flute, CF-Striated, CF-Santa Fe, CF-Architectural Flat, CF-V-Rib, CF-Tuff-Cast, CF-Tuff-Wall	2-6 in. (50-150 mm)/ FP4	24-42 in. (610-1065 mm)	No Limit	Class S (severe)	Class + 115/-161 Zone H	3 ft 0 in. (915 mm)	14 ga. [0.0710 in. (1.80 mm)]	50 ksi (315 MPa)
CF-Mesa, CF-Light Mesa, CF-Metl-Plank, CF-Flute, CF-Striated, CF-Santa Fe, CF-Architectural Flat, CF-V-Rib, CF-Tuff-Cast, CF-Tuff-Wall	2-6 in. (50-150 mm)/ FP4	24-42 in. (610-1065 mm)	No Limit	Class S (severe)	Class +110/-154 Zone HM-LM (FL)	3 ft 0 in. (915 mm)	14 ga. [0.0710 in. (1.80 mm)]	50 ksi (315 MPa)
CFI-Mesa, CFI-Light Mesa, CFI-V-Rib, CFI-Flute, CFI-Striated, CFI-Metl-Plank, CFI-Santa Fe, CFI-7.2 Insul-Rib	4-6 in. (100-150 mm)/ FP1	42 in. (1065 mm)	No Limit	Class S (severe)	Class +30/-42 Zone H	8 ft 0 in. (2440 mm)	14 ga. [0.0710 in. (1.80 mm)]	50 ksi (315 MPa)
CFI-Mesa, CFI-Light Mesa, CFI-V-Rib, CFI-Flute, CFI-Striated, CFI-Metl-Plank, CFI-Santa Fe, CFI-7.2 Insul-Rib	4-6 in. (100-150 mm)/ FP1	42 in. (1065 mm)	No Limit	Class S (severe)	Class +40/-56 Zone H	6 ft 0 in. (1830 mm)	14 ga. [0.0710 in. (1.80 mm)]	50 ksi (315 MPa)
CFI-Mesa, CFI-Light Mesa, CFI-V-Rib, CFI-Flute, CFI-Striated, CFI-Metl-Plank, CFI-Santa Fe, CFI-7.2 Insul-Rib	4-6 in. (100-150 mm)/ FP1	42 in. (1065 mm)	No Limit	Class S (severe)	Class +45/-63 Zone H	5 ft 0 in. (1525 mm)	14 ga. [0.0710 in. (1.80 mm)]	50 ksi (315 MPa)

CFI-Mesa, CFI-Light Mesa, CFI-V-Rib, CFI-Flute, CFI-Striated, CFI-Metl-Plank, CFI-Santa Fe, CFI-7.2 Insul-Rib	4-6 in. (100-150 mm)/ FP1	42 in. (1065 mm)	No Limit	Class S (severe)	Class +60/-84 Zone H	4 ft 0 in. (1220 mm)	14 ga. [0.0710 in.(1.80 mm)]	50 ksi (315 MPa)
CFI-Mesa, CFI-Light Mesa, CFI-V-Rib, CFI-Flute, CFI-Striated, CFI-Metl-Plank, CFI-Santa Fe, CFI-7.2 Insul-Rib	3-6 in. (75-150 mm)/ FP1	42 in. (1065 mm)	No Limit	Class S (severe)	Class +35/-49 Zone H	6 ft 0 in. (1830 mm)	14 ga. [0.0710 in.(1.80 mm)]	50 ksi (315 MPa)
CFI-Mesa, CFI-Light Mesa, CFI-V-Rib, CFI-Flute, CFI-Striated, CFI-Metl-Plank, CFI-Santa Fe, CFI-7.2 Insul-Rib	3-6 in. (75-150 mm)/ FP1	42 in. (1065 mm)	No Limit	Class S (severe)	Class +40/-56 Zone H	5 ft 0 in. (1525 mm)	14 ga. [0.0710 in.(1.80 mm)]	50 ksi (315 MPa)
CFI-Mesa, CFI-Light Mesa, CFI-V-Rib, CFI-Flute, CFI-Striated, CFI-Metl-Plank, CFI-Santa Fe, CFI-7.2 Insul-Rib	3-6 in. (75-150 mm)/ FP1	42 in. (1065 mm)	No Limit	Class S (severe)	Class +50/-70 Zone H	4 ft 0 in. (1220 mm)	14 ga. [0.0710 in.(1.80 mm)]	50 ksi (315 MPa)
CFI-Mesa, CFI-Light Mesa, CFI-V-Rib, CFI-Flute, CFI-Striated, CFI-Metl-Plank, CFI-Santa Fe, CFI-7.2 Insul-Rib	2.5-6 in. (65-150 mm)/ FP1	42 in. (1065 mm)	No Limit	Class S (severe)	Class +30/-42 Zone H	6 ft 0 in. (1830 mm)	14 ga. [0.0710 in.(1.80 mm)]	50 ksi (315 MPa)
CFI-Mesa, CFI-Light Mesa, CFI-V-Rib, CFI-Flute, CFI-Striated, CFI-Metl-Plank, CFI-Santa Fe, CFI-7.2 Insul-Rib	2.5-6 in. (65-150 mm)/ FP1	42 in. (1065 mm)	No Limit	Class S (severe)	Class +35/-49 Zone H	5 ft 0 in. (1525 mm)	14 ga. [0.0710 in.(1.80 mm)]	50 ksi (315 MPa)
CFI-Mesa, CFI-Light Mesa, CFI-V-Rib, CFI-Flute, CFI-Striated, CFI-Metl-Plank, CFI-Santa Fe, CFI-7.2 Insul-Rib	2.5-6 in. (65-150 mm)/ FP1	42 in. (1065 mm)	No Limit	Class S (severe)	Class +45/-63 Zone H	4 ft 0 in. (1220 mm)	14 ga. [0.0710 in.(1.80 mm)]	50 ksi (315 MPa)
CFI-Mesa, CFI-Light Mesa, CFI-V-Rib, CFI-Flute, CFI-Striated, CFI-Metl-Plank, CFI-Santa Fe	2-6 in. (50-150 mm)/ FP1	42 in. (1065 mm)	No Limit	Class S (severe)	Class +30/-42 Zone H	6 ft 0 in. (1830 mm)	14 ga. [0.0710 in.(1.80 mm)]	50 ksi (315 MPa)
CFI-Mesa, CFI-Light Mesa, CFI-V-Rib, CFI-Flute, CFI-Striated, CFI-Metl-Plank, CFI-Santa Fe	2-6 in. (50-150 mm)/ FP1	42 in. (1065 mm)	No Limit	Class S (severe)	Class +35/-49 Zone H	5 ft 0 in. (1525 mm)	14 ga. [0.0710 in.(1.80 mm)]	50 ksi (315 MPa)
CFI-Mesa, CFI-Light Mesa, CFI-V-Rib, CFI-Flute, CFI-Striated, CFI-Metl-Plank, CFI-Santa Fe	2-6 in. (50-150 mm)/ FP1	42 in. (1065 mm)	No Limit	Class S (severe)	Class +45/-63 Zone H	4 ft 0 in. (1220 mm)	14 ga. [0.0710 in.(1.80 mm)]	50 ksi (315 MPa)
CFI-Mesa, CFI-Light Mesa, CFI-V-Rib, CFI-Flute, CFI-Striated, CFI-Metl-Plank, CFI-Santa Fe	2-6 in. (50-150 mm)/ FP2	42 in. (1065 mm)	No Limit	Class S (severe)	Class +30/-42 Zone H	9 ft 3 in. (1220 mm)	14 ga. [0.0710 in.(1.80 mm)]	50 ksi (315 MPa)

<i>CFI-Mesa, CFI-Light Mesa, CFI-V-Rib, CFI-Flute, CFI-Striated, CFI-Metl-Plank, CFI-Santa Fe</i>	2-6 in. (50-150 mm)/ FP2	42 in. (1065 mm)	No Limit	Class S (severe)	Class +35/-49 Zone H	7 ft 0 in. (2135 mm)	14 ga. [0.0710 in.(1.80 mm)]	50 ksi (315 MPa)
<i>CFI-Mesa, CFI-Light Mesa, CFI-V-Rib, CFI-Flute, CFI-Striated, CFI-Metl-Plank, CFI-Santa Fe</i>	2-6 in. (50-150 mm)/ FP2	42 in. (1065 mm)	No Limit	Class S (severe)	Class +45/-63 Zone H	6 ft 0 in. (1830 mm)	14 ga. [0.0710 in.(1.80 mm)]	50 ksi (315 MPa)
<i>CFI-Mesa, CFI-Light Mesa, CFI-V-Rib, CFI-Flute, CFI-Striated, CFI-Metl-Plank, CFI-Santa Fe</i>	2-6 in. (50-150 mm)/ FP2	42 in. (1065 mm)	No Limit	Class S (severe)	Class +55/-77 Zone H	5 ft 0 in. (1525 mm)	14 ga. [0.0710 in.(1.80 mm)]	50 ksi (315 MPa)
<i>CFI-Mesa, CFI-Light Mesa, CFI-V-Rib, CFI-Flute, CFI-Striated, CFI-Metl-Plank, CFI-Santa Fe</i>	2-6 in. (50-150 mm)/ FP2	42 in. (1065 mm)	No Limit	Class S (severe)	Class +70/-98 Zone H	4 ft 0 in. (1220 mm)	14 ga. [0.0710 in.(1.80 mm)]	50 ksi (315 MPa)
<i>CFI-Mesa, CFI-Light Mesa, CFI-V-Rib, CFI-Flute, CFI-Striated, CFI-Metl-Plank, CFI-Santa Fe</i>	4-6 in. (100-150 mm)/ FP4	42 in. (1065 mm)	No Limit	Class S (severe)	Class +30/-42 Zone H	14 ft 6 in. (4420 mm)	14 ga. [0.0710 in.(1.80 mm)]	50 ksi (315 MPa)
<i>CFI-Mesa, CFI-Light Mesa, CFI-V-Rib, CFI-Flute, CFI-Striated, CFI-Metl-Plank, CFI-Santa Fe</i>	4-6 in. (100-150 mm)/ FP4	42 in. (1065 mm)	No Limit	Class S (severe)	Class +35/-49 Zone H	12 ft 0 in. (3660 mm)	14 ga. [0.0710 in.(1.80 mm)]	50 ksi (315 MPa)
<i>CFI-Mesa, CFI-Light Mesa, CFI-V-Rib, CFI-Flute, CFI-Striated, CFI-Metl-Plank, CFI-Santa Fe</i>	4-6 in. (100-150 mm)/ FP4	42 in. (1065 mm)	No Limit	Class S (severe)	Class +40/-56 Zone H	10 ft 0 in. (3050 mm)	14 ga. [0.0710 in.(1.80 mm)]	50 ksi (315 MPa)
<i>CFI-Mesa, CFI-Light Mesa, CFI-V-Rib, CFI-Flute, CFI-Striated, CFI-Metl-Plank, CFI-Santa Fe</i>	4-6 in. (100-150 mm)/ FP4	42 in. (1065 mm)	No Limit	Class S (severe)	Class +45/-63 Zone H	9 ft 0 in. (2745 mm)	14 ga. [0.0710 in.(1.80 mm)]	50 ksi (315 MPa)
<i>CFI-Mesa, CFI-Light Mesa, CFI-V-Rib, CFI-Flute, CFI-Striated, CFI-Metl-Plank, CFI-Santa Fe</i>	4-6 in. (100-150 mm)/ FP4	42 in. (1065 mm)	No Limit	Class S (severe)	Class +55/-77 Zone H	8 ft 0 in. (2440 mm)	14 ga. [0.0710 in.(1.80 mm)]	50 ksi (315 MPa)
<i>CFI-Mesa, CFI-Light Mesa, CFI-V-Rib, CFI-Flute, CFI-Striated, CFI-Metl-Plank, CFI-Santa Fe</i>	4-6 in. (100-150 mm)/ FP4	42 in. (1065 mm)	No Limit	Class S (severe)	Class +60/-84 Zone H	7 ft 0 in. (2135 mm)	14 ga. [0.0710 in.(1.80 mm)]	50 ksi (315 MPa)
<i>CFI-Mesa, CFI-Light Mesa, CFI-V-Rib, CFI-Flute, CFI-Striated, CFI-Metl-Plank, CFI-Santa Fe</i>	4-6 in. (100-150 mm)/ FP4	42 in. (1065 mm)	No Limit	Class S (severe)	Class +75/-105 Zone H	6 ft 0 in. (1830 mm)	14 ga. [0.0710 in.(1.80 mm)]	50 ksi (315 MPa)
<i>CFI-Mesa, CFI-Light Mesa, CFI-V-Rib, CFI-Flute, CFI-Striated, CFI-Metl-Plank, CFI-Santa Fe</i>	4-6 in. (100-150 mm)/ FP4	42 in. (1065 mm)	No Limit	Class S (severe)	Class +80/-112 Zone H	5 ft 0 in. (1525 mm)	14 ga. [0.0710 in.(1.80 mm)]	50 ksi (315 MPa)

<i>CFI-Mesa, CFI-Light Mesa, CFI-V-Rib, CFI-Flute, CFI-Striated, CFI-Metl-Plank, CFI-Santa Fe</i>	4-6 in. (100-150 mm)/ FP4	42 in. (1065 mm)	No Limit	Class S (severe)	Class +105/-147 Zone H	4 ft 0 in. (1220 mm)	14 ga. [0.0710 in.(1.80 mm)]	50 ksi (315 MPa)
<i>CFI-Mesa, CFI-Light Mesa, CFI-V-Rib, CFI-Flute, CFI-Striated, CFI-Metl-Plank, CFI-Santa Fe</i>	4-6 in. (100-150 mm)/ FP4	42 in. (1065 mm)	No Limit	Class S (severe)	Class +130/-182 Zone H	3 ft 0 in. (915 mm)	14 ga. [0.0710 in.(1.80 mm)]	50 ksi (315 MPa)
<i>CFI-Mesa, CFI-Light Mesa, CFI-V-Rib, CFI-Flute, CFI-Striated, CFI-Metl-Plank, CFI-Santa Fe</i>	3-6 in. (75-150 mm)/ FP4	42 in. (1065 mm)	No Limit	Class S (severe)	Class +30/-42 Zone H	12 ft 0 in. (3660 mm)	14 ga. [0.0710 in.(1.80 mm)]	50 ksi (315 MPa)
<i>CFI-Mesa, CFI-Light Mesa, CFI-V-Rib, CFI-Flute, CFI-Striated, CFI-Metl-Plank, CFI-Santa Fe</i>	3-6 in. (75-150 mm)/ FP4	42 in. (1065 mm)	No Limit	Class S (severe)	Class +35/-49 Zone H	10 ft 0 in. (3050 mm)	14 ga. [0.0710 in.(1.80 mm)]	50 ksi (315 MPa)
<i>CFI-Mesa, CFI-Light Mesa, CFI-V-Rib, CFI-Flute, CFI-Striated, CFI-Metl-Plank, CFI-Santa Fe</i>	3-6 in. (75-150 mm)/ FP4	42 in. (1065 mm)	No Limit	Class S (severe)	Class +40/-56 Zone H	9 ft 0 in. (2745 mm)	14 ga. [0.0710 in.(1.80 mm)]	50 ksi (315 MPa)
<i>CFI-Mesa, CFI-Light Mesa, CFI-V-Rib, CFI-Flute, CFI-Striated, CFI-Metl-Plank, CFI-Santa Fe</i>	3-6 in. (75-150 mm)/ FP4	42 in. (1065 mm)	No Limit	Class S (severe)	Class +50/-70 Zone H	8 ft 0 in. (2440 mm)	14 ga. [0.0710 in.(1.80 mm)]	50 ksi (315 MPa)
<i>CFI-Mesa, CFI-Light Mesa, CFI-V-Rib, CFI-Flute, CFI-Striated, CFI-Metl-Plank, CFI-Santa Fe</i>	3-6 in. (75-150 mm)/ FP4	42 in. (1065 mm)	No Limit	Class S (severe)	Class +55/-77 Zone H	7 ft 0 in. (2135 mm)	14 ga. [0.0710 in.(1.80 mm)]	50 ksi (315 MPa)
<i>CFI-Mesa, CFI-Light Mesa, CFI-V-Rib, CFI-Flute, CFI-Striated, CFI-Metl-Plank, CFI-Santa Fe</i>	3-6 in. (75-150 mm)/ FP4	42 in. (1065 mm)	No Limit	Class S (severe)	Class +65/-91 Zone H	6 ft 0 in. (1830 mm)	14 ga. [0.0710 in.(1.80 mm)]	50 ksi (315 MPa)
<i>CFI-Mesa, CFI-Light Mesa, CFI-V-Rib, CFI-Flute, CFI-Striated, CFI-Metl-Plank, CFI-Santa Fe</i>	3-6 in. (75-150 mm)/ FP4	42 in. (1065 mm)	No Limit	Class S (severe)	Class +75/-105 Zone H	5 ft 0 in. (1525 mm)	14 ga. [0.0710 in.(1.80 mm)]	50 ksi (315 MPa)
<i>CFI-Mesa, CFI-Light Mesa, CFI-V-Rib, CFI-Flute, CFI-Striated, CFI-Metl-Plank, CFI-Santa Fe</i>	3-6 in. (75-150 mm)/ FP4	42 in. (1065 mm)	No Limit	Class S (severe)	Class +95/-133 Zone H	4 ft 0 in. (1220 mm)	14 ga. [0.0710 in.(1.80 mm)]	50 ksi (315 MPa)
<i>CFI-Mesa, CFI-Light Mesa, CFI-V-Rib, CFI-Flute, CFI-Striated, CFI-Metl-Plank, CFI-Santa Fe</i>	3-6 in. (75-150 mm)/ FP4	42 in. (1065 mm)	No Limit	Class S (severe)	Class +120/-168 Zone H	3 ft 0 in. (915 mm)	14 ga. [0.0710 in.(1.80 mm)]	50 ksi (315 MPa)
<i>CFI-Mesa, CFI-Light Mesa, CFI-V-Rib, CFI-Flute, CFI-Striated, CFI-Metl-Plank, CFI-Santa Fe</i>	2.5-6 in. (65-150 mm)/ FP4	42 in. (1065 mm)	No Limit	Class S (severe)	Class +30/-42 Zone H	12 ft 0 in. (3660 mm)	14 ga. [0.0710 in.(1.80 mm)]	50 ksi (315 MPa)

<i>CFI-Mesa, CFI-Light Mesa, CFI-V-Rib, CFI-Flute, CFI-Striated, CFI-Metl-Plank, CFI-Santa Fe</i>	2.5-6 in. (65-150 mm)/ FP4	42 in. (1065 mm)	No Limit	Class S (severe)	Class +35/-49 Zone H	10 ft 0 in. (3050 mm)	14 ga. [0.0710 in.(1.80 mm)]	50 ksi (315 MPa)
<i>CFI-Mesa, CFI-Light Mesa, CFI-V-Rib, CFI-Flute, CFI-Striated, CFI-Metl-Plank, CFI-Santa Fe</i>	2.5-6 in. (65-150 mm)/ FP4	42 in. (1065 mm)	No Limit	Class S (severe)	Class +40/-56 Zone H	9 ft 0 in. (2745 mm)	14 ga. [0.0710 in.(1.80 mm)]	50 ksi (315 MPa)
<i>CFI-Mesa, CFI-Light Mesa, CFI-V-Rib, CFI-Flute, CFI-Striated, CFI-Metl-Plank, CFI-Santa Fe</i>	2.5-6 in. (65-150 mm)/ FP4	42 in. (1065 mm)	No Limit	Class S (severe)	Class +45/-63 Zone H	8 ft 0 in. (2440 mm)	14 ga. [0.0710 in.(1.80 mm)]	50 ksi (315 MPa)
<i>CFI-Mesa, CFI-Light Mesa, CFI-V-Rib, CFI-Flute, CFI-Striated, CFI-Metl-Plank, CFI-Santa Fe</i>	2.5-6 in. (65-150 mm)/ FP4	42 in. (1065 mm)	No Limit	Class S (severe)	Class +50/-70 Zone H	7 ft 0 in. (2135 mm)	14 ga. [0.0710 in.(1.80 mm)]	50 ksi (315 MPa)
<i>CFI-Mesa, CFI-Light Mesa, CFI-V-Rib, CFI-Flute, CFI-Striated, CFI-Metl-Plank, CFI-Santa Fe</i>	2.5-6 in. (65-150 mm)/ FP4	42 in. (1065 mm)	No Limit	Class S (severe)	Class +60/-84 Zone H	6 ft 0 in. (1830 mm)	14 ga. [0.0710 in.(1.80 mm)]	50 ksi (315 MPa)
<i>CFI-Mesa, CFI-Light Mesa, CFI-V-Rib, CFI-Flute, CFI-Striated, CFI-Metl-Plank, CFI-Santa Fe</i>	2.5-6 in. (65-150 mm)/ FP4	42 in. (1065 mm)	No Limit	Class S (severe)	Class +70/-98 Zone H	5 ft 0 in. (1525 mm)	14 ga. [0.0710 in.(1.80 mm)]	50 ksi (315 MPa)
<i>CFI-Mesa, CFI-Light Mesa, CFI-V-Rib, CFI-Flute, CFI-Striated, CFI-Metl-Plank, CFI-Santa Fe</i>	2.5-6 in. (65-150 mm)/ FP4	42 in. (1065 mm)	No Limit	Class S (severe)	Class +90/-126 Zone H	4 ft 0 in. (1220 mm)	14 ga. [0.0710 in.(1.80 mm)]	50 ksi (315 MPa)
<i>CFI-Mesa, CFI-Light Mesa, CFI-V-Rib, CFI-Flute, CFI-Striated, CFI-Metl-Plank, CFI-Santa Fe</i>	2.5-6 in. (65-150 mm)/ FP4	42 in. (1065 mm)	No Limit	Class S (severe)	Class +115/-161 Zone H	3 ft 0 in. (915 mm)	14 ga. [0.0710 in.(1.80 mm)]	50 ksi (315 MPa)
<i>CFI-Mesa, CFI-Light Mesa, CFI-V-Rib, CFI-Flute, CFI-Striated, CFI-Metl-Plank, CFI-Santa Fe</i>	2-6 in. (50-150 mm)/ FP4	42 in. (1065 mm)	No Limit	Class S (severe)	Class +30/-42 Zone H	12 ft 0 in. (3660 mm)	14 ga. [0.0710 in.(1.80 mm)]	50 ksi (315 MPa)
<i>CFI-Mesa, CFI-Light Mesa, CFI-V-Rib, CFI-Flute, CFI-Striated, CFI-Metl-Plank, CFI-Santa Fe</i>	2-6 in. (50-150 mm)/ FP4	42 in. (1065 mm)	No Limit	Class S (severe)	Class +35/-49 Zone H	10 ft 0 in. (3050 mm)	14 ga. [0.0710 in.(1.80 mm)]	50 ksi (315 MPa)
<i>CFI-Mesa, CFI-Light Mesa, CFI-V-Rib, CFI-Flute, CFI-Striated, CFI-Metl-Plank, CFI-Santa Fe</i>	2-6 in. (50-150 mm)/ FP4	42 in. (1065 mm)	No Limit	Class S (severe)	Class +40/-56 Zone H	9 ft 0 in. (2745 mm)	14 ga. [0.0710 in.(1.80 mm)]	50 ksi (315 MPa)
<i>CFI-Mesa, CFI-Light Mesa, CFI-V-Rib, CFI-Flute, CFI-Striated, CFI-Metl-Plank, CFI-Santa Fe</i>	2-6 in. (50-150 mm)/ FP4	42 in. (1065 mm)	No Limit	Class S (severe)	Class +45/-63 Zone H	8 ft 0 in. (2440 mm)	14 ga. [0.0710 in.(1.80 mm)]	50 ksi (315 MPa)

<i>CFI-Mesa, CFI-Light Mesa, CFI-V-Rib, CFI-Flute, CFI-Striated, CFI-Metl-Plank, CFI-Santa Fe</i>	2-6 in. (50-150 mm)/ FP4	42 in. (1065 mm)	No Limit	Class S (severe)	Class +50/-70 Zone H	7 ft 0 in. (2135 mm)	14 ga. [0.0710 in.(1.80 mm)]	50 ksi (315 MPa)
<i>CFI-Mesa, CFI-Light Mesa, CFI-V-Rib, CFI-Flute, CFI-Striated, CFI-Metl-Plank, CFI-Santa Fe</i>	2-6 in. (50-150 mm)/ FP4	42 in. (1065 mm)	No Limit	Class S (severe)	Class +60/-84 Zone H	6 ft 0 in. (1830 mm)	14 ga. [0.0710 in.(1.80 mm)]	50 ksi (315 MPa)
<i>CFI-Mesa, CFI-Light Mesa, CFI-V-Rib, CFI-Flute, CFI-Striated, CFI-Metl-Plank, CFI-Santa Fe</i>	2-6 in. (50-150 mm)/ FP4	42 in. (1065 mm)	No Limit	Class S (severe)	Class +70/-98 Zone H	5 ft 0 in. (1525 mm)	14 ga. [0.0710 in.(1.80 mm)]	50 ksi (315 MPa)
<i>CFI-Mesa, CFI-Light Mesa, CFI-V-Rib, CFI-Flute, CFI-Striated, CFI-Metl-Plank, CFI-Santa Fe</i>	2-6 in. (50-150 mm)/ FP4	42 in. (1065 mm)	No Limit	Class S (severe)	Class +90/-126 Zone H	4 ft 0 in. (1220 mm)	14 ga. [0.0710 in.(1.80 mm)]	50 ksi (315 MPa)
<i>CFI-Mesa, CFI-Light Mesa, CFI-V-Rib, CFI-Flute, CFI-Striated, CFI-Metl-Plank, CFI-Santa Fe</i>	2-6 in. (50-150 mm)/ FP4	42 in. (1065 mm)	No Limit	Class S (severe)	Class +115/-161 Zone H	3 ft 0 in. (915 mm)	14 ga. [0.0710 in.(1.80 mm)]	50 ksi (315 MPa)
<i>CF-Flute, CF-Mesa, CF-42-Mesa, CF-Metl-Plank, CFI-Light Mesa, CFI-Flute, CFI-Mesa, CFI-Light Mesa, CFI-Metl-Plank</i>	4-6 in. (100-150 mm)/ FP10	42 in. (1065 mm)	No Limit	Class S (severe)	Class +35/-49 Zone H	15 ft 9 in. (4800 mm)	14 ga. [0.0710 in.(1.80 mm)]	50 ksi (315 MPa)
<i>CF-Flute, CF-Mesa, CF-42-Mesa, CF-Metl-Plank, CFI-Light Mesa, CFI-Flute, CFI-Mesa, CFI-Light Mesa, CFI-Metl-Plank</i>	4-6 in. (100-150 mm)/ FP10	42 in. (1065 mm)	No Limit	Class S (severe)	Class +40/-56 Zone H	14 ft 0 in. (4265 mm)	14 ga. [0.0710 in.(1.80 mm)]	50 ksi (315 MPa)
<i>CF-Flute, CF-Mesa, CF-42-Mesa, CF-Metl-Plank, CFI-Light Mesa, CFI-Flute, CFI-Mesa, CFI-Light Mesa, CFI-Metl-Plank</i>	4-6 in. (100-150 mm)/ FP10	42 in. (1065 mm)	No Limit	Class S (severe)	Class +45/-63 Zone H	12 ft 0 in. (3660 mm)	14 ga. [0.0710 in.(1.80 mm)]	50 ksi (315 MPa)
<i>CF-Flute, CF-Mesa, CF-42-Mesa, CF-Metl-Plank, CFI-Light Mesa, CFI-Flute, CFI-Mesa, CFI-Light Mesa, CFI-Metl-Plank</i>	4-6 in. (100-150 mm)/ FP10	42 in. (1065 mm)	No Limit	Class S (severe)	Class +50/-70 Zone H	11 ft 0 in. (3355 mm)	14 ga. [0.0710 in.(1.80 mm)]	50 ksi (315 MPa)
<i>CF-Flute, CF-Mesa, CF-42-Mesa, CF-Metl-Plank, CFI-Light Mesa, CFI-Flute, CFI-Mesa, CFI-Light Mesa, CFI-Metl-Plank</i>	4-6 in. (100-150 mm)/ FP10	42 in. (1065 mm)	No Limit	Class S (severe)	Class +55/-77 Zone H	10 ft 0 in. (3050 mm)	14 ga. [0.0710 in.(1.80 mm)]	50 ksi (315 MPa)
<i>CF-Flute, CF-Mesa, CF-42-Mesa, CF-Metl-Plank, CFI-Light Mesa, CFI-Flute, CFI-Mesa, CFI-Light Mesa, CFI-Metl-Plank</i>	4-6 in. (100-150 mm)/ FP10	42 in. (1065 mm)	No Limit	Class S (severe)	Class +60/-84 Zone H	9 ft 0 in. (2745 mm)	14 ga. [0.0710 in.(1.80 mm)]	50 ksi (315 MPa)

CF-Flute, CF-Mesa, CF-42-Mesa, CF-Metl-Plank, CFI-Light Mesa, CFI-Flute, CFI-Mesa, CFI-Light Mesa, CFI-Metl-Plank	4-6 in. (100-150 mm)/ FP10	42 in. (1065 mm)	No Limit	Class S (severe)	Class +70/-98 Zone H	8 ft 0 in. (2440 mm)	14 ga. [0.0710 in.(1.80 mm)]	50 ksi (315 MPa)
CF-Flute, CF-Mesa, CF-42-Mesa, CF-Metl-Plank, CFI-Light Mesa, CFI-Flute, CFI-Mesa, CFI-Light Mesa, CFI-Metl-Plank	4-6 in. (100-150 mm)/ FP10	42 in. (1065 mm)	No Limit	Class S (severe)	Class +80/-112 Zone H	7 ft 0 in. (2135 mm)	14 ga. [0.0710 in.(1.80 mm)]	50 ksi (315 MPa)
CF-Flute, CF-Mesa, CF-42-Mesa, CF-Metl-Plank, CFI-Light Mesa, CFI-Flute, CFI-Mesa, CFI-Light Mesa, CFI-Metl-Plank	4-6 in. (100-150 mm)/ FP10	42 in. (1065 mm)	No Limit	Class S (severe)	Class +95/-133 Zone H	6 ft 0 in. (1830 mm)	14 ga. [0.0710 in.(1.80 mm)]	50 ksi (315 MPa)
CF-Flute, CF-Mesa, CF-42-Mesa, CF-Metl-Plank, CFI-Light Mesa, CFI-Flute, CFI-Mesa, CFI-Light Mesa, CFI-Metl-Plank	3-6 in. (75-150 mm)/ FP10	42 in. (1065 mm)	No Limit	Class S (severe)	Class +35/-49 Zone H	12 ft 9 in. (3885 mm)	14 ga.	50 ksi (315 MPa)
CF-Flute, CF-Mesa, CF-42-Mesa, CF-Metl-Plank, CFI-Light Mesa, CFI-Flute, CFI-Mesa, CFI-Light Mesa, CFI-Metl-Plank	3-6 in. (75-150 mm)/ FP10	42 in. (1065 mm)	No Limit	Class S (severe)	Class +40/-56 Zone H	12 ft 0 in. (3660 mm)	14 ga. [0.0710 in.(1.80 mm)]	50 ksi (315 MPa)
CF-Flute, CF-Mesa, CF-42-Mesa, CF-Metl-Plank, CFI-Light Mesa, CFI-Flute, CFI-Mesa, CFI-Light Mesa, CFI-Metl-Plank	3-6 in. (75-150 mm)/ FP10	42 in. (1065 mm)	No Limit	Class S (severe)	Class +45/-63 Zone H	11 ft 0 in. (3355 mm)	14 ga. [0.0710 in.(1.80 mm)]	50 ksi (315 MPa)
CF-Flute, CF-Mesa, CF-42-Mesa, CF-Metl-Plank, CFI-Light Mesa, CFI-Flute, CFI-Mesa, CFI-Light Mesa, CFI-Metl-Plank	3-6 in. (75-150 mm)/ FP10	42 in. (1065 mm)	No Limit	Class S (severe)	Class +50/-70 Zone H	10 ft 0 in. (3050 mm)	14 ga. [0.0710 in.(1.80 mm)]	50 ksi (315 MPa)
CF-Flute, CF-Mesa, CF-42-Mesa, CF-Metl-Plank, CFI-Light Mesa, CFI-Flute, CFI-Mesa, CFI-Light Mesa, CFI-Metl-Plank	3-6 in. (75-150 mm)/ FP10	42 in. (1065 mm)	No Limit	Class S (severe)	Class +55/-77 Zone H	9 ft 0 in. (2745 mm)	14 ga. [0.0710 in.(1.80 mm)]	50 ksi (315 MPa)
CF-Flute, CF-Mesa, CF-42-Mesa, CF-Metl-Plank, CFI-Light Mesa, CFI-Flute, CFI-Mesa, CFI-Light Mesa, CFI-Metl-Plank	3-6 in. (75-150 mm)/ FP10	42 in. (1065 mm)	No Limit	Class S (severe)	Class +60/-84 Zone H	8 ft 0 in. (2440 mm)	14 ga. [0.0710 in.(1.80 mm)]	50 ksi (315 MPa)
CF-Flute, CF-Mesa, CF-42-Mesa, CF-Metl-Plank, CFI-Light Mesa, CFI-Flute, CFI-Mesa, CFI-Light Mesa, CFI-Metl-Plank	3-6 in. (75-150 mm)/ FP10	42 in. (1065 mm)	No Limit	Class S (severe)	Class +70/-98 Zone H	7 ft 0 in. (2135 mm)	14 ga. [0.0710 in.(1.80 mm)]	50 ksi (315 MPa)

CF-Flute, CF-Mesa, CF-42-Mesa, CF-Metl-Plank, CFI-Light Mesa, CFI-Flute, CFI-Mesa, CFI-Light Mesa, CFI-Metl-Plank	3-6 in. (75-150 mm)/ FP10	42 in. (1065 mm)	No Limit	Class S (severe)	Class +85/-119 Zone H	6 ft 0 in. (1830 mm)	14 ga. [0.0710 in.(1.80 mm)]	50 ksi (315 MPa)
CF-Flute, CF-Mesa, CF-42-Mesa, CF-Metl-Plank, CFI-Light Mesa, CFI-Flute, CFI-Mesa, CFI-Light Mesa, CFI-Metl-Plank	2.5-6 in. (50-150 mm)/ FP10	42 in. (1065 mm)	No Limit	Class S (severe)	Class +35/-49 Zone H	12 ft 9 in. (3885 mm)	14 ga. [0.0710 in.(1.80 mm)]	50 ksi (315 MPa)
CF-Flute, CF-Mesa, CF-42-Mesa, CF-Metl-Plank, CFI-Light Mesa, CFI-Flute, CFI-Mesa, CFI-Light Mesa, CFI-Metl-Plank	2.5-6 in. (50-150 mm)/ FP10	42 in. (1065 mm)	No Limit	Class S (severe)	Class +40/-56 Zone H	11 ft 0 in. (3355 mm)	14 ga. [0.0710 in.(1.80 mm)]	50 ksi (315 MPa)
CF-Flute, CF-Mesa, CF-42-Mesa, CF-Metl-Plank, CFI-Light Mesa, CFI-Flute, CFI-Mesa, CFI-Light Mesa, CFI-Metl-Plank	2.5-6 in. (50-150 mm)/ FP10	42 in. (1065 mm)	No Limit	Class S (severe)	Class +45/-63 Zone H	10 ft 0 in. (3050 mm)	14 ga. [0.0710 in.(1.80 mm)]	50 ksi (315 MPa)
CF-Flute, CF-Mesa, CF-42-Mesa, CF-Metl-Plank, CFI-Light Mesa, CFI-Flute, CFI-Mesa, CFI-Light Mesa, CFI-Metl-Plank	2.5-6 in. (50-150 mm)/ FP10	42 in. (1065 mm)	No Limit	Class S (severe)	Class +50/-70 Zone H	9 ft 0 in. (2745 mm)	14 ga. [0.0710 in.(1.80 mm)]	50 ksi (315 MPa)
CF-Flute, CF-Mesa, CF-42-Mesa, CF-Metl-Plank, CFI-Light Mesa, CFI-Flute, CFI-Mesa, CFI-Light Mesa, CFI-Metl-Plank	2.5-6 in. (50-150 mm)/ FP10	42 in. (1065 mm)	No Limit	Class S (severe)	Class +55/-77 Zone H	8 ft 0 in. (2440 mm)	14 ga. [0.0710 in.(1.80 mm)]	50 ksi (315 MPa)
CF-Flute, CF-Mesa, CF-42-Mesa, CF-Metl-Plank, CFI-Light Mesa, CFI-Flute, CFI-Mesa, CFI-Light Mesa, CFI-Metl-Plank	2.5-6 in. (50-150 mm)/ FP10	42 in. (1065 mm)	No Limit	Class S (severe)	Class +65/-91 Zone H	7 ft 0 in. (2135 mm)	14 ga. [0.0710 in.(1.80 mm)]	50 ksi (315 MPa)
CF-Flute, CF-Mesa, CF-42-Mesa, CF-Metl-Plank, CFI-Light Mesa, CFI-Flute, CFI-Mesa, CFI-Light Mesa, CFI-Metl-Plank	2.5-6 in. (50-150 mm)/ FP10	42 in. (1065 mm)	No Limit	Class S (severe)	Class +80/-112 Zone H	6 ft 0 in. (1830 mm)	14 ga. [0.0710 in.(1.80 mm)]	50 ksi (315 MPa)
CF-Flute, CF-Mesa, CF-42-Mesa, CF-Metl-Plank, CFI-Light Mesa, CFI-Flute, CFI-Mesa, CFI-Light Mesa, CFI-Metl-Plank	2-6 in. (50-150 mm)/ FP10	42 in. (1065 mm)	No Limit	Class S (severe)	Class +35/-49 Zone H	12 ft 9 in. (3885 mm)	14 ga. [0.0710 in.(1.80 mm)]	50 ksi (315 MPa)
CF-Flute, CF-Mesa, CF-42-Mesa, CF-Metl-Plank, CFI-Light Mesa, CFI-Flute, CFI-Mesa, CFI-Light Mesa, CFI-Metl-Plank	2-6 in. (50-150 mm)/ FP10	42 in. (1065 mm)	No Limit	Class S (severe)	Class +40/-56 Zone H	11 ft 0 in. (3355 mm)	14 ga. [0.0710 in.(1.80 mm)]	50 ksi (315 MPa)

CF-Flute, CF-Mesa, CF-42-Mesa, CF-Metl-Plank, CFI-Light Mesa, CFI-Flute, CFI-Mesa, CFI-Light Mesa, CFI-Metl-Plank	2-6 in. (50-150 mm)/ FP10	42 in. (1065 mm)	No Limit	Class S (severe)	Class +45/-63 Zone H	10 ft 0 in. (3050 mm)	14 ga. [0.0710 in.(1.80 mm)]	50 ksi (315 MPa)
CF-Flute, CF-Mesa, CF-42-Mesa, CF-Metl-Plank, CFI-Light Mesa, CFI-Flute, CFI-Mesa, CFI-Light Mesa, CFI-Metl-Plank	2-6 in. (50-150 mm)/ FP10	42 in. (1065 mm)	No Limit	Class S (severe)	Class +50/-70 Zone H	9 ft 0 in. (2745 mm)	14 ga. [0.0710 in.(1.80 mm)]	50 ksi (315 MPa)
CF-Flute, CF-Mesa, CF-42-Mesa, CF-Metl-Plank, CFI-Light Mesa, CFI-Flute, CFI-Mesa, CFI-Light Mesa, CFI-Metl-Plank	2-6 in. (50-150 mm)/ FP10	42 in. (1065 mm)	No Limit	Class S (severe)	Class +55/-77 Zone H	8 ft 0 in. (2440 mm)	14 ga. [0.0710 in.(1.80 mm)]	50 ksi (315 MPa)
CF-Flute, CF-Mesa, CF-42-Mesa, CF-Metl-Plank, CFI-Light Mesa, CFI-Flute, CFI-Mesa, CFI-Light Mesa, CFI-Metl-Plank	2-6 in. (75-150 mm)/ FP10	42 in. (1065 mm)	No Limit	Class S (severe)	Class +60/-84 Zone H	7 ft 0 in. (2135 mm)	14 ga. [0.0710 in.(1.80 mm)]	50 ksi (315 MPa)
CF-Flute, CF-Mesa, CF-42-Mesa, CF-Metl-Plank, CFI-Light Mesa, CFI-Flute, CFI-Mesa, CFI-Light Mesa, CFI-Metl-Plank	2-6 in. (50-150 mm)/ FP10	42 in. (1065 mm)	No Limit	Class S (severe)	Class +75/-105 Zone H	6 ft 0 in. (1830 mm)	14 ga. [0.0710 in.(1.80 mm)]	50 ksi (315 MPa)
CF-7.2 Insul-Rib, CFI-7.2 Insul-Rib	4-6 in. (100-150 mm)/ FP11	36 in (915 mm)	No Limit	Class S (severe)	Class +35/-49 Zone H	15 ft 9 in. (4800 mm)	14 ga. [0.0710 in.(1.80mm)]	50 ksi (315 MPa)
CF-7.2 Insul-Rib, CFI-7.2 Insul-Rib	4-6 in. (100-150 mm)/ FP11	36 in (915 mm)	No Limit	Class S (severe)	Class +40/-56 Zone H	14 ft 0 in. (4265 mm)	14 ga. [0.0710 in.(1.80mm)]	50 ksi (315 MPa)
CF-7.2 Insul-Rib, CFI-7.2 Insul-Rib	4-6 in. (100-150 mm)/ FP11	36 in (915 mm)	No Limit	Class S (severe)	Class +45/-63 Zone H	12 ft 0 in. (3660 mm)	14 ga. [0.0710 in.(1.80mm)]	50 ksi (315 MPa)
CF-7.2 Insul-Rib, CFI-7.2 Insul-Rib	4-6 in. (100-150 mm)/ FP11	36 in (915 mm)	No Limit	Class S (severe)	Class +50/-70 Zone H	11 ft 0 in. (3355 mm)	14 ga. [0.0710 in.(1.80mm)]	50 ksi (315 MPa)
CF-7.2 Insul-Rib, CFI-7.2 Insul-Rib	4-6 in. (100-150 mm)/ FP11	36 in (915 mm)	No Limit	Class S (severe)	Class +55/-77 Zone H	10 ft 0 in. (3050 mm)	14 ga. [0.0710 in.(1.80mm)]	50 ksi (315 MPa)
CF-7.2 Insul-Rib, CFI-7.2 Insul-Rib	4-6 in. (100-150 mm)/ FP11	36 in (915 mm)	No Limit	Class S (severe)	Class +60/-84 Zone H	9 ft 0 in. (2745 mm)	14 ga. [0.0710 in.(1.80mm)]	50 ksi (315 MPa)
CF-7.2 Insul-Rib, CFI-7.2 Insul-Rib	4-6 in. (100-150 mm)/ FP11	36 in (915 mm)	No Limit	Class S (severe)	Class +70/-98 Zone H	8 ft 0 in. (2440 mm)	14 ga. [0.0710 in.(1.80mm)]	50 ksi (315 MPa)
CF-7.2 Insul-Rib, CFI-7.2 Insul-Rib	4-6 in. (100-150 mm)/ FP11	36 in (915 mm)	No Limit	Class S (severe)	Class +80/-112 Zone H	7 ft 0 in. (2135 mm)	14 ga. [0.0710 in.(1.80mm)]	50 ksi (315 MPa)
CF-7.2 Insul-Rib, CFI-7.2 Insul-Rib	4-6 in. (100-150 mm)/ FP11	36 in (915 mm)	No Limit	Class S (severe)	Class +95/-133 Zone H	6 ft 0 in. (1830 mm)	14 ga. [0.0710 in.(1.80mm)]	50 ksi (315 MPa)
CF-7.2 Insul-Rib, CFI-7.2 Insul-Rib	3-6 in. (75-150 mm)/ FP11	36 in (915 mm)	No Limit	Class S (severe)	Class +35/-49 Zone H	12 ft 9 in. (3885 mm)	14 ga. [0.0710 in.(1.80mm)]	50 ksi (315 MPa)

CF-7.2 Insul-Rib, CFI-7.2 Insul-Rib	3-6 in. (75-150 mm) FP11	36 in (915 mm)	No Limit	Class S (severe)	Class +40/-56 Zone H	12 ft 0 in. (3660 mm)	14 ga. [0.0710 in. (1.80mm)]	50 ksi (315 MPa)
CF-7.2 Insul-Rib, CFI-7.2 Insul-Rib	3-6 in. (75-150 mm) FP11	36 in (915 mm)	No Limit	Class S (severe)	Class +45/-63 Zone H	11 ft 0 in. (3355 mm)	14 ga. [0.0710 in. (1.80mm)]	50 ksi (315 MPa)
CF-7.2 Insul-Rib, CFI-7.2 Insul-Rib	3-6 in. (75-150 mm) FP11	36 in (915 mm)	No Limit	Class S (severe)	Class +50/-70 Zone H	10 ft 0 in. (3050 mm)	14 ga. [0.0710 in. (1.80mm)]	50 ksi (315 MPa)
CF-7.2 Insul-Rib, CFI-7.2 Insul-Rib	3-6 in. (75-150 mm) FP11	36 in (915 mm)	No Limit	Class S (severe)	Class +55/-77 Zone H	9 ft 0 in. (2745 mm)	14 ga. [0.0710 in. (1.80mm)]	50 ksi (315 MPa)
CF-7.2 Insul-Rib, CFI-7.2 Insul-Rib	3-6 in. (75-150 mm) FP11	36 in (915 mm)	No Limit	Class S (severe)	Class +60/-84 Zone H	8 ft 0 in. (2440 mm)	14 ga. [0.0710 in. (1.80mm)]	50 ksi (315 MPa)
CF-7.2 Insul-Rib, CFI-7.2 Insul-Rib	3-6 in. (75-150 mm) FP11	36 in (915 mm)	No Limit	Class S (severe)	Class +70/-98 Zone H	7 ft 0 in. (2135 mm)	14 ga. [0.0710 in. (1.80mm)]	50 ksi (315 MPa)
CF-7.2 Insul-Rib, CFI-7.2 Insul-Rib	3-6 in. (75-150 mm) FP11	36 in (915 mm)	No Limit	Class S (severe)	Class +85/-119 Zone H	6 ft 0 in. (1830 mm)	14 ga. [0.0710 in. (1.80mm)]	50 ksi (315 MPa)
CF-7.2 Insul-Rib, CFI-7.2 Insul-Rib	2.5-6 in. (50-150 mm) FP11	36 in (915 mm)	No Limit	Class S (severe)	Class +35/-49 Zone H	12 ft 9 in. (3885 mm)	14 ga. [0.0710 in. (1.80mm)]	50 ksi (315 MPa)
CF-7.2 Insul-Rib, CFI-7.2 Insul-Rib	2.5-6 in. (50-150 mm) FP11	36 in (915 mm)	No Limit	Class S (severe)	Class +40/-56 Zone H	11 ft 0 in. (3355 mm)	14 ga. [0.0710 in. (1.80mm)]	50 ksi (315 MPa)
CF-7.2 Insul-Rib, CFI-7.2 Insul-Rib	2.5-6 in. (50-150 mm) FP11	36 in (915 mm)	No Limit	Class S (severe)	Class +45/-63 Zone H	10 ft 0 in. (3050 mm)	14 ga. [0.0710 in. (1.80mm)]	50 ksi (315 MPa)
CF-7.2 Insul-Rib, CFI-7.2 Insul-Rib	2.5-6 in. (50-150 mm) FP11	36 in (915 mm)	No Limit	Class S (severe)	Class +50/-70 Zone H	9 ft 0 in. (2745 mm)	14 ga. [0.0710 in. (1.80mm)]	50 ksi (315 MPa)
CF-7.2 Insul-Rib, CFI-7.2 Insul-Rib	2.5-6 in. (50-150 mm) FP11	36 in (915 mm)	No Limit	Class S (severe)	Class +55/-77 Zone H	8 ft 0 in. (2440 mm)	14 ga. [0.0710 in. (1.80mm)]	50 ksi (315 MPa)
CF-7.2 Insul-Rib, CFI-7.2 Insul-Rib	2.5-6 in. (50-150 mm) FP11	36 in (915 mm)	No Limit	Class S (severe)	Class +65/-91 Zone H	7 ft 0 in. (2135 mm)	14 ga. [0.0710 in. (1.80mm)]	50 ksi (315 MPa)
CF-7.2 Insul-Rib, CFI-7.2 Insul-Rib	2.5-6 in. (50-150 mm) FP11	36 in (915 mm)	No Limit	Class S (severe)	Class +80/-112 Zone H	6 ft 0 in. (1830 mm)	14 ga. [0.0710 in. (1.80mm)]	50 ksi (315 MPa)

Table Notes: Panels rated for Zone H may be used in Zones H and NH. Panels rated for Zone HM-LM may be used in Zones HM, H and NH. Panels rated for Zone HM-LM (FL) may be used in Zones HM-LM (FL), HM-LM, H and NH. See below for installation details for specific exterior wall panels.

CF-Mesa, CF-Light Mesa, CF-Flute, CF-Metl-Plank, CF-Striated, CF-Santa Fe, CF-Architectural Flat, CF-V-Rib, CF-Tuff-Cast, CF-Tuff-Wall, CF-7.2 Insul-Rib, CFI-Mesa, CFI-Light Mesa, CFI-V-Rib, CFI-Flute, CFI-Striated, CFI-Metl-Plank, CFI-Santa Fe, CFI-7.2 Insul-Rib - installed vertically or horizontally over steel structural members as indicated in the table above.

FP1 - Clip Attachment Screws (stainless steel or coated carbon steel 1/4-14 HWH self drilling fasteners with type 3 points, 1/4-14, 1/4-20, 1/4-28 or 12-24 HWH self drilling fasteners with type 5 points or #14-14 HWH self tapping fasteners with type AB, B or BP points through one U-Clip at each bearing in each panel side joint.

FP2 - Clip Attachment Screws (stainless steel or coated carbon steel 1/4-14 HWH self drilling fasteners with type 3 points, 1/4-14, 1/4-20, 1/4-28 or 12-24 HWH self drilling fasteners with type 5 points or #14-14 HWH self tapping fasteners with type AB, B or BP points through one U-Clip at each bearing in each panel side joint and one Fab-Lok fastener (10-4, 10-8 or 10-12 suitable for the thickness of the structural member) or Bulb-tite Structural Blind Rivets (RV6603-9-3, RV66903-9-6, RV6603-9-10 or RV6603-9-12 suitable for the thickness of the structural member) per bearing through the structural member into the interior panel facer 10-1/2 in. (265 mm) ± 1.5 in. (38 mm) from each female panel edge through holes predrilled with a 5/16in. (7.9 mm) diameter drill bit.

FP4 - Clip Attachment Screws (stainless steel or coated carbon steel 1/4-14 HWH self drilling fasteners with type 3 points, 1/4-14, 1/4-20, 1/4-28 or

12-24 HWH self drilling fasteners with type 5 points or #14-14 HWH self tapping fasteners with type AB, B or BP points) through one U-Clip at each bearing in each panel side joint and three Fab-Lok fasteners (10-4, 10-8 or 10-12 suitable for the thickness of the structural member) or Bulb-tite Structural Blind Rivets (RV6603-9-3, RV66903-9-6, RV6603-9-10 or RV6603-9-12 suitable for the thickness of the structural member) per bearing through the structural member into the interior panel facer equally spaced [\pm 1.5 in. (38 mm)] between U-Clips through holes predrilled with a 5/16 in. (7.9 mm) diameter drill bit.

CF-Flute, CF-Mesa, CF-Light Mesa, CF-Metl-Plank, CFI-Flute, CFI-Mesa, CFI-Light Mesa & CFI-Metl-Plank - installed vertically or horizontally over steel structural members as indicated in the table above.

FP10 - Panels through fastened to each steel support with Panel Attachment Screws with Sealing Washers 3 to 8 in. (75 to 200 mm) long stainless steel or coated carbon steel fasteners with 3/8 in. (9.5 mm) hex washer heads and 5/8 in. (16 mm) diameter sealing washers; 1/4-14 HWH self drilling fasteners with type 3 points for minimum 14 ga. [0.0710 in. (1.8 mm)] steel supports, 1/4-14, 1/4-20, 1/4-28 or 12-24 HWH self drilling fasteners with type 5 points for minimum 3/16 in. (4.75 mm) steel supports or #14-14 HWH self tapping fasteners with type AB, B or BP points for minimum 14 ga. [0.0710 in. (1.8 mm)] steel supports through properly sized pilot holes) 8.4 in. (215 mm) on center.

CF-7.2 Insul-Rib AND CFI-7.2 Insul-Rib - installed vertically or horizontally over steel structural members as indicated in the table above.

FP11 - Panels through fastened to each steel support with Panel Attachment Screws with Sealing Washers (3 to 8 in. (75 to 200 mm) long stainless steel or coated carbon steel fasteners with 3/8 in. (9.5 mm) hex washer heads and 5/8 in. (16 mm) diameter sealing washers; 1/4-14 HWH self drilling fasteners with type 3 points for minimum 14 ga. [0.0710 in. (1.8 mm)] steel supports, 1/4-14, 1/4-20, 1/4-28 or 12-24 HWH self drilling fasteners with type 5 points for minimum 3/16 in. (4.75 mm) steel supports or #14-14 HWH self tapping fasteners with type AB, B or BP points for minimum 14 ga. [0.0710 in. (1.8 mm)] steel supports through properly sized pilot holes) 7.2 in. (185 mm) on center.

GREEN - This product contains no urea-formaldehyde.

GREEN - This product contains no CFC or HCFC.

Company Name:	Metl-Span LLC
Company Address:	1497 N Kealy St, Lewisville, Texas 75057, USA
Company Website:	http://www.metlspan.com
Green Product:	Yes
Primary Class of Work:	4881-Exterior Wall Systems
Listing Country:	United States of America
Certification Type:	FM Approved

FM APPROVALS

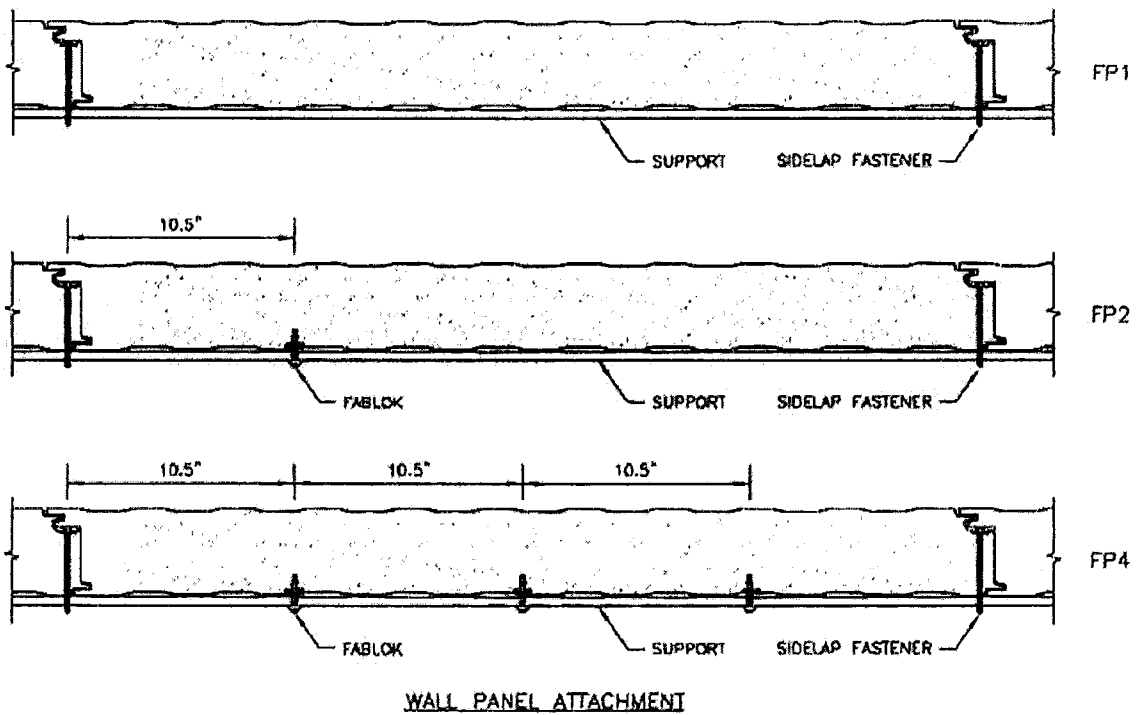
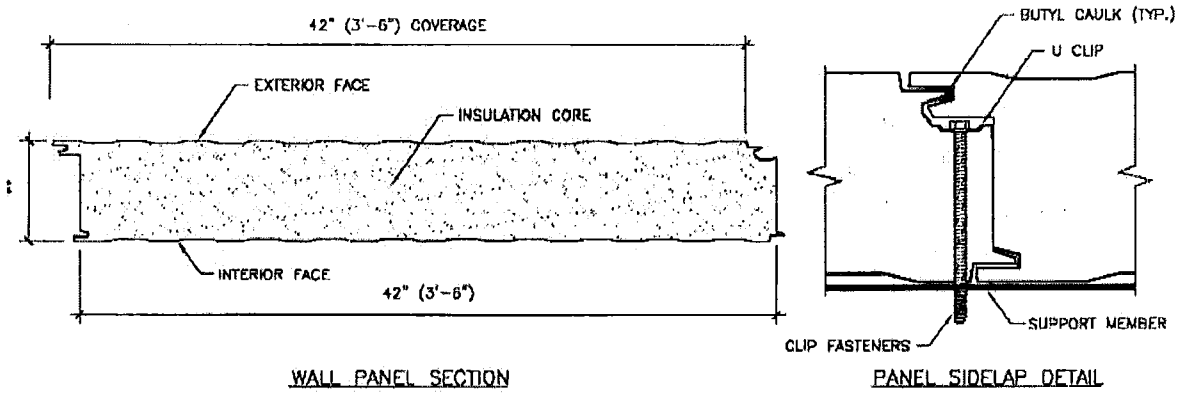

Note: FABLOK fasteners may be replaced with Bulb-tite Structural Blind Rivets.

FM APPROVALS

Wall Panel Attachment

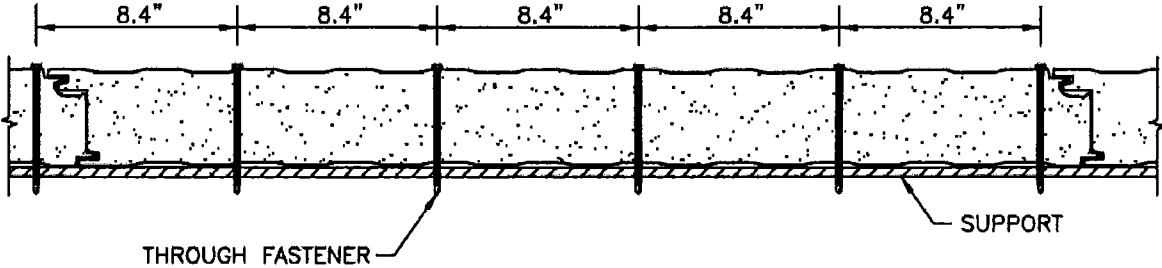

FASTENER PATTERN FP10

FM APPROVALS

Wall Panel Attachment

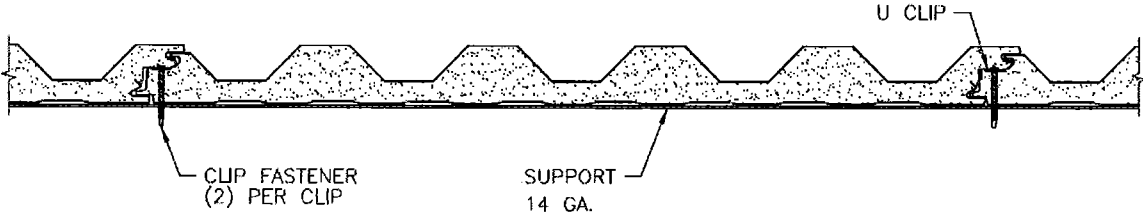

FASTENER PATTERN FP1

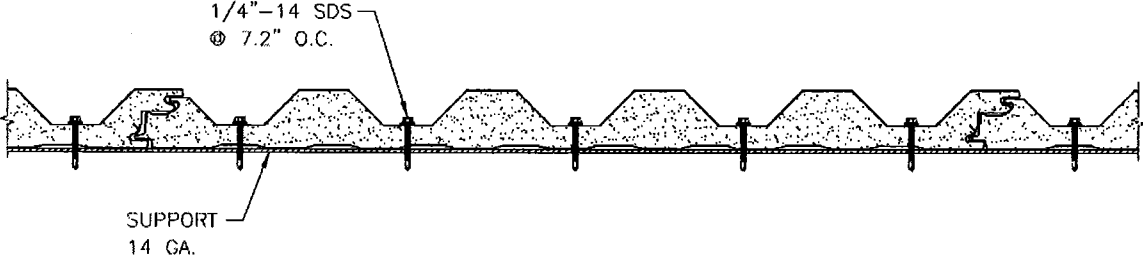

FASTENER PATTERN FP11