



* NOTE: $\frac{1}{4}$ " CONTINUOUS BEAD
IN BOTH FEMALE GROOVES

4" X $\frac{3}{4}$ " - 14 GA.
4 HOLE CF CLIP
[4633GNC]

#14 CLIP FASTENER
(2) PER CLIP
(ADDITIONAL INTERIOR FASTENERS
MAY BE REQUIRED BASED ON
NEGATIVE WIND PRESSURES)

(SEE FASTENER SHEET-
"2FSTN-01A" THROUGH
"2FSTN-01D" FOR
FASTENING APPLICATION)

BUTYL *

BUTYL *

MODULE

REVEAL
 $\frac{1}{4}$ "
 $\frac{1}{2}$ "
1"
 $\frac{3}{4}$ "
 $1\frac{1}{2}$ "
 2 "
 $2\frac{1}{2}$ "
3"

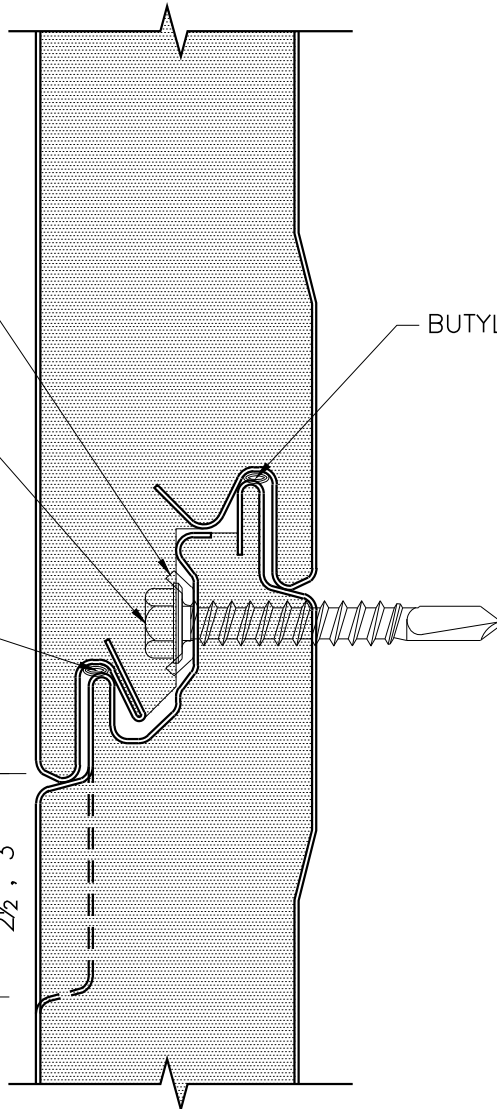

REFER TO SHEET "CI-INFO" FOR ADDITIONAL INFORMATION REGARDING THE
APPLICATION OF SEALANTS, FASTENERS, AND CLOSURE MATERIALS.
CONSULT METL-SPAN TO DETERMINE ALLOWABLE LOAD AND SPACING OF ATTACHMENT FASTENERS.

COMMERCIAL AND
INDUSTRIAL

SIDE JOINT ATTACHMENT DETAIL
HORIZONTAL INSTALLATION

© 2016 Metl-Span, an NCI Building Systems company. All rights reserved.

2H-JT-01

DATE: Nov. 9, 2016