

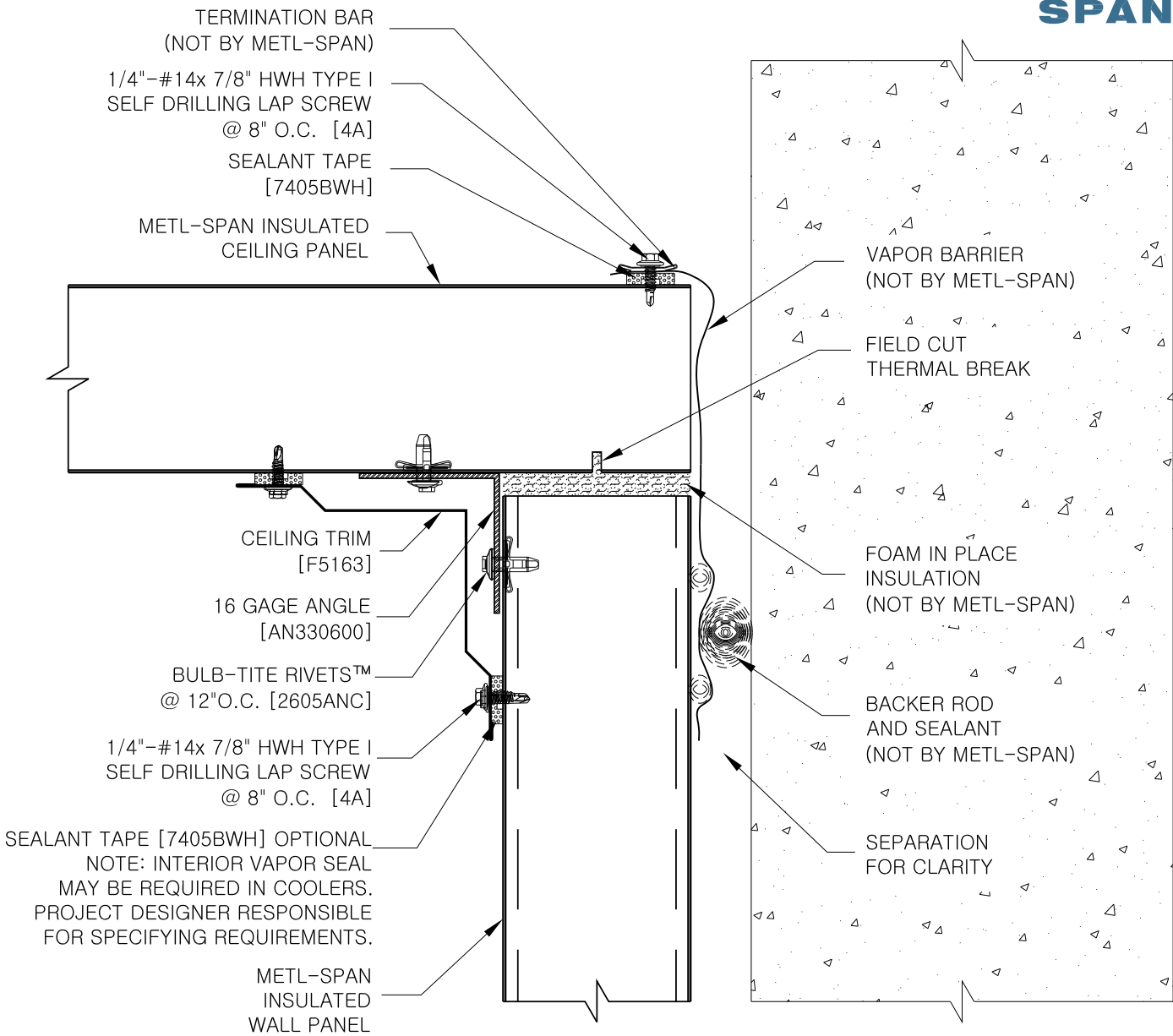

(SPACE ABOVE CEILING MUST BE VENTILATED.)



DEPENDING ON PANEL SPAN AND SUPPORT SYSTEM, 16 GA ANGLE
MAY BE REQUIRED TO BE SUPPORTED BY ROOF STEEL, METHOD
OF SUPPORT NOT BY METL-SPAN.

NOTE: ALL CEILING SUPPORT COMPONENTS AND PANELS MUST BE
INSTALLED COMPLETE PRIOR TO ALLOWING ANY TRAFFIC ON CEILING.

NOTE: REFER TO SHEET "CS-INFO" FOR ADDITIONAL INFORMATION REGARDING THE
APPLICATION OF SEALANTS, FASTENERS AND CLOSURE MATERIALS. CONSULT METL-SPAN TO
DETERMINE ALLOWABLE LOAD AND SPACING OF ATTACHMENT.

FREEZER OR COOLER

CEILING SUPPORT DETAIL

CS-CG-10

DATE: April 4, 2017