

1/4" UNIFORMED BEAD OF BUTYL SEALANT MUST BE APPLIED TO THE FEMALE GROOVE ON THE WARM SIDE OF PANEL OR AS SPECIFIED PER JOB REQUIREMENTS

CF-42 FLUTE/MESA OR LIGHT MESA

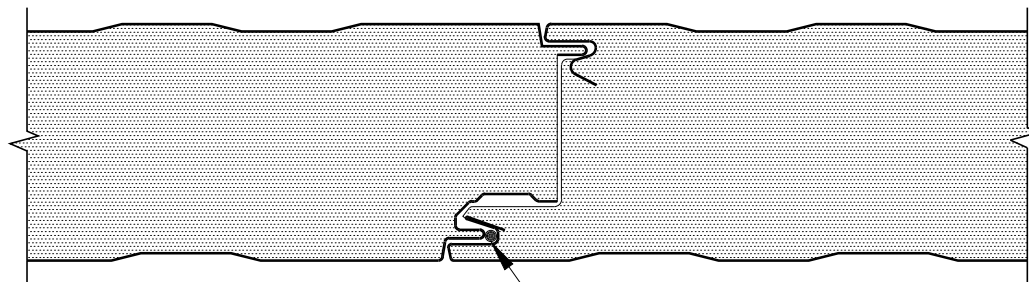

1/4" UNIFORMED BEAD OF BUTYL SEALANT MUST BE APPLIED TO THE FEMALE GROOVE ON THE WARM SIDE OF PANEL OR AS SPECIFIED PER JOB REQUIREMENTS

**CF-42, CF-36, CF-30
MESA/MESA OR
LIGHT MESA/LIGHT MESA**

CF PANEL JOINT DETAILS

**APPLICATION:
FREEZER OR COOLER**

CS-JT-01

DATE: Nov. 9, 2016