

Horizontal Panel-Corner Detail
(Square Cut Panels)

- Notes:
1. Interior perimeter sealants may be omitted for specific applications, subject to the project's design and operational requirements.
 2. Fire protection of the corner structural may be required, subject to the project's building code requirements. Fire protection of the structural members is not by Metl-Span.
 3. *Screw type is subject to the corner structural material and the panel thickness.
 4. To conform to the requirements of the ASTM E119 fire resistance rating, the filler insulation must have an approved classification marking for surface burning characteristics or fire resistance.
 5. Optional reveal is recommended for the wide flashing required for thicker panels.

HORIZONTAL CORNER DETAIL

APPLICATION:
COOLER/FREEZER

TCS-HC-01

MSS035.920
20 AUG 04

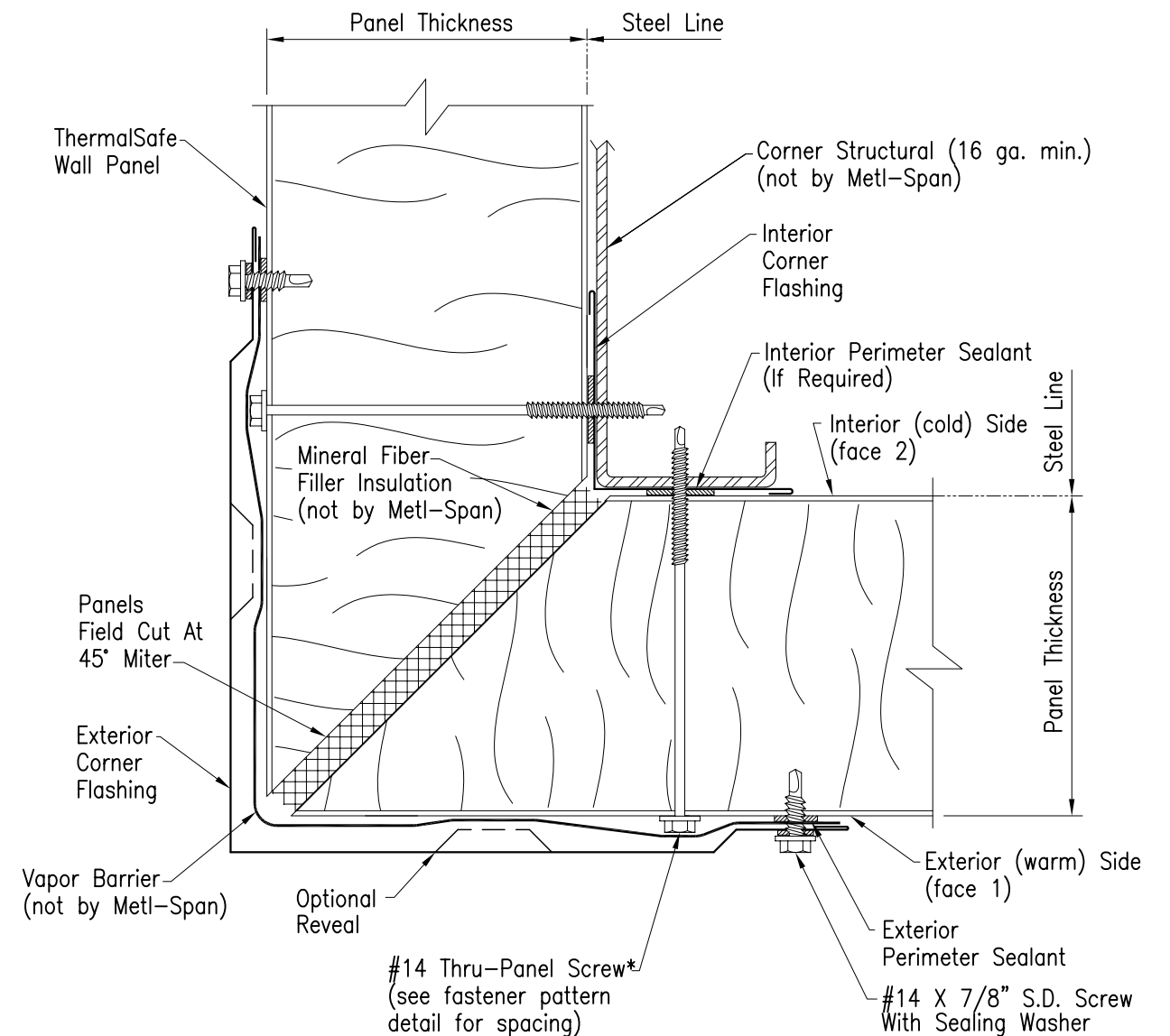

Horizontal Panel-Corner Detail
(Mitered Panels)

- Notes:
1. Interior perimeter sealants may be omitted for specific applications, subject to the project's design and operational requirements.
 2. Fire protection of the corner structural may be required, subject to the project's building code requirements. Fire protection of the structural members is not by Metl-Span.
 3. *Screw type is subject to the corner structural material and the panel thickness.
 4. To conform to the requirements of the ASTM E119 fire resistance rating, the filler insulation must have an approved classification marking for surface burning characteristics or fire resistance.
 5. Optional reveal is recommended for the wide flashing required for thicker panels.

HORIZONTAL CORNER DETAIL

APPLICATION:
COOLER/FREEZER

TCS-HC-02

MSS035.921
20 AUG 04