

SS #14x 7/8" HWH TEK I
SELF DRILLING LAP SCREW [4]
W/BN-STAINLESS STEEL CAP
@ 8" O.C.

SEALANT TAPE
[7405BWH]

42" RIDGE CLOSURE

CLIP SEALANT
[7412BWH]

METL-SPAN CFR
INSULATED ROOF PANEL

2" CFR PANEL CLIP
@ EACH PANEL SIDELAP
[SEE CHART]

#14 CLIP FASTENER
(3) PER CLIP [SEE CHART]
FOR MEMBERS 12 GA OR HEAVIER
ONLY 2 FASTENERS PER CLIP

CONTINUOUS BUTYL SEALANT
[7100BWH] WITH MARRIAGE
BEAD TO PANEL JOINT

#14 CLIP FASTENER
(2) PER CLIP [SEE CHART]

4" X 3/4" - 14 GA.
4 HOLE CF CLIP
[4633GNC]

EAVE SUPPORT
(NOT BY METL-SPAN)

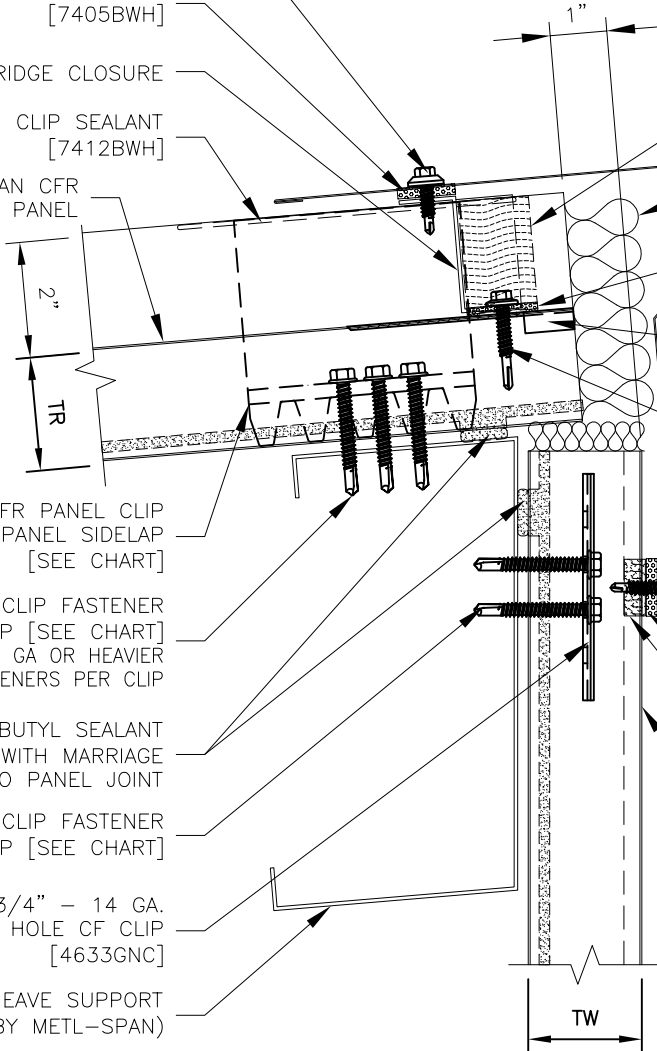

END LAP SEALANT
TAPE [7403BWH]
(SEE INSTALLATION GUIDE)

LOOSE FILL INSULATION
(NOT BY METL-SPAN)

END LAP SEALANT
TAPE [7403BWH]

BACK-UP PLATE FACTORY
INSTALLED @ EACH HIGH
MESA, 4" O.C. [4211GNC]

#14 X 1-1/2" HWH TEK II,
W/OUT WASHER @ EACH
BACK-UP PLATE 4" O.C. [1E]

HIGH EAVE TRIM
[SEE CHART]

#14x 7/8" HWH TEK I
SELF DRILLING LAP
SCREW @ 8" O.C. [4A]

SEALANT TAPE
[7405BWH]

FLUTE PLUG STRIP [7607UGR]
(1) PER PANEL (IF REQUIRED)

METL-SPAN
INSULATED PANEL

REFER TO SHEET "CHNFO" FOR ADDITIONAL INFORMATION REGARDING THE APPLICATION OF SEALANTS, FASTENERS, AND CLOSURE MATERIALS. CONSULT METL-SPAN TO DETERMINE ALLOWABLE LOAD AND SPACING OF ATTACHMENT FASTENERS.

ROOF PANEL WIDTH	RIDGE CLOSURE
CFR-42 (3'-6" WIDE)	7900GBK
CFR-36 (3'-0" WIDE)	7902GBK
CFR-30 (2'-6" WIDE)	7901GBK

ROOF THICKNESS TR	HIGH EAVE TRIM	ROOF CLIP	ROOF CLIP FASTENER TEK III	ROOF CLIP FASTENER TEK V	ROOF CLIP FASTENER TYPE B	WALL THICKNESS TW	WALL CLIP FASTENER TEK III	WALL CLIP FASTENER TEK V	WALL CLIP FASTENER TYPE B
2"	F3340	4102GNC	1616PNC	1724PNC	1816PNC	2"	1616PNC	1724PNC	1816PNC
2.5"	F3340	4125GNC	1616PNC	1724PNC	1816PNC	2.5"	1624PNC	1732PNC	1824PNC
3"	F3340	4103GNC	1616PNC	1724PNC	1816PNC	3"	1624PNC	1732PNC	1824PNC
4"	F3341	4104GNC	1616PNC	1724PNC	1816PNC	4"	1632PNC	1740PNC	1832PNC
5"	F3341	4105GNC	1616PNC	1724PNC	1816PNC	5"	1640PNC	1748PNC	1840PNC
6"	F3342	4106GNC	1616PNC	1724PNC	1816PNC	6"	1648PNC	1756PNC	1848PNC

COMMERCIAL AND INDUSTRIAL

CFR HIGH EAVE DETAIL

CI-CFR-EV-02