

- ① SET PANEL IN PLACE
- ② INSTALL CFR CLIP W/BUTYL TAPE SEALANT
- ③ SECURE TO PURLINS W/ 1/4" HEX HEAD FASTENERS

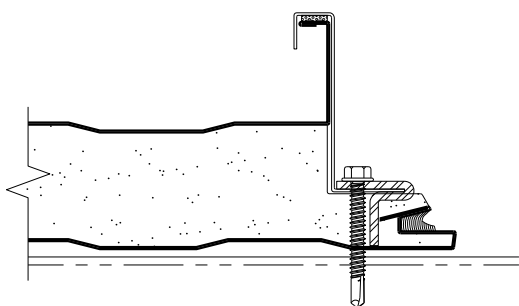

- ④ HAND "CRIMP" THE STANDING RIB/ CLIP ASSEMBLY AT EACH CLIP LOCATION
- ⑤ INSTALL CONTINUOUS BUTYL TAPE SEALANT ON TOP OF MALE STANDING SEAM

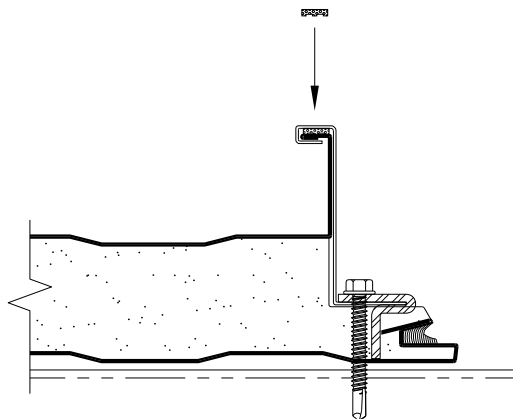

- ⑥ TILT NEXT PANEL TO BE INSTALLED AT 45 DEGREE ANGLE. ROTATE INTO POSITION.

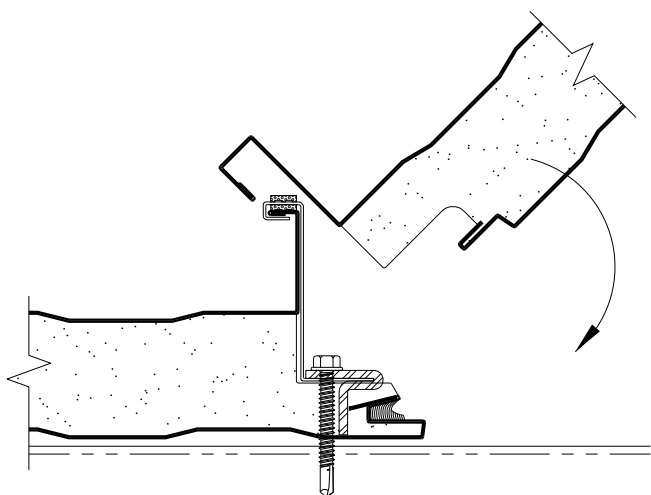

- ⑦ USE CLAMPS TO ENSURE PROPER PANEL ENGAGEMENT
- ⑧ HAND CRIMP AT RIDGE, ENDLAP AND EAVES
- ⑨ INSTALL RIDGE, RAKE AND EAVE COMPONENTS, THEN MECHANICALLY SEAM ROOF

