

Metl-Span ThermalSafe Through Fastened Wall Panels
26 Ga. Exterior / 26 Ga. Interior Facings
Allowable Span for Inward or Outward Load of 10 PSF

Thickness (in)	Design Criteria			Allowable Span (ft)
	Bending Stress	Shear Stress	Deflection Limit	
4"	21.7	40.0	19.8	19.8
5"	24.3	46.9	22.9	22.9
6"	26.5	52.3	25.7	25.7
7" & 8"	28.5	56.5	28.1	28.1

- Based on ThermalSafe panel with 26 Ga. exterior & 26 Ga. interior face (min Fy = 33 ksi) for single span condition.
- Allowable span is the lowest value of panel bending strength, shear strength, deflection limit and connection strength.
- The spans based on panel stress and deflection design criteria are derived from ASTM E-72 structural testing. The allowable loads are calculated with a factor of safety of 2.5 and 3.0 for bending and shear stresses, respectively, and deflection limitation of L/240.
- The connection strengths are derived from ASTM E-72 structural testing and the allowable loads are calculated with a factor of safety of 2.5.
- Based on attachment with 14 Ga. steel girt with fastener spacing 3"-18"-18"-3" across panel width.
- The structural capacity of the girts are not considered and must be examined independently.

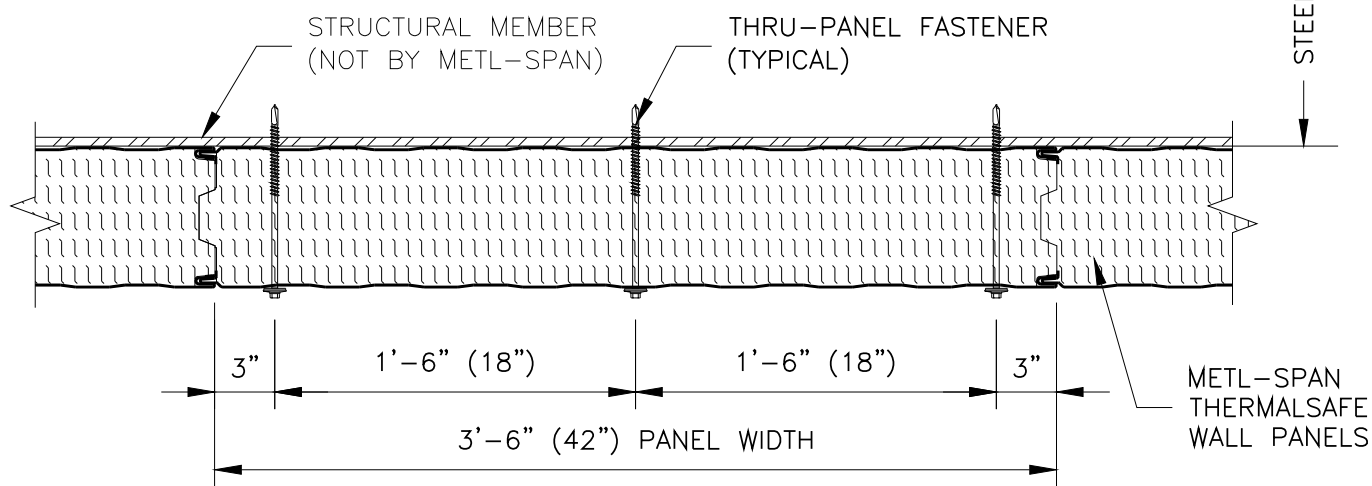

END CONDITION

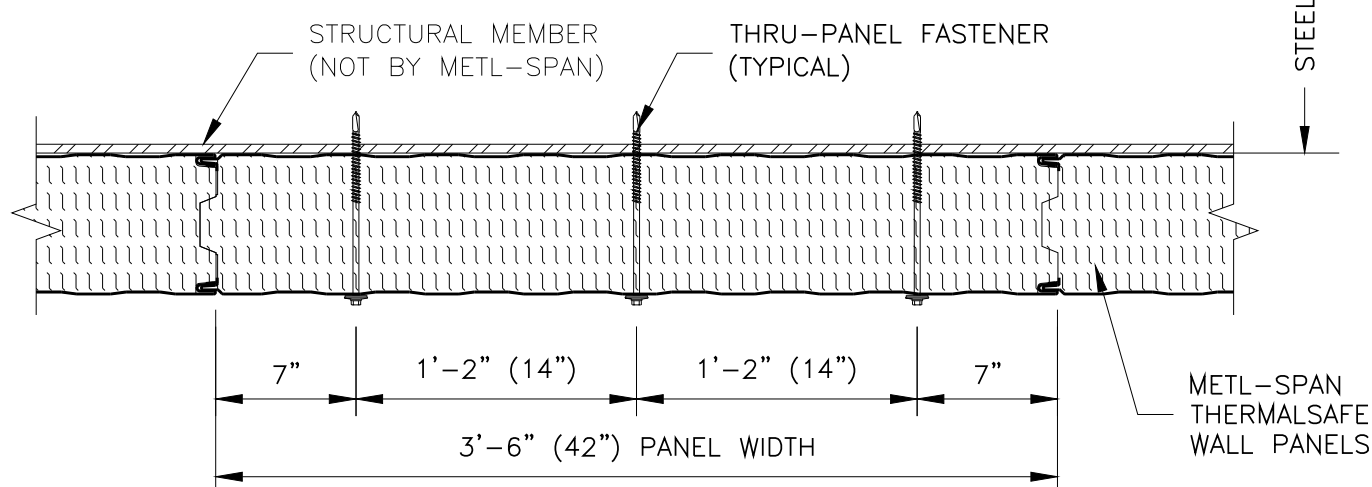

INTERMEDIATE CONDITION

VERTICAL PANEL – THRU PANEL FASTENER PATTERNS
TSFP1

NOTE: FASTENER PATTERN TO BE DETERMINED PER SPECIFIC PROJECT DESIGN REQUIREMENTS.

<p>COMMERCIAL AND INDUSTRIAL</p>	<p>FASTENER PATTERNS TSFP1 THERMALS SAFE PANEL</p>	<p>TSW03010 DATE: 01-12-2016</p>
----------------------------------	--	--------------------------------------

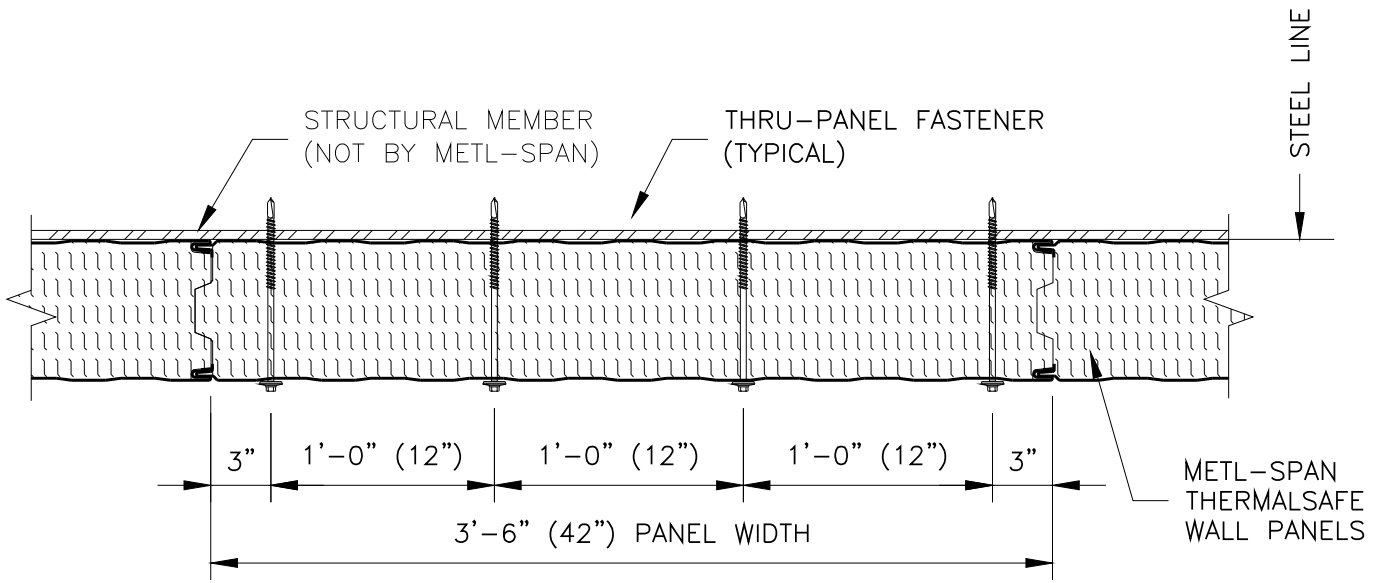

END CONDITION

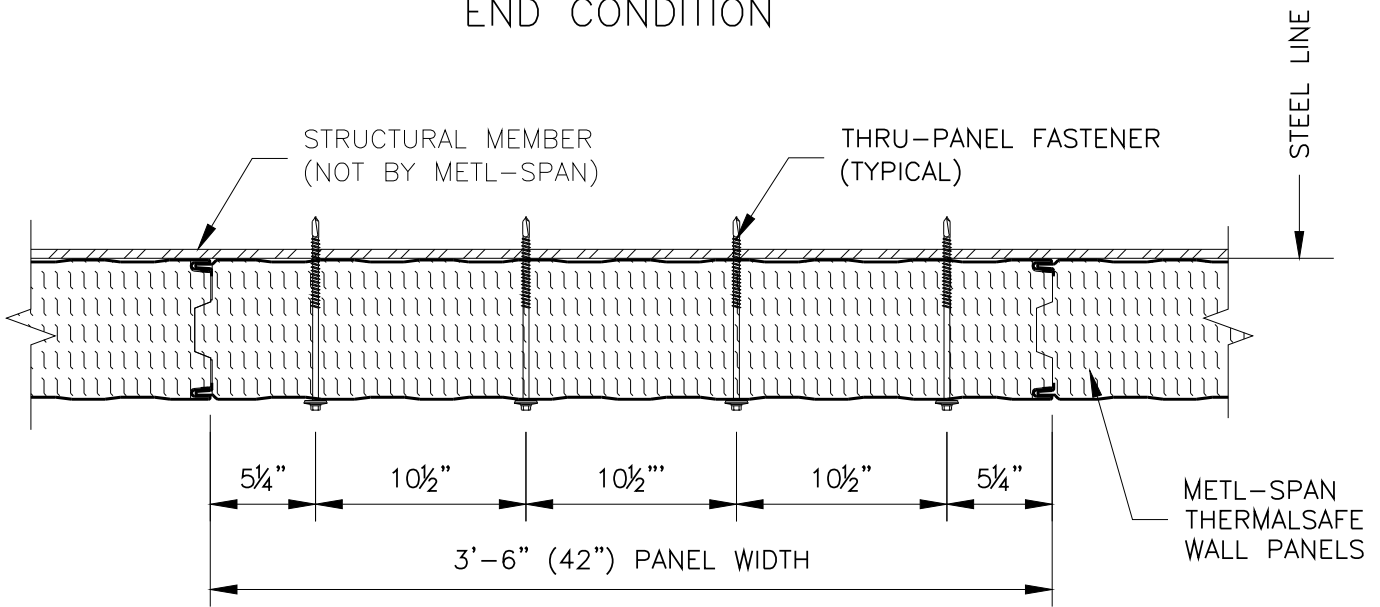

INTERMEDIATE CONDITION

VERTICAL PANEL – THRU PANEL FASTENER PATTERNS
TSFP2

NOTE: FASTENER PATTERN TO BE DETERMINED PER SPECIFIC PROJECT DESIGN REQUIREMENTS.

COMMERCIAL AND
INDUSTRIAL

FASTENER PATTERNS TSFP2
THERMALSAFE PANEL

TSW03011
DATE: 01-12-2016