

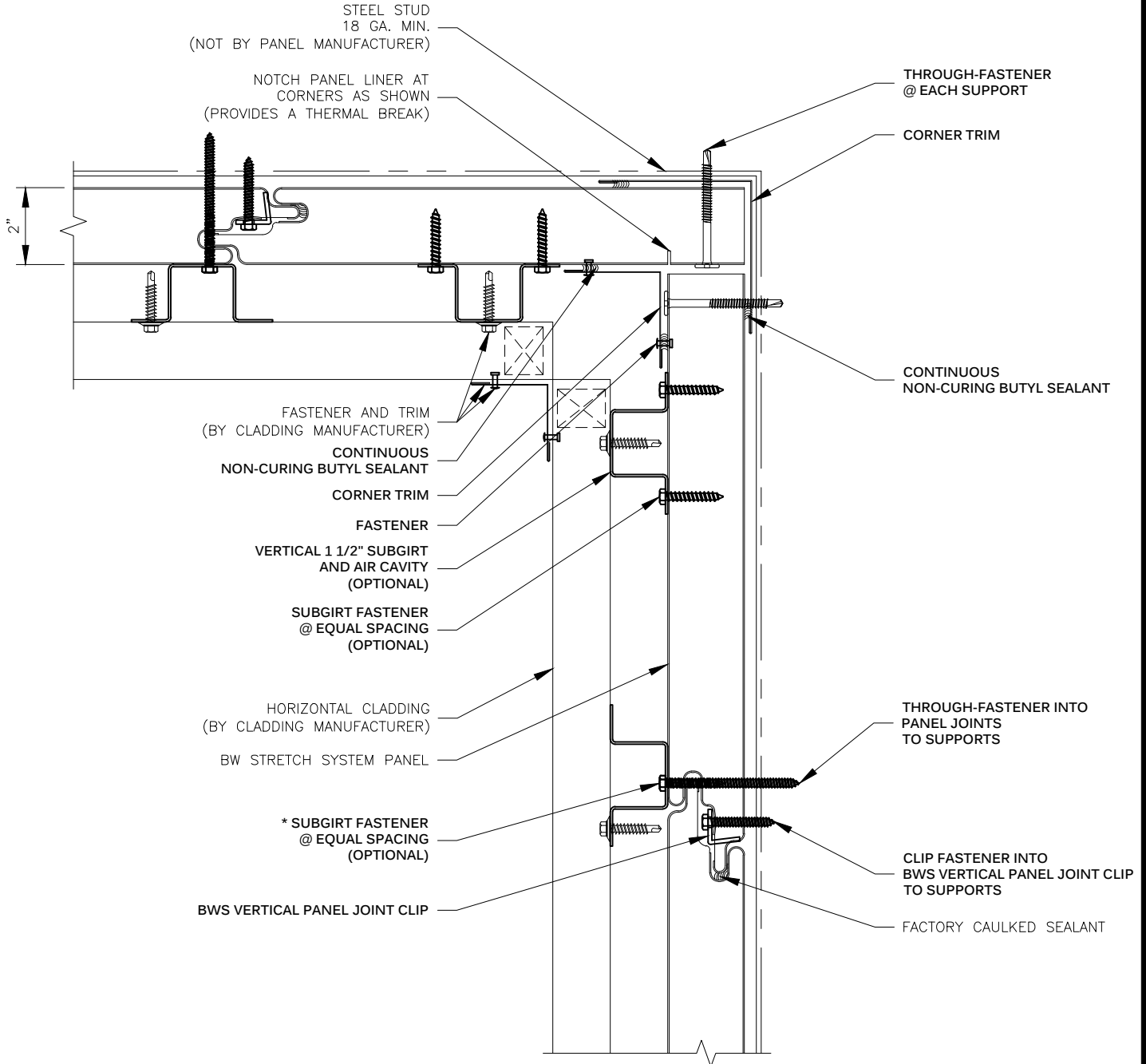

METL-SPAN[®]
INSULATED METAL PANELS

NOTE:
THESE DETAILS ARE FOR INSTALLATION AND SEALING OF BW UNIVERSAL SYSTEM PANELS ONLY. FOR INSTALLATION AND SEALING REQUIRED FOR CLADDING, SEE STANDARD DETAILS FOR SPECIFIC CLADDING.

*EQUAL SPACINGS TO BE 12" MIN./24" MAX. FINAL SPACINGS PER WIND LOAD REQUIREMENTS. CONTACT METL-SPAN'S ENGINEERING DEPARTMENT.



**VERTICAL PANEL JOINT CLIP
INSIDE CORNER - w/ VERTICAL SUBGIRT
BW STRETCH SYSTEM™**

DRAWING NO:

BWS-VPJC-VS-CE-01A

DATE:

Mar '20

REV:

00