

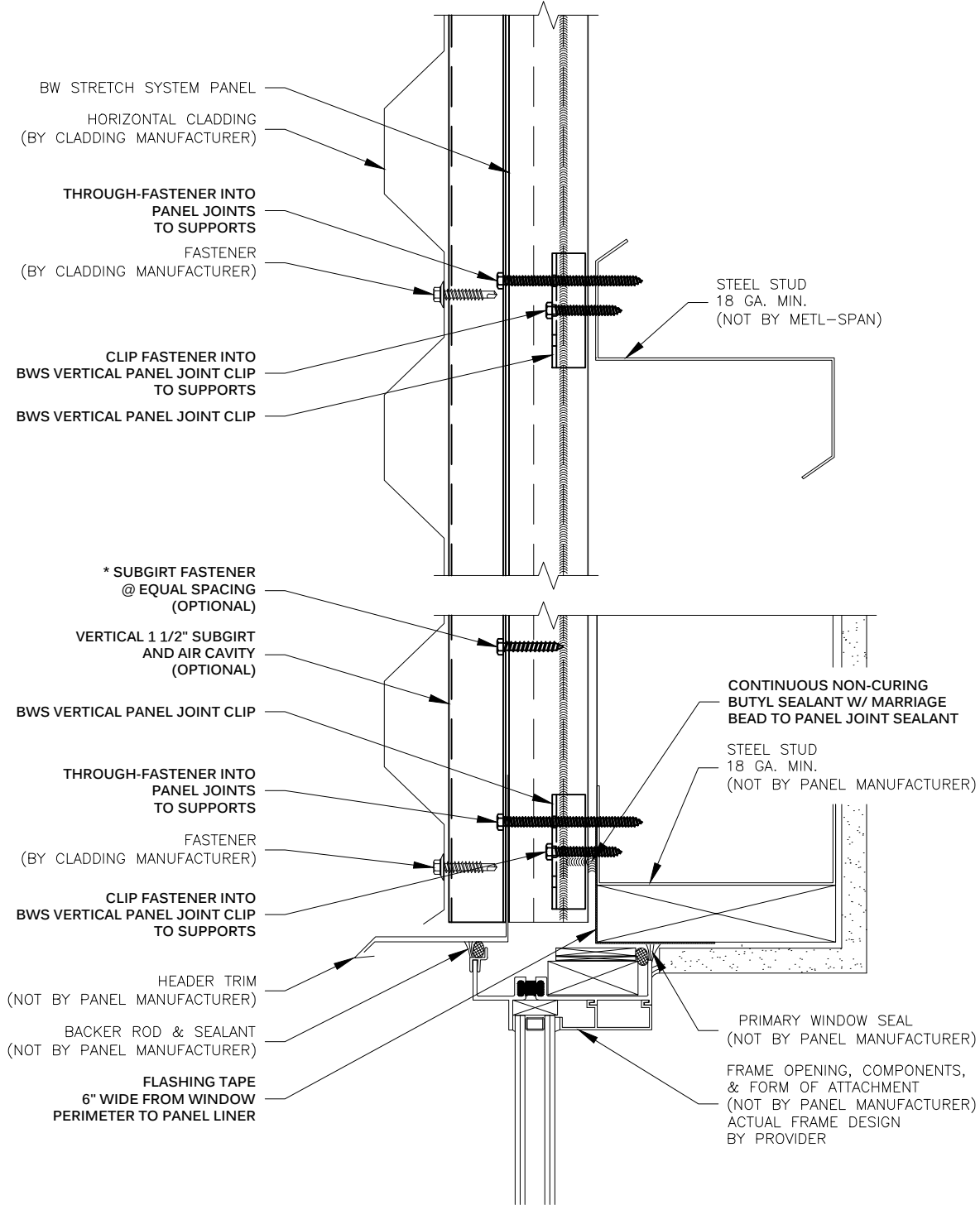

**METL-SPAN**<sup>®</sup>  
INSULATED METAL PANELS

**NOTE:**  
THESE DETAILS ARE FOR INSTALLATION AND SEALING  
OF BW UNIVERSAL SYSTEM PANELS ONLY. FOR  
INSTALLATION AND SEALING REQUIRED FOR CLADDING,  
SEE STANDARD DETAILS FOR SPECIFIC CLADDING.

\*EQUAL SPACINGS TO BE 12" MIN./24" MAX. FINAL  
SPACINGS PER WIND LOAD REQUIREMENTS. CONTACT  
METL-SPAN'S ENGINEERING DEPARTMENT.



**VERTICAL PANEL JOINT CLIP  
HEADER - w/ VERTICAL SUBGIRT  
BW STRETCH SYSTEM<sup>™</sup>**

DRAWING NO:

**BWS-VPJC-VS-HD-01**

DATE:

Mar '20

REV:

00