

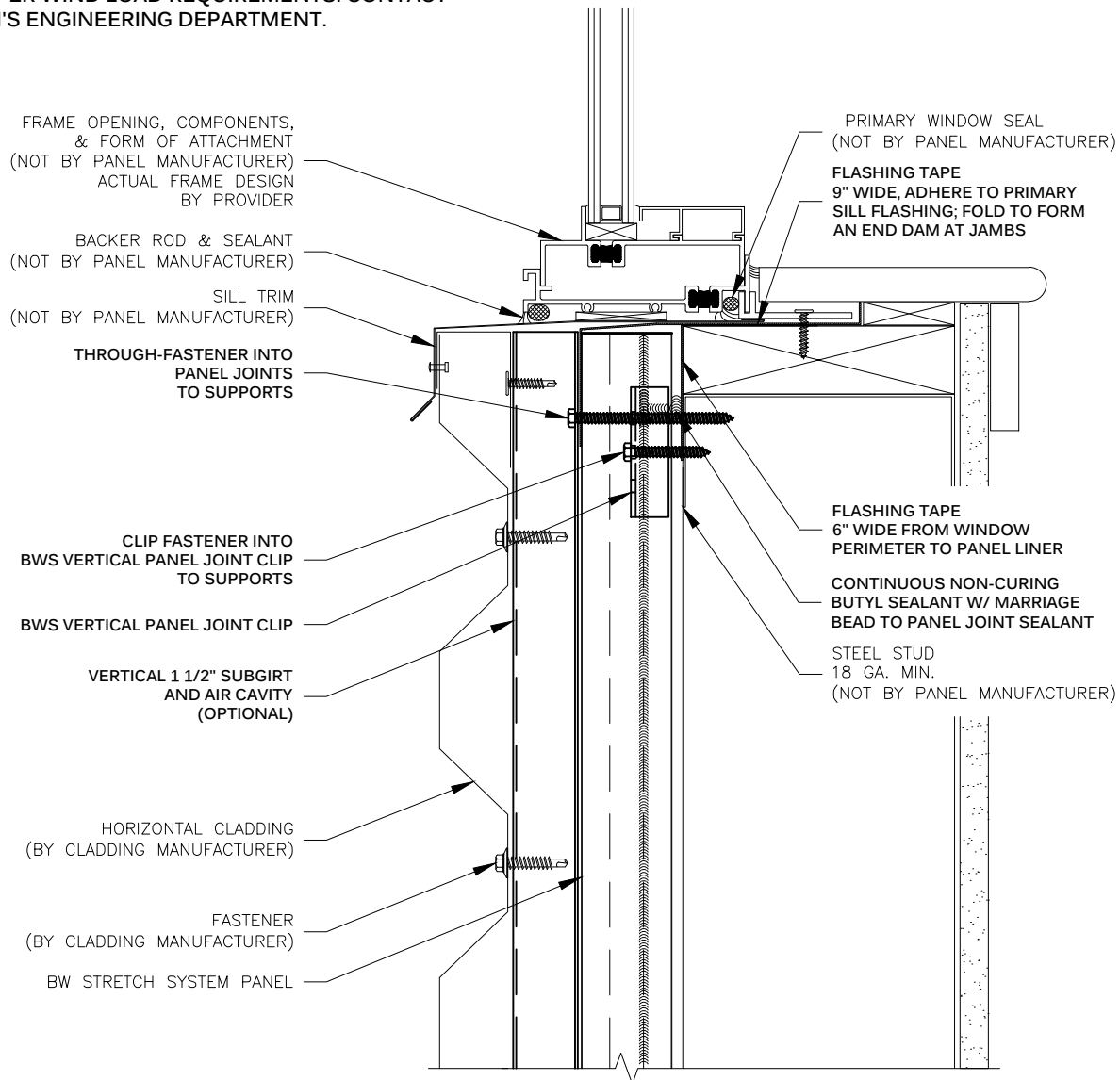

METL-SPAN®
INSULATED METAL PANELS

NOTE:
THESE DETAILS ARE FOR INSTALLATION AND SEALING
OF BW UNIVERSAL SYSTEM PANELS ONLY. FOR
INSTALLATION AND SEALING REQUIRED FOR CLADDING,
SEE STANDARD DETAILS FOR SPECIFIC CLADDING.

***EQUAL SPACINGS TO BE 12" MIN./24" MAX. FINAL
SPACINGS PER WIND LOAD REQUIREMENTS. CONTACT
METL-SPAN'S ENGINEERING DEPARTMENT.**



**VERTICAL PANEL JOINT CLIP
SILL - w/ VERTICAL SUBGIRT
BW STRETCH SYSTEM™**

DRAWING NO:

BWS-VPJC-VS-SL-01

DATE:

Mar '20

REV:

00