

## IW Wall Panel Allowable Wind Loads (psf) - All Profiles

WITHOUT Negative Load Clips						
Panel Gauge	Span (Single/Double/Triple)					
	1'-4"	2'-0"	2'-8"	4'-0"	5'-0"	7'-6"
22 Gauge	24 g	24 g	See Note #4			
20 Gauge	27 g	27 g	27 g	27 g	27 g	See Note #4
18 Gauge	54 g	54 g	54 g	48 g	46 g	See Note #4

WITH Negative Load Clips (NLC-1)						
Panel Gauge	Span (Single/Double/Triple)					
	1'-4"	2'-0"	2'-8"	4'-0"	5'-0"	7'-6"
22 Gauge	73 g	65 g	52 g	31 g	24 g	24 g
20 Gauge	58 g	53 g	49 g	40 g	33 g	33 g
18 Gauge	161 g	161 g	135 g	81 g	75 g	41 f

### NOTES:

- Allowable loads are based on uniform span lengths.
- Panel material is ASTM A653 structural steel (SS) Grade 37.
- Failure modes represented are:
  - f = fastener pullout/pullover
  - b = bending
  - d = deflection
  - g = panel disengagement
- Use of IW panels without NLC-1 clips at the referenced gauge and span combinations is not recommended.
- When used, one (1) NLC-1 clip is required at the center of each span for spans up to 4'-0" and two (2) NLC-1 clips are required at third points for spans greater than 4'-0".
- NLC-1 clips are attached to the panel with one (1) 3/16"-diameter, dome head, open end, zinc-plated, carbon steel body & mandrel rivet (SD62BS).
- Panel properties are calculated per AISI Standard *North American Specification for the Design of Cold-Formed Steel Structural Members* - 2016 Edition and the provisions for Allowable Strength Design (ASD).
- Fastening limitations are based on nominal 1/4" fasteners with 15mm-diameter combination washers; minimum one (1) fastener per girt; and minimum 16 Gauge (50 ksi) steel structural girts. Allowable pullout/pullover reactions are based on fastener manufacturer test data with a safety factor of 2.5.
- Deflection is based on an effective moment of inertia at  $M_s = 0.6 * M_n$  applied to the weaker orientation; a deflection ratio of  $L/120$ ; and the 10-year mean return interval wind speed per IBC 2018 Table 1604.3.
- Allowable loads due to panel disengagement are based on large-scale testing with a safety factor of 2.0.
- Panel coverage = 12" and weight = 1.9-3.0 psf.
- Contact Metl-Span for conditions not conforming to these notes.

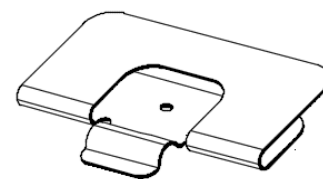
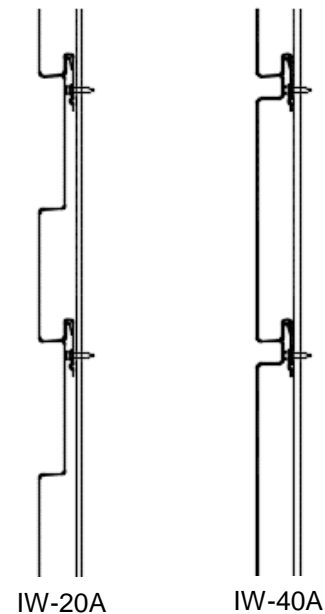
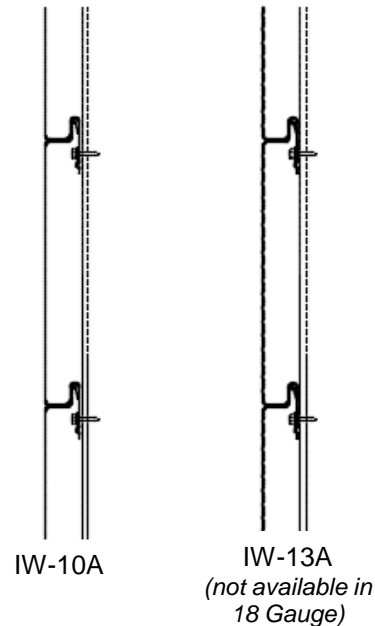

NLC-1