

# V6 X-SPAN CLIP

(REVERSIBLE)  
CF CLIP

# DISCLAIMER:

## COMMERCIAL & INDUSTRIAL

These details are based on industry accepted practices and provide a guideline for proper insulated metal panel and component installation.

The location of vapor barriers and associated sealants shown in these details is based on standard design practices for commercial industrial applications for most U.S. and Canadian climatic zones. The default vapor barrier location is on the warm side in winter (the interior side of the panels).

For projects located in extremely cold climates, exposed to high wind-driven rain or unusual interior conditions (sustained temperatures below 65°F), it may be advisable to modify the vapor barrier (joint sealant) location, or to add optional exterior joint sealants.

It is the sole responsibility of the project architect to verify vapor barrier location, insulation required by code and HVAC equipment/ventilation requirements to allow proper air flow and the prevention of condensation.

It is also the sole responsibility of the project architect to determine project-specific design loads. Metl-Span Technical Services is available to verify allowable panel spans and fastening requirements when provided with this information.

The details contained herein show side joint fastening only. Please contact Metl-Span technical services for project-specific fastening requirements.

All structural supports are shown for clarity only, and are not provided by Metl-Span.

# GENERAL:

## SEALANTS & FASTENERS

**Butyl caulk:** For commercial/industrial projects the caulk is usually applied to the interior joint female pocket (see DISCLAIMER). Butyl caulk is also used to create "marriage beads" which tie the panel sidejoint vapor seals to panel endjoint vapor seals. Butyl caulk is considered "non-skinning", which means it stays soft, flexible, and does not harden. Butyl caulk is for unexposed areas only, and cannot be used where it will be exposed to weather or sunlight

**Butyl sealant tape:** Applied between flashings and panels to form a weathertight seal. All fasteners penetrating the flashing must be inserted through the sealant tape.

**Urethane caulk:** Used in lieu of butyl sealant where there is exposure to the elements. It is recommended for lapped trims, exposed perimeter seals at framed openings or to seal between different construction materials, such as metal to concrete.

**Panel fasteners:** Insulated metal panel fasteners are generally either self-drilling/self-tapping (also known as TEK screws), or self-tapping (also known as B point screws).

**TEK Fasteners** contain a built-in drill point, and do not require pre-drilling. They are the quickest and easiest way to attach panels to light-medium gauge supports.

**B Point fasteners** require a two-step operation: First holes are pre-drilled into the panel and structural support with an appropriate sized bit, then the fastener is inserted into the hole and tightened. B points are typically used to attach panels to medium-heavy gauge supports that are not penetrable by TEK fasteners. It is important that the pre-drilled holes are sized correctly for the fasteners to achieve proper pullout values.

**Bulb-Tite® Rivets:** Are similar to expansion fasteners, and are used where back fastening of the panels to structural supports is required. Holes must be pre-drilled with a 5/16" diameter. The grip range of the rivets must be matched to the thickness of the structural support to ensure proper fastening.



**METL  
SPAN®**

INSULATED METAL PANELS

## INDEX:

CI-V6-CVR	COVER
CI-V6-INFO-01	DISCLAIMER: COMMERCIAL & INDUSTRIAL
CI-V6-INFO-02	GENERAL: SEALANTS & FASTENERS
CI-V6-INDEX	INDEX SHEET
CI-V6-4634GNC	V6 X-SPAN CLIP (REVERSIBLE) - PART DRAWING
CI-V6-JT-01	CF PANEL JOINT ASSEMBLY W/ V6 X-SPAN CLIP
CI-V6-JT-02	V6/V6+ X-SPAN ASSEMBLY ADVANTAGES
CI-V6-FSTN-01	V6 X-SPAN CLIP PANEL FASTENING ASSEMBLY
CI-V6-FSTN-02	V6+ X-SPAN (FACE-TO-CLIP) PANEL FASTENING ASSEMBLY
CI-V6-PA-01	V6 X-SPAN CLIP PANEL ATTACHMENT
CI-V6-PA-02	V6+ X-SPAN (FACE-TO-CLIP) PANEL ATTACHMENT
CI-V6-BE-01	V6 X-SPAN CLIP BASE
CI-V6-BE-02	V6+ X-SPAN (FACE-TO-CLIP) BASE
CI-V6-PA-03	V6/V6+ X-SPAN INTERMEDIATE PANEL ATTACHMENT
CI-V6-EA-01	V6 X-SPAN CLIP LOW EAVE
CI-V6-EA-02	V6+ X-SPAN (FACE-TO-CLIP) LOW EAVE





**METL  
SPAN®**  
INSULATED METAL PANELS

USE THIS FLANGE TO  
FASTEN PANELS AT  
INTERMEDIATE SUPPORTS

## V6 X-SPAN CLIP

(REVERSIBLE CF CLIP)  
[4634GNC]

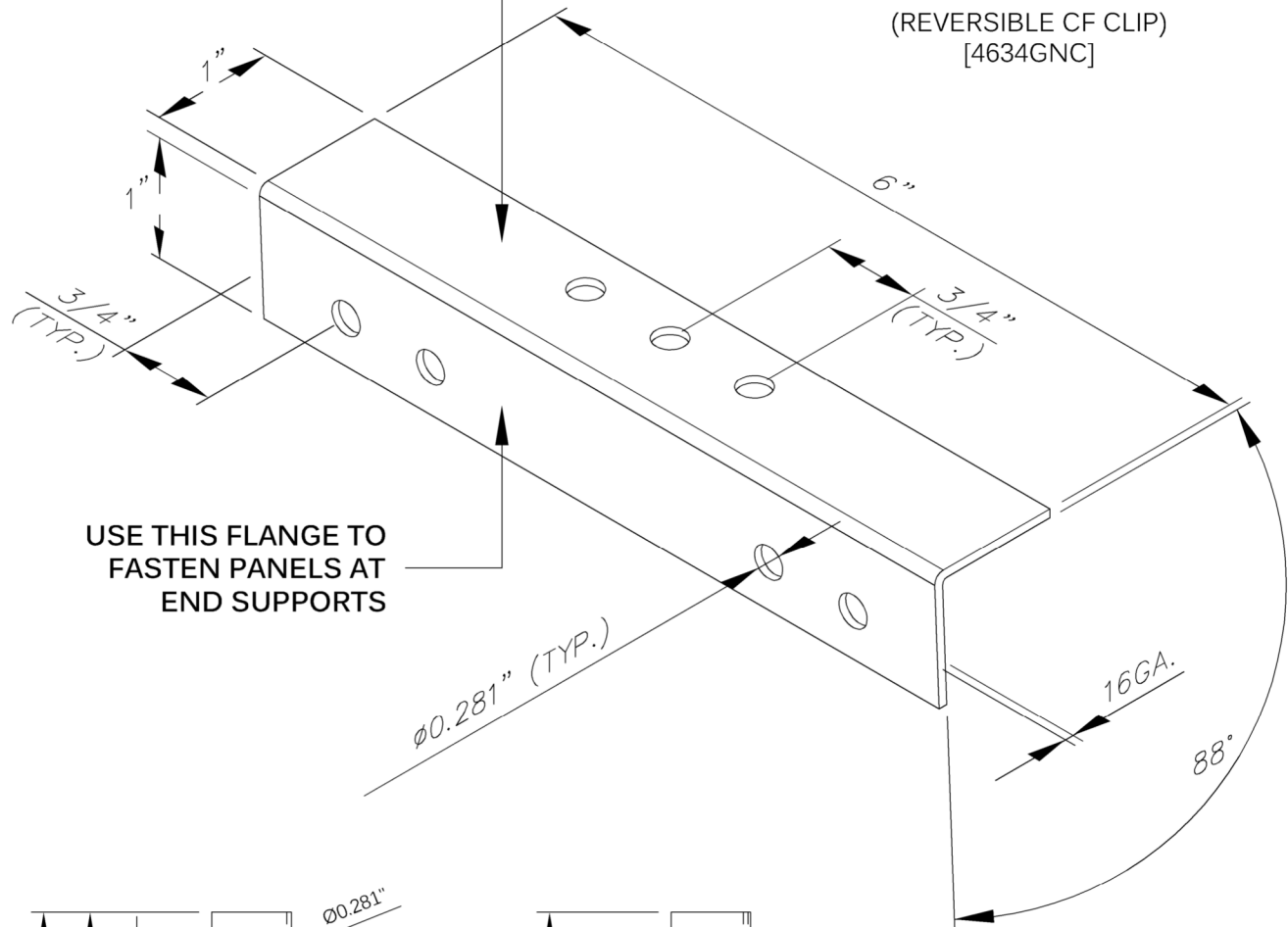

USE THIS FLANGE TO  
FASTEN PANELS AT  
END SUPPORTS

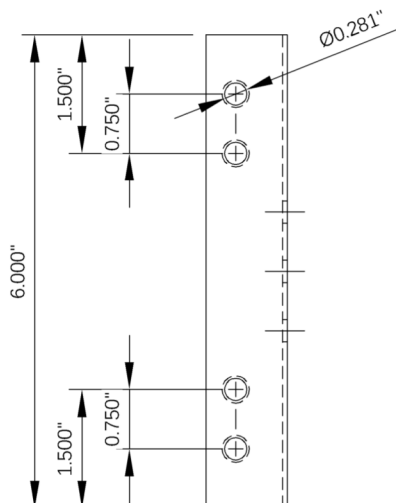

END SUPPORT

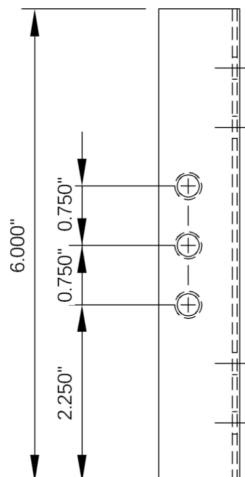

INTERMEDIATE SUPPORT

COMMERCIAL &  
INDUSTRIAL

V6 X-SPAN CLIP  
(REVERSIBLE)

DRAWING NO:

CI-V6-4634GNC

DATE:

JUL '22

REV:

00



**METL  
SPAN®**

INSULATED METAL PANELS

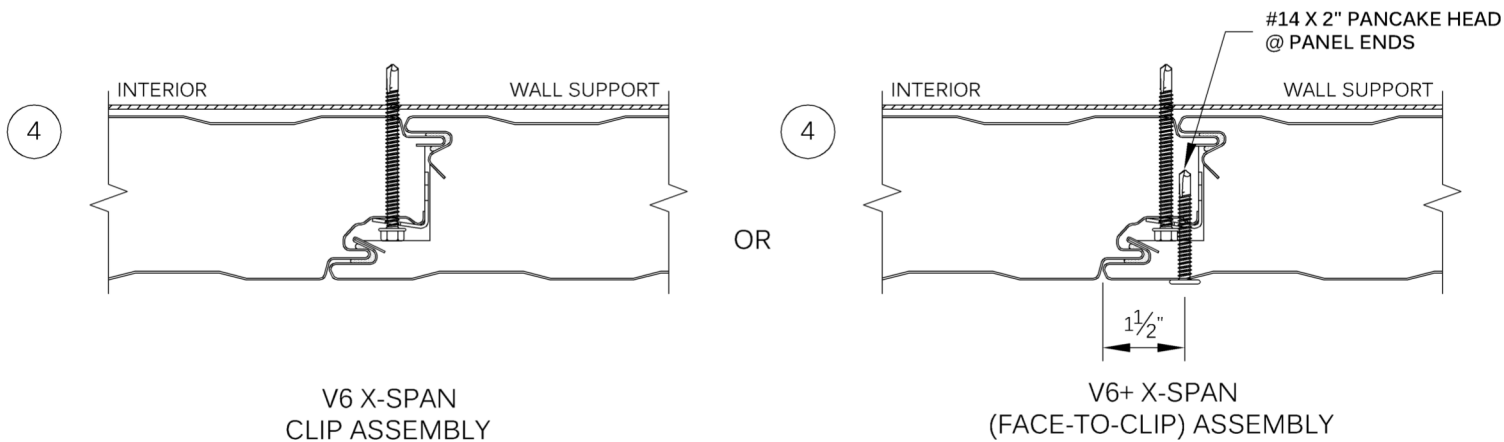
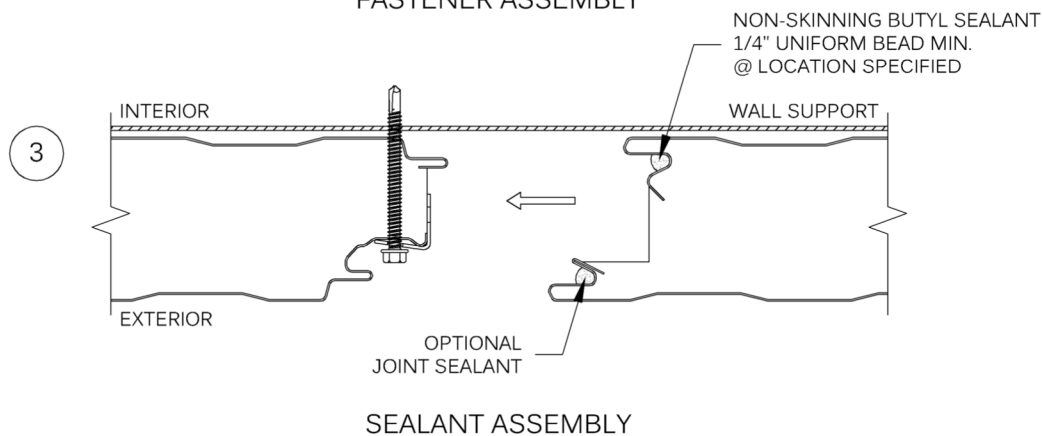
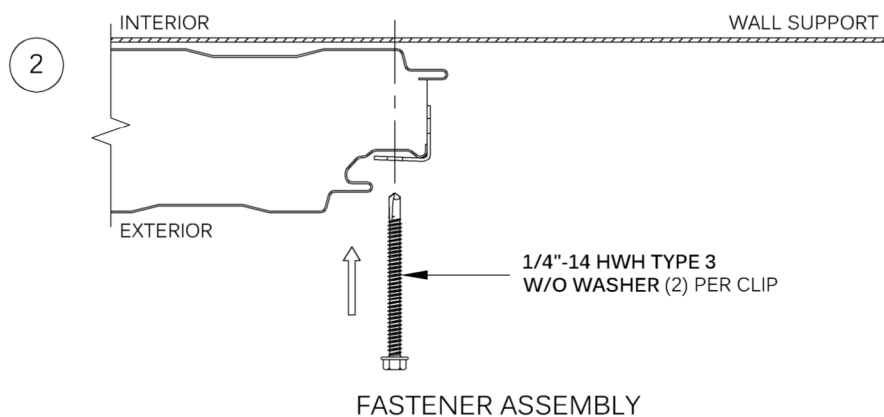
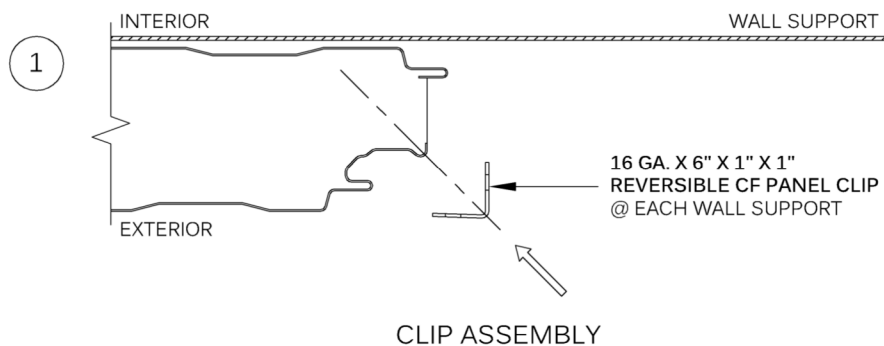

COMMERCIAL &  
INDUSTRIAL

CF PANEL JOINT ASSEMBLY  
W/ V6 X-SPAN CLIP

DRAWING NO:

CI-V6-JT-01

DATE:

JUL '22

REV:

00



**METL  
SPAN®**  
INSULATED METAL PANELS

## ADVANTAGES

### V6 X-SPAN

#### CLIP ASSEMBLY

- (2) CLIP FASTENERS PER PANEL IN LIEU OF UP TO (4) BACK FASTENERS AT EACH SUPPORT PER PANEL
- INSTALLERS ARE NO LONGER REQUIRED TO ACCESS PANEL FROM INTERIOR SIDE AFTER INSTALLATION
- LESS TIME AND FEWER RESOURCES REQUIRED

### V6+ X-SPAN

#### CLIP ASSEMBLY

(FACE-TO-CLIP FASTENER)

- (2) CLIP FASTENERS PER PANEL IN LIEU OF UP TO (4) BACK FASTENERS AT EACH SUPPORT PER PANEL
- INSTALLERS ARE NO LONGER REQUIRED TO ACCESS PANEL FROM INTERIOR SIDE AFTER INSTALLATION
- LESS TIME AND FEWER RESOURCES REQUIRED
- TIES FEMALE FACE TO MALE CLIP SUPPORT
- PAN HEAD DELAYS PULLOVER UNDER NEGATIVE LOAD
- MASKED BY TRIM AT PANEL ENDS
- NO THERMAL BRIDGE
- NO PENETRATION OF LINER AIR/WATER BARRIER
- SAME FASTENER FOR ALL PANEL THICKNESSES

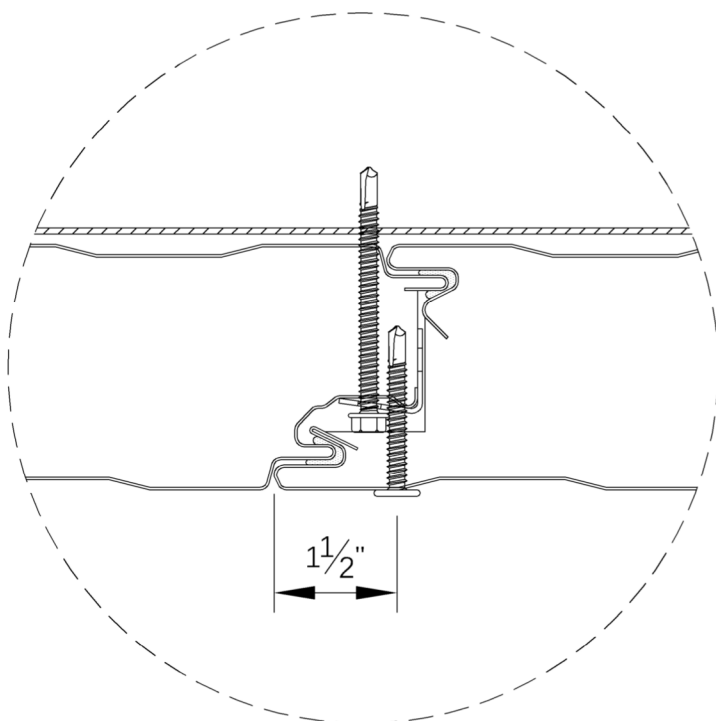
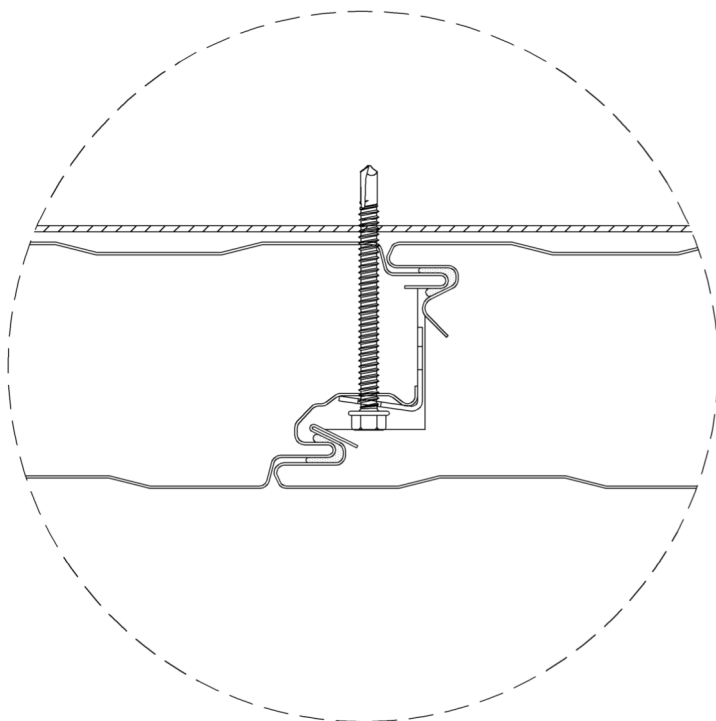

COMMERCIAL &  
INDUSTRIAL

V6/V6+ X-SPAN CLIP ASSEMBLY  
ADVANTAGES

DRAWING NO:

CI-V6-JT-02

DATE:

JUL '22

REV:

00



**METL-SPAN®**  
INSULATED METAL PANELS

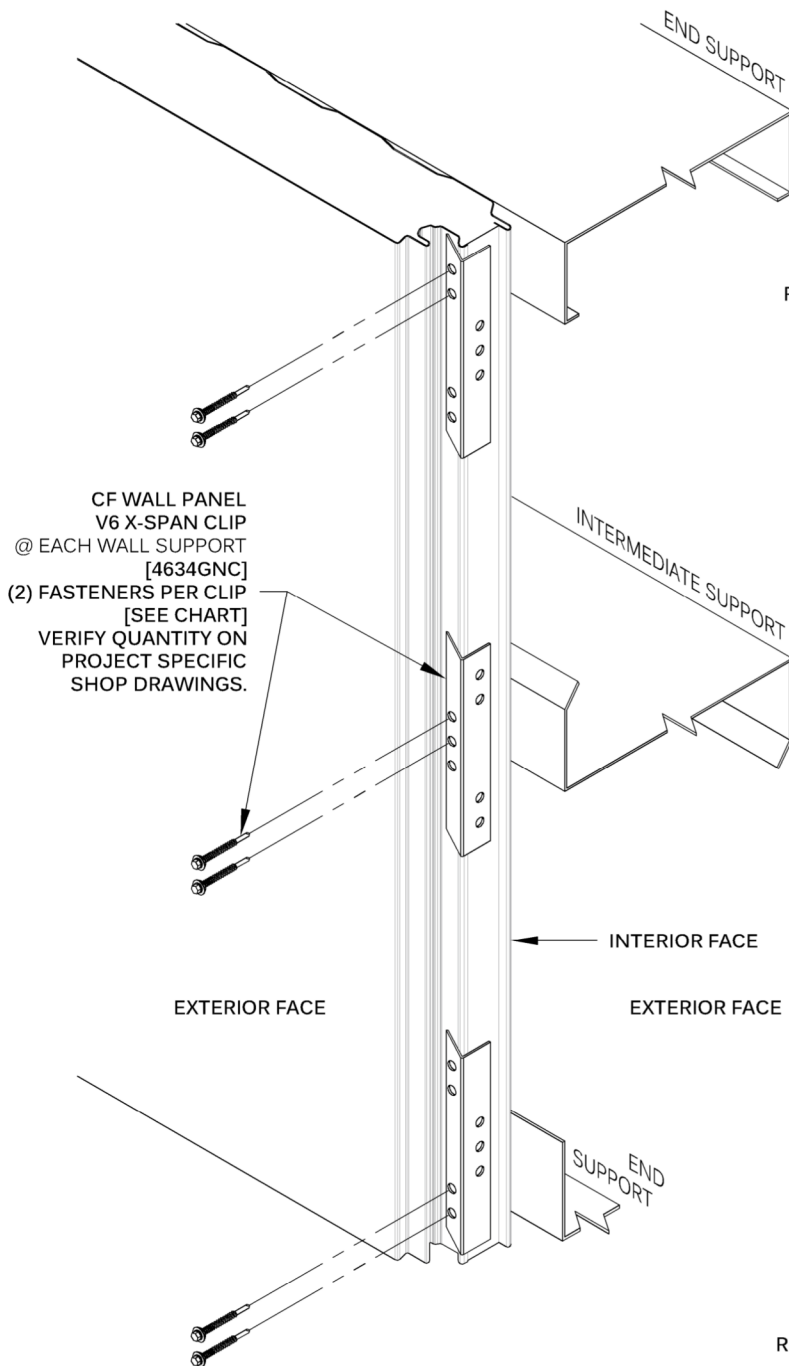

16 GA. X 6" X 1" X 1"  
REVERSIBLE CF PANEL CLIP  
@ EACH WALL SUPPORT  
[4634GNC]

TOP OF PANEL END  
ATTACHMENT

METL-SPAN  
INSULATED PANEL

1/4"-14 HWH TYPE 3  
W/O WASHER  
(2) PER CLIP  
[SEE CHART]

INTERMEDIATE  
ATTACHMENT

BOTTOM OF PANEL END  
ATTACHMENT

SUPPORT  
(NOT BY PANEL  
MANUFACTURER)

SUPPORT  
(NOT BY PANEL  
MANUFACTURER)

SUPPORT  
(NOT BY PANEL  
MANUFACTURER)

16 GA. X 6" X 1" X 1"  
REVERSIBLE CF PANEL CLIP  
@ EACH WALL SUPPORT  
[4634GNC]

1/4"-14 HWH TYPE 3  
W/O WASHER (2) PER CLIP  
[SEE CHART]

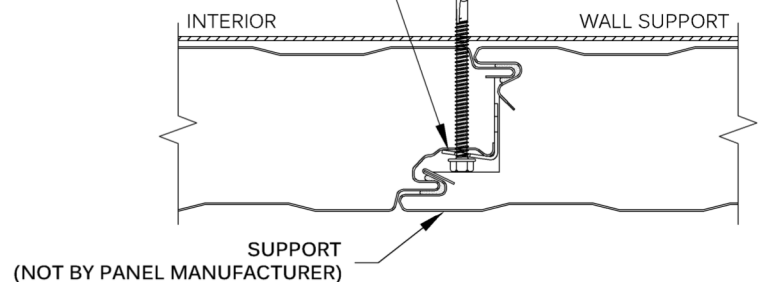

V6 X-SPAN  
CLIP ASSEMBLY

T	FASTENER
3"	1624PNC
4"	1632PNC
5"	1640PNC
6"	1648PNC
8"	1664PNC

COMMERCIAL &  
INDUSTRIAL

V6 X-SPAN CLIP  
PANEL FASTENING ASSEMBLY

DRAWING NO:

CI-V6-FSTN-01

DATE:

JUL '22

REV:

00



**METL-SPAN®**

INSULATED METAL PANELS

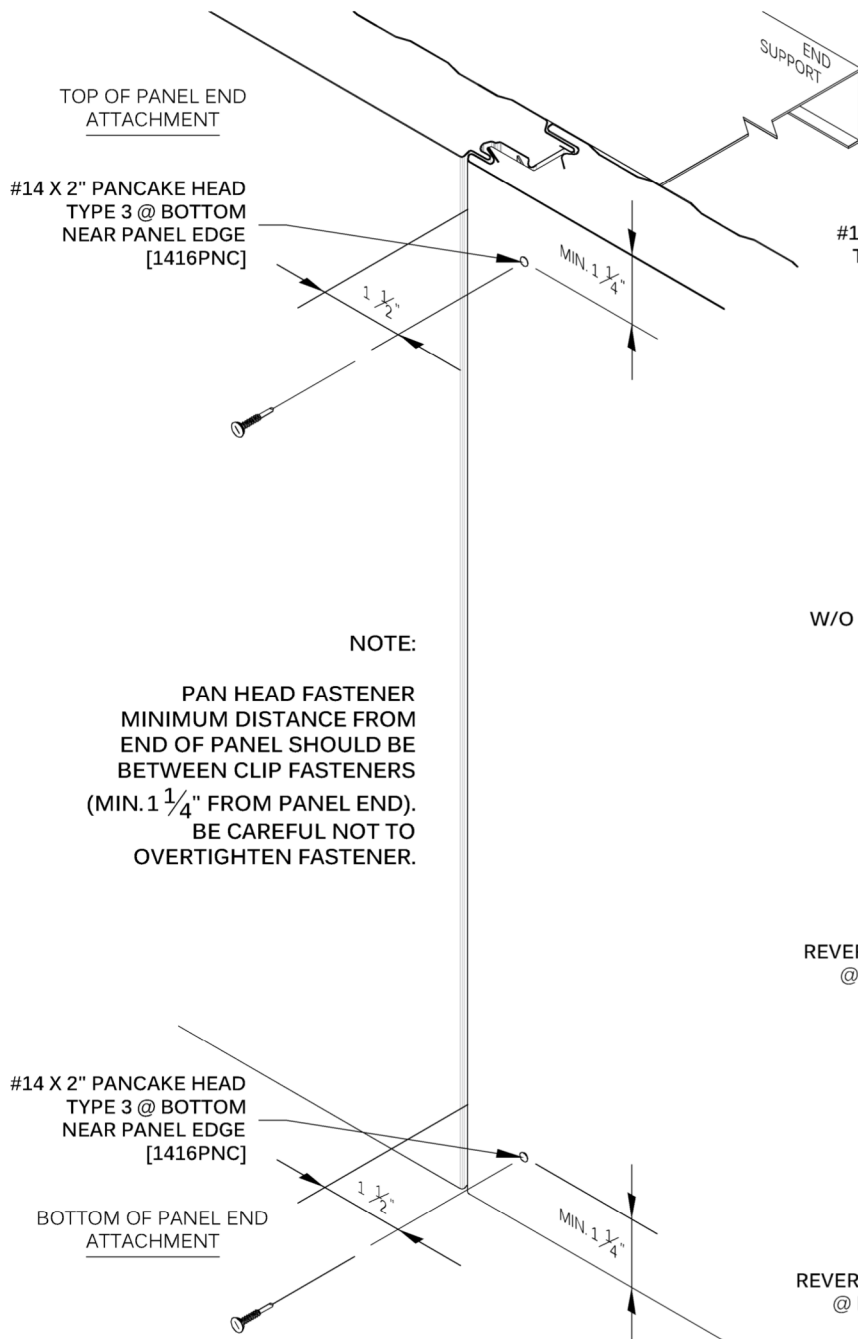

NOTE:

PAN HEAD FASTENER  
MINIMUM DISTANCE FROM  
END OF PANEL SHOULD BE  
BETWEEN CLIP FASTENERS  
(MIN. 1 1/4" FROM PANEL END).  
BE CAREFUL NOT TO  
OVERTIGHTEN FASTENER.

T	FASTENER
3"	1624PNC
4"	1632PNC
5"	1640PNC
6"	1648PNC
8"	1664PNC
ALL	1416PNC

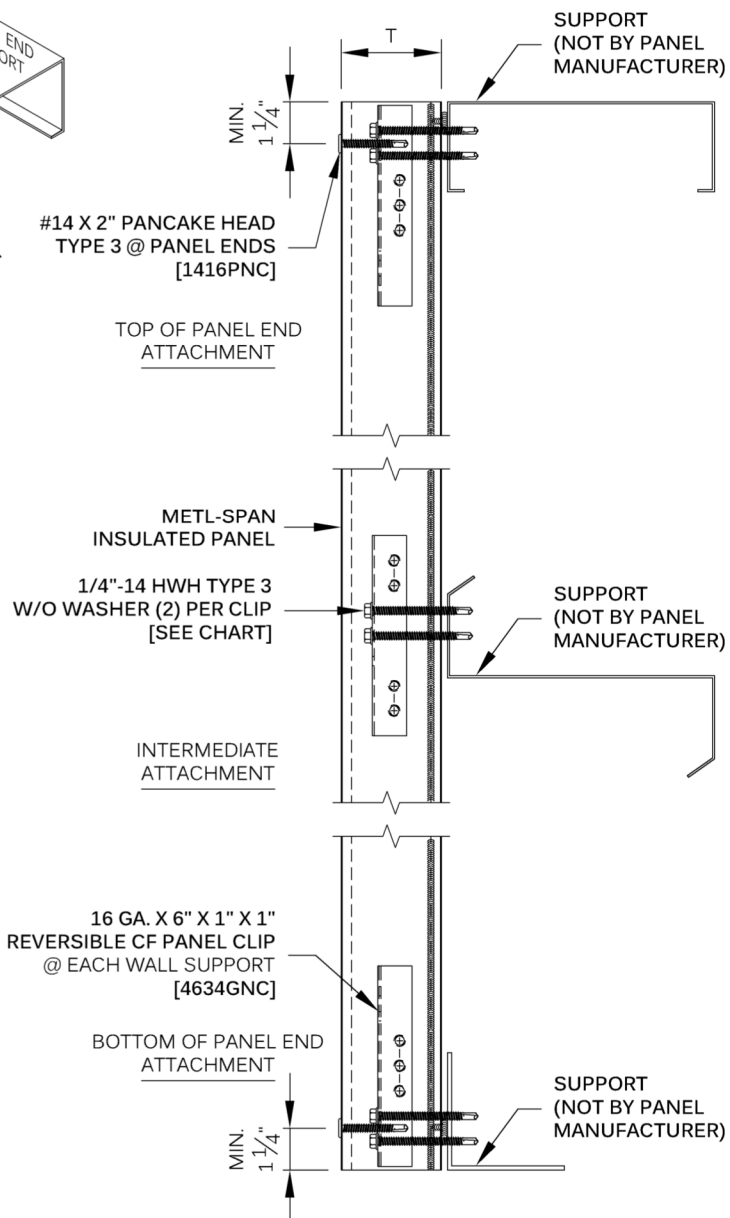

16 GA. X 6" X 1" X 1"  
REVERSIBLE CF PANEL CLIP  
@ EACH WALL SUPPORT  
[4634GNC]

16 GA. X 6" X 1" X 1"  
REVERSIBLE CF PANEL CLIP  
@ EACH WALL SUPPORT  
[4634GNC]

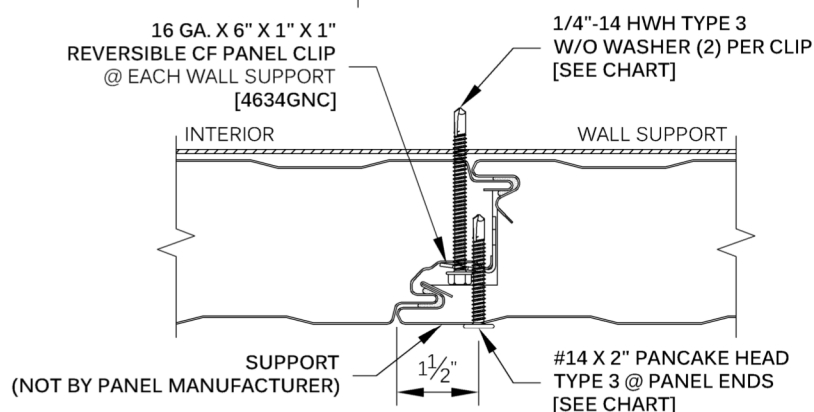

V6+ X-SPAN  
(FACE-TO-CLIP) ASSEMBLY

COMMERCIAL &  
INDUSTRIAL

V6+ X-SPAN  
(FACE-TO-CLIP)  
PANEL FASTENING ASSEMBLY

DRAWING NO:

CI-V6-FSTN-02

DATE:

JUL '22

REV:

00



**METL-SPAN®**

INSULATED METAL PANELS

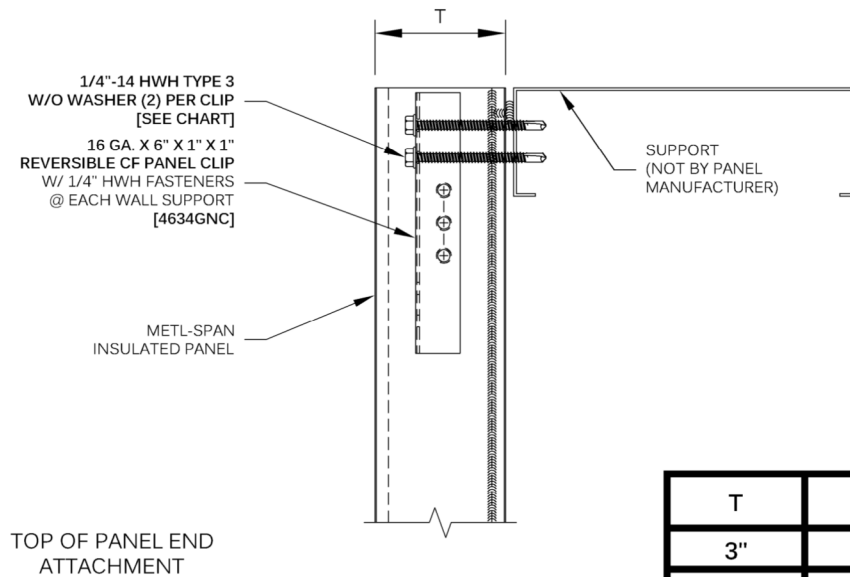

T	FASTENER
3"	1624PNC
4"	1632PNC
5"	1640PNC
6"	1648PNC
8"	1664PNC

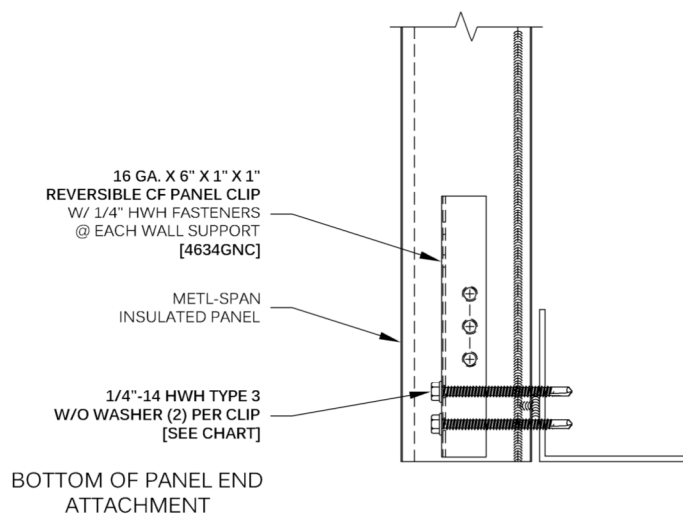
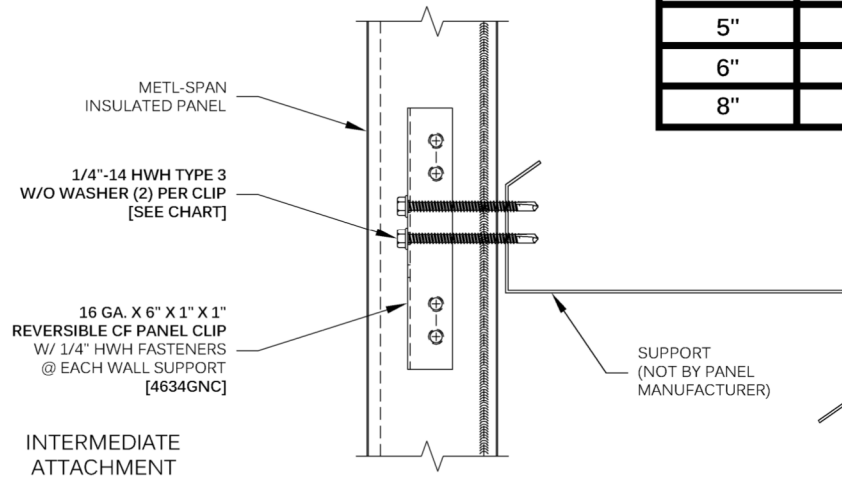

COMMERCIAL &  
INDUSTRIAL

V6 X-SPAN CLIP  
PANEL ATTACHMENT

DRAWING NO:

CI-V6-PA-01

DATE:

JUL '22

REV:

00



**METL-SPAN®**  
INSULATED METAL PANELS

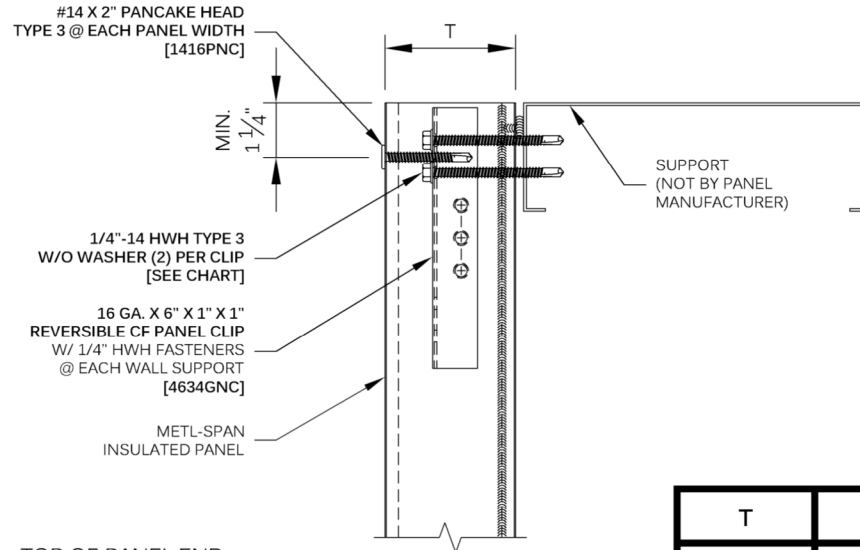

TOP OF PANEL END  
ATTACHMENT

T	FASTENER
3"	1624PNC
4"	1632PNC
5"	1640PNC
6"	1648PNC
8"	1664PNC

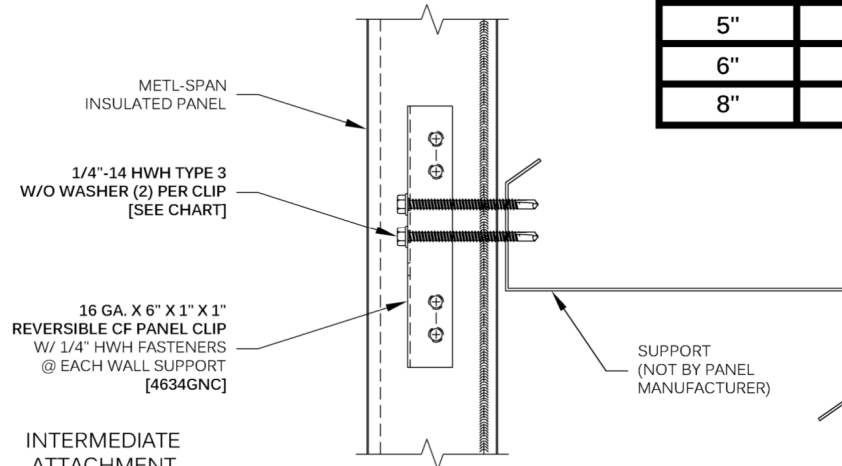

INTERMEDIATE  
ATTACHMENT

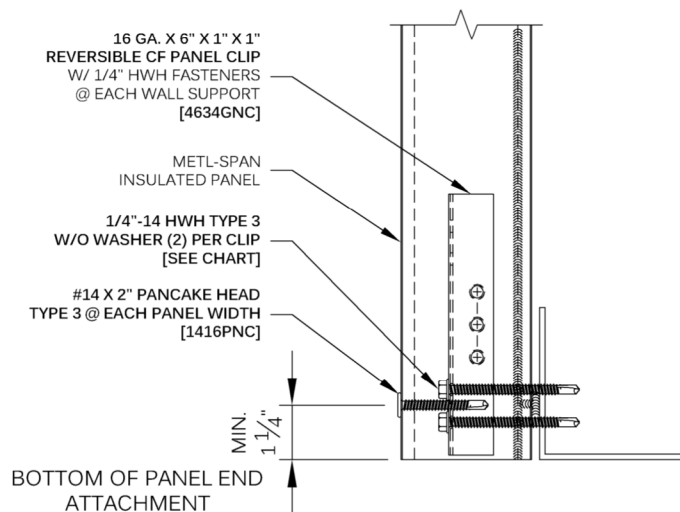

COMMERCIAL &  
INDUSTRIAL

**V6+ X-SPAN  
(FACE-TO-CLIP)  
ATTACHMENT**

DRAWING NO:

**CI-V6-PA-02**

DATE:

**JUL '22**

REV:

**00**





**METL-SPAN®**  
INSULATED METAL PANELS

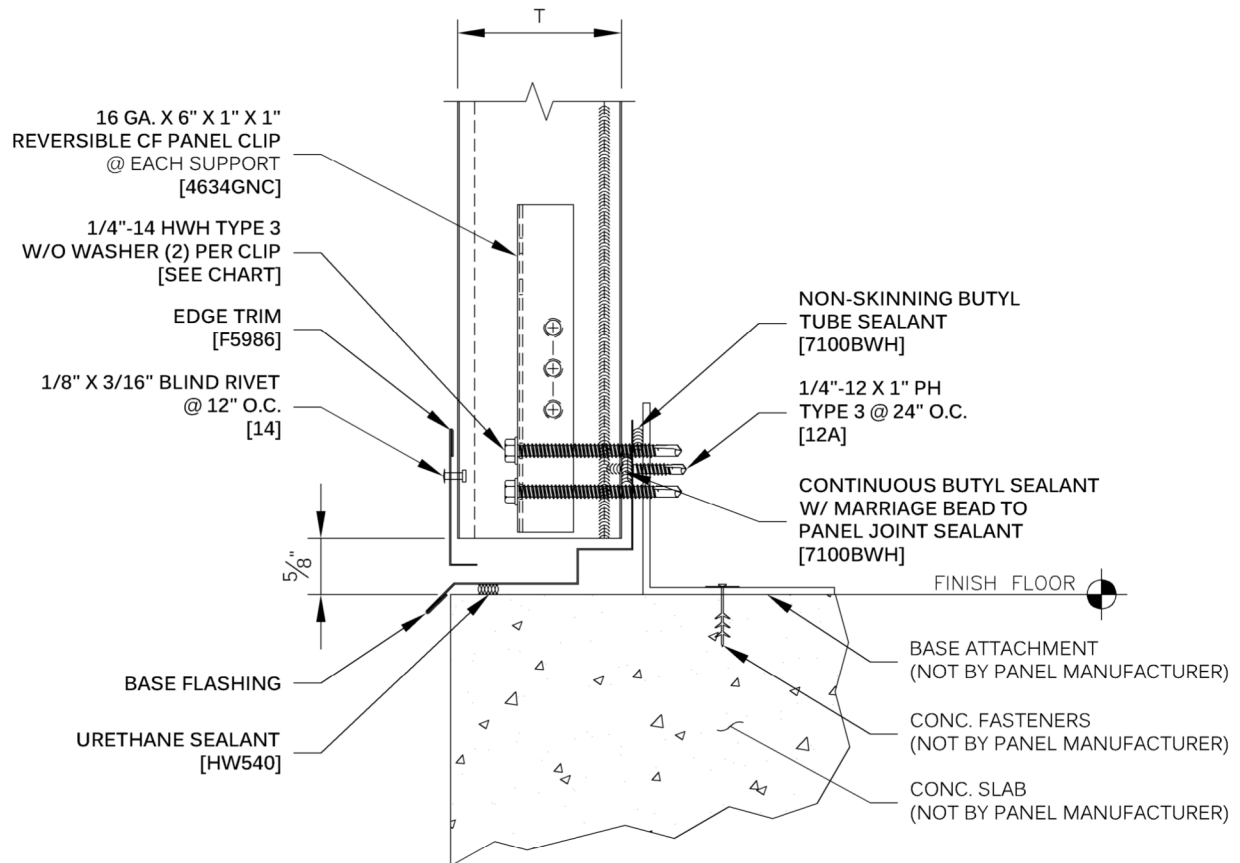

T	FASTENER
3"	1624PNC
4"	1632PNC
5"	1640PNC
6"	1648PNC
8"	1664PNC

REFER TO SHEET "CI-V6-INFO" FOR ADDITIONAL INFORMATION REGARDING THE APPLICATION OF SEALANTS, FASTENERS, AND CLOSURE MATERIALS. CONSULT METL-SPAN TO DETERMINE ALLOWABLE LOAD AND SPACING OF ATTACHMENT FASTENERS.

COMMERCIAL &  
INDUSTRIAL

V6 X-SPAN CLIP  
BASE

DRAWING NO:

CI-V6-BE-01

DATE:

JUL '22

REV:

01



**METL-SPAN®**  
INSULATED METAL PANELS

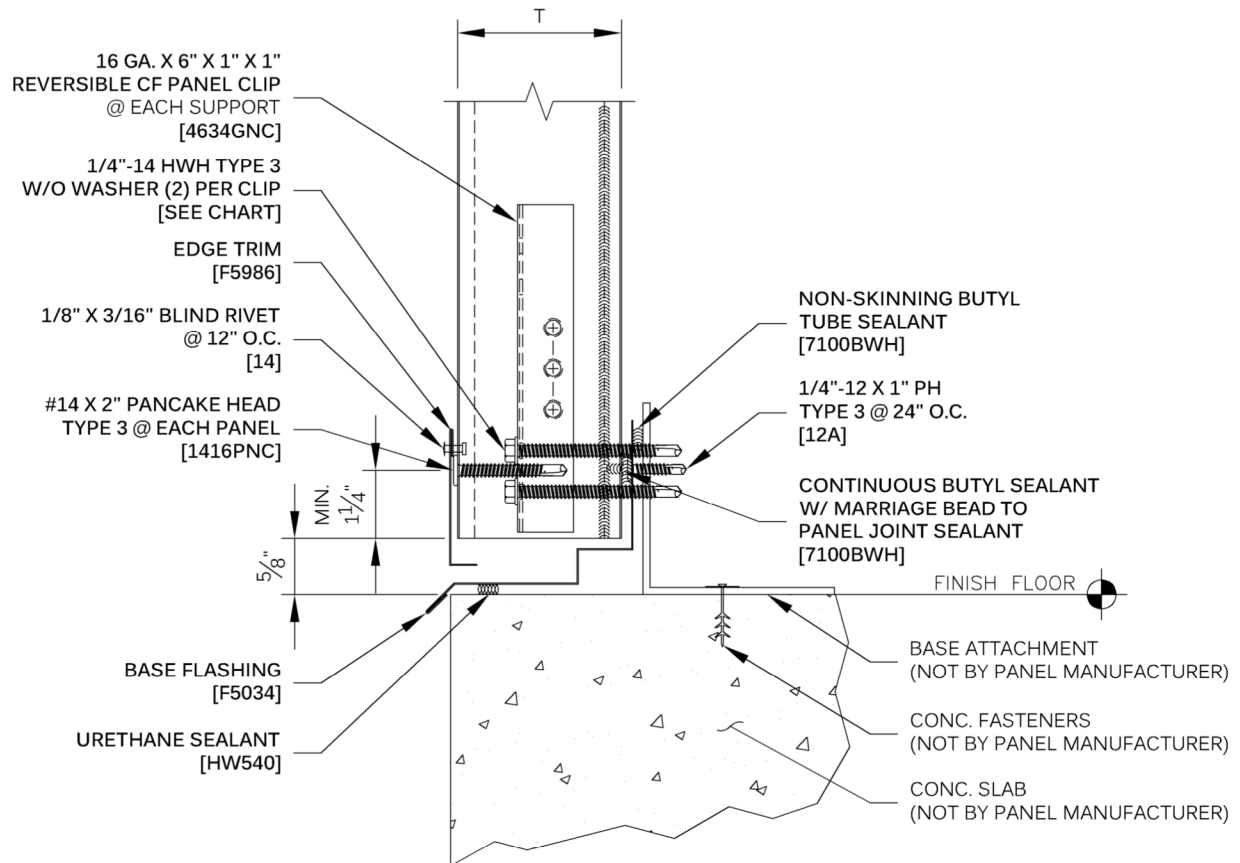

T	FASTENER
3"	1624PNC
4"	1632PNC
5"	1640PNC
6"	1648PNC
8"	1664PNC
ALL	1416PNC

REFER TO SHEET "CI-V6-INFO" FOR ADDITIONAL INFORMATION REGARDING THE APPLICATION OF SEALANTS, FASTENERS, AND CLOSURE MATERIALS. CONSULT METL-SPAN TO DETERMINE ALLOWABLE LOAD AND SPACING OF ATTACHMENT FASTENERS.

COMMERCIAL &  
INDUSTRIAL

V6+ X-SPAN  
(FACE-TO-CLIP)  
BASE

DRAWING NO:

CI-V6-BE-02

DATE:

JUL '22

REV:

01



**METL-SPAN®**  
INSULATED METAL PANELS

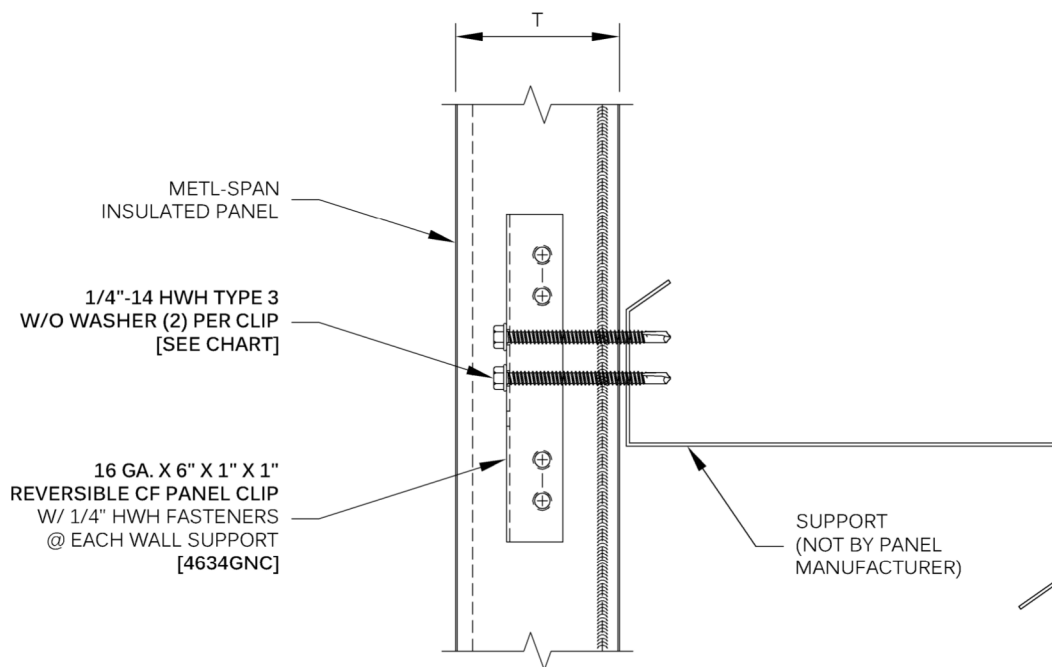

T	FASTENER
3"	1624PNC
4"	1632PNC
5"	1640PNC
6"	1648PNC
8"	1664PNC

REFER TO SHEET "CI-V6-INFO" FOR ADDITIONAL INFORMATION REGARDING THE APPLICATION OF SEALANTS, FASTENERS, AND CLOSURE MATERIALS. CONSULT METL-SPAN TO DETERMINE ALLOWABLE LOAD AND SPACING OF ATTACHMENT FASTENERS.

COMMERCIAL &  
INDUSTRIAL

V6/V6+ X-SPAN CLIP  
INTERMEDIATE  
PANEL ATTACHMENT

DRAWING NO:

CI-V6-PA-03

DATE:

JUL '22

REV:

00



**METL-SPAN®**  
INSULATED METAL PANELS

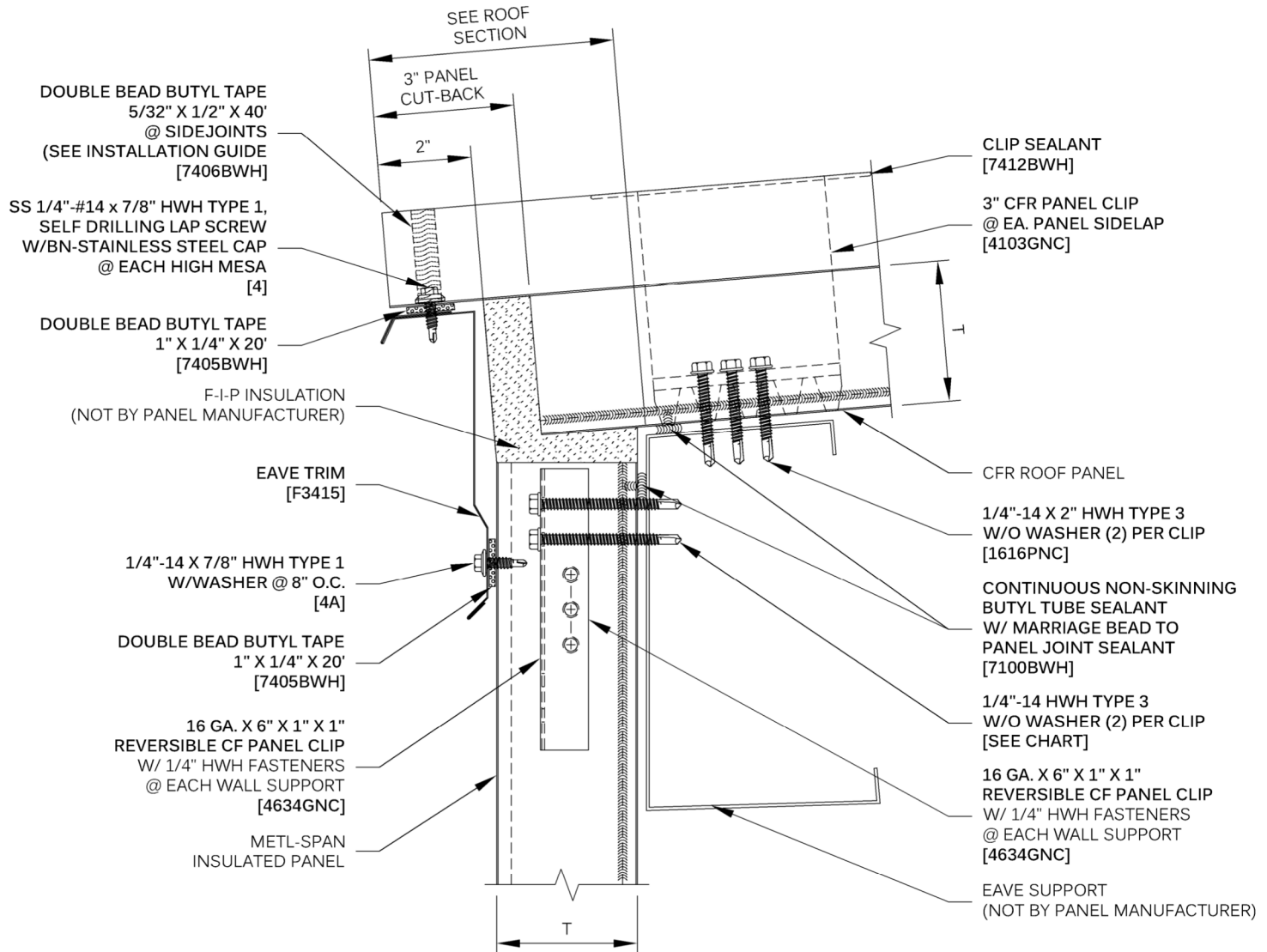

T	FASTENER
3"	1624PNC
4"	1632PNC
5"	1640PNC
6"	1648PNC
8"	1664PNC

REFER TO SHEET "CI-V6-INFO" FOR ADDITIONAL INFORMATION REGARDING THE APPLICATION OF SEALANTS, FASTENERS, AND CLOSURE MATERIALS. CONSULT METL-SPAN TO DETERMINE ALLOWABLE LOAD AND SPACING OF ATTACHMENT FASTENERS.

COMMERCIAL &  
INDUSTRIAL

V6 X-SPAN CLIP  
LOW EAVE

DRAWING NO:

CI-V6-EA-01

DATE:

JUL '22

REV:

00



**METL-SPAN®**  
INSULATED METAL PANELS

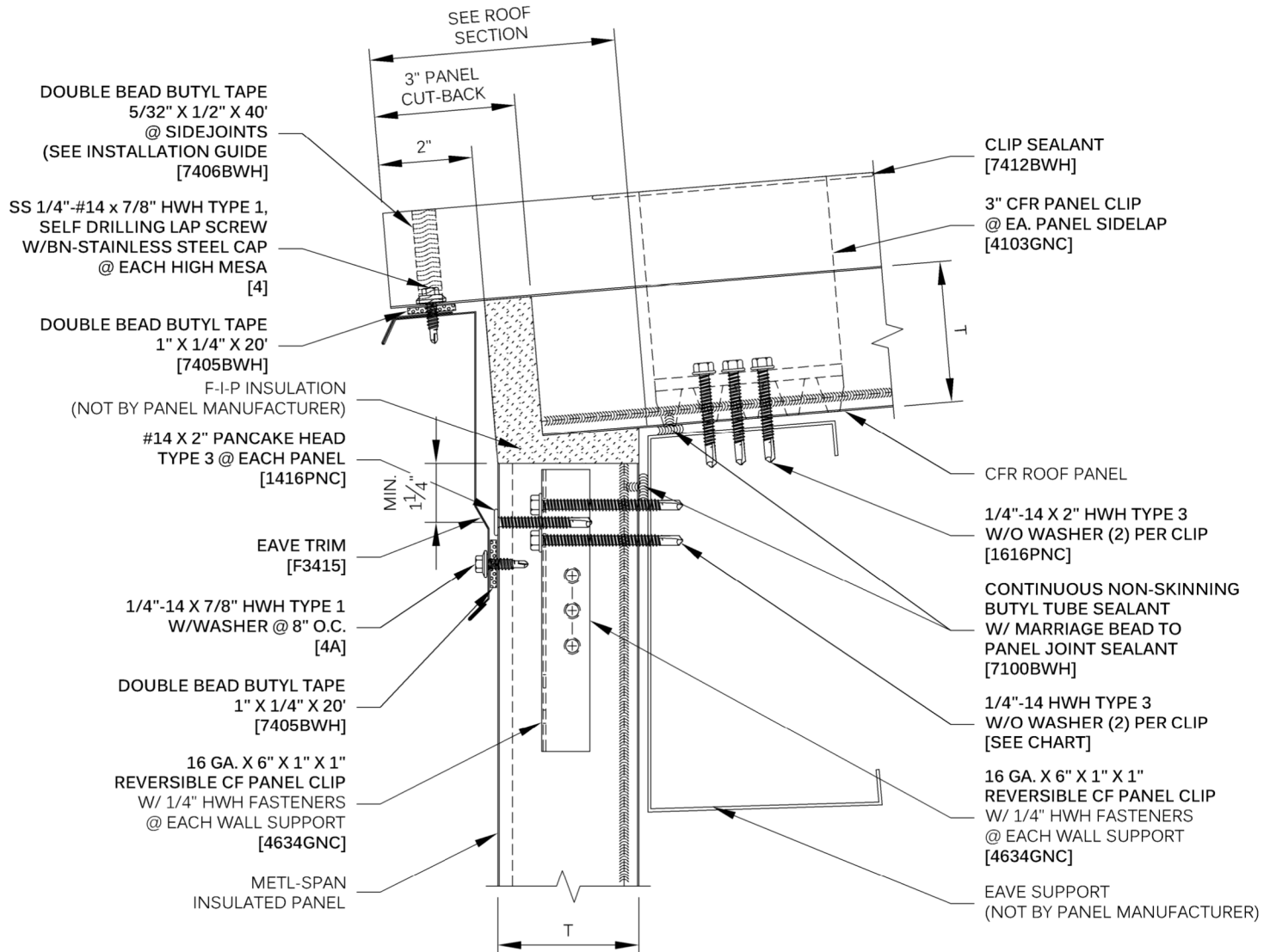

T	FASTENER
3"	1624PNC
4"	1632PNC
5"	1640PNC
6"	1648PNC
8"	1664PNC
ALL	1416PNC

REFER TO SHEET "CI-V6-INFO" FOR ADDITIONAL INFORMATION REGARDING THE APPLICATION OF SEALANTS, FASTENERS, AND CLOSURE MATERIALS. CONSULT METL-SPAN TO DETERMINE ALLOWABLE LOAD AND SPACING OF ATTACHMENT FASTENERS.

COMMERCIAL &  
INDUSTRIAL

V6+ X-SPAN  
(FACE-TO-CLIP)  
LOW EAVE

DRAWING NO:

CI-V6-EA-02

DATE:

JUL '22

REV:

00