



Help Your Growing Facility Flourish with IMPs

Hydroponic growing uses 60–90 percent less water than conventional growing methods, and can produce 50 percent higher yield in half the space. However, it is of the utmost importance to maintain an optimal internal environment to generate the best results.

In an industry where being environmentally conscious while maximizing yield is critical, growing facilities require an envelope solution to accommodate both production and efficiency. Metl-Span® insulated metal panels (IMPs) help to ensure a consistent temperature- and humidity-controlled interior environment, while Metl-Span's ThermalSafe® fire resistant panels offer an ideal solution for fire protection in the facility's corridors and hallways.

Metl-Span ThermalSafe panels are composed of an advanced mineral wool core, providing enhanced insulating values to lower heating and cooling costs while achieving a one-, two- and three-hour fire resistance rating for non-load bearing walls.

For more information on how Metl-Span® can optimize your next growing facility, visit metlspan.com/markets.

To discuss your next project, call **877.585.9969**.

Metl-Span IMP Benefits:

Design Flexibility – Feature impermeable faces and built-in thermal breaks to ensure the highest insulating values and temperature/humidity controls

USDA-Compliant – Come in a wide variety of colors and finishes that are USDA compliant to enhance food growth and reflectivity inside

Ease of Installation – Are lightweight yet strong, to help your facility get up and running quickly with a one-step construction process

Washdowns – Facilitate the washdown process and keep crops fresh by eliminating gaps and seams where mold typically grows



Thermalsafe®

LOCK & GROOVE SYSTEM

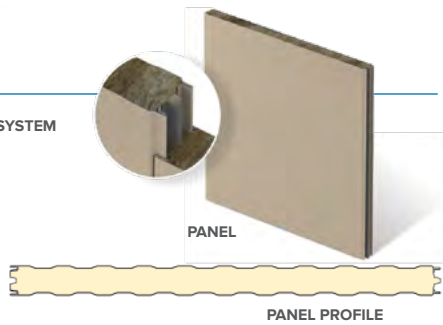

PRODUCT SPECIFICATIONS

WIDTH: 42"

THICKNESS: NOMINAL 3", 4", 5", 6", 7", 8"

LENGTH: NON-DIRECTIONAL EMBOSSED

8'-0" to 40'-0", variable by thickness;
contact Metl-Span for exact maximum length for each thickness

EXTERIOR PROFILE: Ultra-Light Mesa, Santa Fe or Light Striated, nominal 1/32" deep, embossed

FIRE RATINGS: One-, two-, and three-hour for wall. 90 minute for ceiling

U-FACTOR² (BTU/h·ft²·F°)

PANEL WIDTH: 36"

	75°
3"	0.0923
4"	0.0654
5"	0.0529
6"	0.0444
7"	0.0383
8"	0.0336

R-VALUE² (h·ft²·F°/BTU)

PANEL WIDTH: 36"

	75°
3"	10.83
4"	15.29
5"	18.90
6"	22.51
7"	26.12
8"	29.73

CF Mesa

LOCK & GROOVE SYSTEM

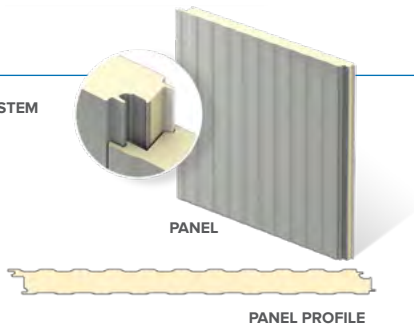

PRODUCT SPECIFICATIONS

WIDTH: 30", 36", 42"

THICKNESS: 2", 2½", 3", 4", 5", 6"

LENGTH: NON-DIRECTIONAL EMBOSSED

8'-0" TO 32'-0" for Horizontal
8'-0" TO 52'-0" for Vertical

UNEMBOSSED

8'-0" TO 16'-0" for Horizontal
8'-0" TO 40'-0" for Vertical

EXTERIOR PROFILE: Longitudinal corrugations spaced at nominal 4" on center, nominal 1/8" deep, embossed or unembossed

U-FACTOR² (BTU/h·ft²·F°)

PANEL WIDTH: 42"

	75°	40°
2"	0.0706	0.0669
2½"	0.0516	0.0491
3"	0.0424	0.0401
4"	0.0324	0.0305
5"	0.0264	0.0248
6"	0.0224	0.0210

R-VALUE² (h·ft²·F°/BTU)

PANEL WIDTH: 42"

	75°	40°
2"	14.16	14.95
2½"	19.38	20.37
3"	23.58	24.94
4"	30.86	32.79
5"	37.88	40.32
6"	44.64	47.62

CFR

LOCK & GROOVE SYSTEM

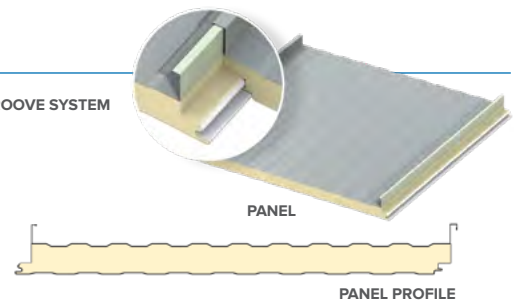

PRODUCT SPECIFICATIONS

WIDTH: 30"³, 36", 42"

THICKNESS: 2", 2½", 3", 4", 5", 6"

LENGTH: NON-DIRECTIONAL EMBOSSED

9'-6" to 53'-0";
contact Metl-Span for custom length availability

EXTERIOR PROFILE: 2" high standing seam with a Mesa profile between the seams, embossed

U-FACTOR² (BTU/h·ft²·F°)

PANEL WIDTH: 42"

	75°
2"	0.0600
2½"	0.0490
3"	0.0414
4"	0.0318
5"	0.0257
6"	0.0217

R-VALUE² (h·ft²·F°/BTU)

PANEL WIDTH: 42"

	75°
2"	16.67
2½"	20.41
3"	24.15
4"	31.45
5"	38.91
6"	46.08

CF Flute

LOCK & GROOVE SYSTEM

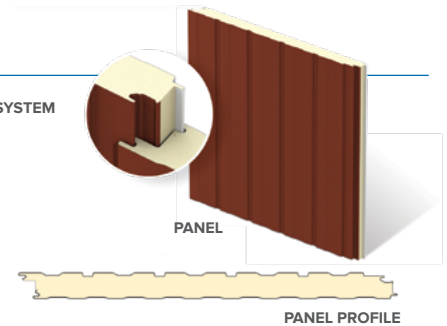

PRODUCT SPECIFICATIONS

WIDTH: 42"

THICKNESS: 2", 2½", 2 ¾"⁴, 3", 4", 5", 6"

LENGTH: NON-DIRECTIONAL EMBOSSED

8'-0" to 32'-0" for Horizontal
8'-0" to 52'-0" for Vertical

EXTERIOR PROFILE: 1" wide, nominal 3/8" deep, longitudinal reveals at 8.4" on center, embossed

U-FACTOR² (BTU/h·ft²·F°)

PANEL WIDTH: 42"

	75°	40°
2"	0.0721	0.0692
2½"	0.0523	0.0498
3"	0.0432	0.0410
4"	0.0328	0.0311
5"	0.0267	0.0252
6"	0.0226	0.0214

R-VALUE² (h·ft²·F°/BTU)

PANEL WIDTH: 42"

	75°	40°
2"	13.87	14.45
2½"	19.12	20.08
3"	23.15	24.39
4"	30.49	32.15
5"	37.45	39.68
6"	44.25	46.73

¹No hourly rating available. ²Based on ASTM C518, ASTM C1363 and thermal modeling, 75° F core mean temp. ³Available only from Texas plant. ⁴Available only from Nevada plant.